

# **TRAFFIC REGULATION ORDER (TRO) CONSULTATION**

## **JEA8013MM – A259 Improvement Works**

**31/3/22 – 28/4/22**

### **Contents**

Notice	Page 2
Statement of Reasons	Page 3
Draft Moving Order	Page 5
Draft Parking Order	Page 10
Plans -existing & proposed	Pages 12-24

**West Sussex County Council**  
**(Various Parishes: A259) (Traffic Regulation) (And Consolidation) and**  
**(Angmering: Dappers Lane) (One Way Traffic) Order 2022**  
**And**  
**West Sussex County Council ((Arun District) (Parking Places & Traffic Regulation)**  
**(Consolidation) Order 2010)**  
**(Angmering: A259 Amendment) Order 2022**  
**And**  
**A259 Proposed Pedestrian Crossing Places**

NOTICE is hereby given that West Sussex County Council proposes to make two permanent Traffic Regulation Orders under the provisions of the Road Traffic Regulation Act 1984.

The effect of the first Order will be to prohibit vehicles from making right turns from Oliver Acre, Cornfield Close and Windroos Drive in Littlehampton onto the A259 and visa-versa. The Order also consolidates the provisions of previous similar orders affecting the A259 and various side roads between Littlehampton and Ferring. The opportunity is also being taken to update the existing one-way traffic restriction on the northern end of Dappers Lane in Angmering, to remove an exemption for buses which is no longer required.

The effect of the second Order will be to introduce a 24-hour clearway restriction on the A259 in Angmering, from its junction with the A280, westwards to its junction with Station Road.

It is also proposed to install two new Toucan crossings for pedestrians and cycles on the A259 in Angmering. The first would be located approximately 50 metres east of the roundabout at its junction with Station Road. The second crossing would be located approximately 90 metres west of its junction with the A280.

Full details of the proposals in this notice can be viewed on the Traffic Regulation Order page of the West Sussex County Council website. The [website](#) includes a response form for any comments or objections.

Due to current social distancing requirements, paper copies of documents will not be available to view in council offices or libraries. People without access to a computer who wish to view details of the scheme should telephone the West Sussex County Council Contact Centre on 01243 642105 to receive the documents by post.

Any comments or objections about the proposal must be received before 28 April 2022. These may be submitted via the response form on the website mentioned above, by e-mail to [tro.team@westsussex.gov.uk](mailto:tro.team@westsussex.gov.uk) or in writing to TRO Team, West Sussex County Council, The Grange, Tower Street Chichester, PO19 1RH. For legal reasons, only correspondence including a full name and address will be considered. Please quote reference JEA8013-MM in all correspondence.

Dated this 31st day of March 2022.  
Director of Law & Assurance, County Hall, Chichester.

**West Sussex County Council**  
**(Various Parishes: A259) (Traffic Regulation) (And Consolidation) and**  
**(Angmering: Dappers Lane) (One-Way Traffic) Order 2022**

**And**

**West Sussex County Council ((Arun District) (Parking Places & Traffic**  
**Regulation) (Consolidation) Order 2010)**  
**(Angmering: A259 Amendment) Order 2022**

**And**

**A259 Proposed Pedestrian Crossing Places**

**STATEMENT OF REASONS FOR PROPOSING TO MAKE THE ORDER**

West Sussex County Council proposes to make two permanent Traffic Regulation Orders.

The effect of the first Order will be to prohibit vehicles from making right turns from Oliver Acre, Cornfield Close and Windroos Drive in Littlehampton onto the A259 and visa-versa. The Order also consolidates the provisions of previous similar orders affecting the A259 and various side roads between Littlehampton and Ferring.

The opportunity is also being taken to update the existing one-way traffic restriction on the northern end of Dappers Lane in Angmering, to remove an exemption for buses which is no longer required as there is no longer a bus route operating in the road. Modifying the Order in this way will permit clearer signage to be installed, with the intention of reducing the number of vehicles proceeding in contravention of the restriction.

The effect of the second Order will be to introduce a 24-hour clearway restriction on the A259 in Angmering, from its junction with the A280, westwards to its junction with Station Road.

Construction has begun on a project to upgrade the single carriageway sections of the A259 between its junctions with the A280 and Station Road in Angmering, and from its junctions with Horsham Road (Bodyshop Roundabout) and the new Lyminster bypass in Littlehampton.

These sections of roads will be widened to become dual carriageways with a central reservation, and this will require amendments to the access arrangements at junctions on the affected lengths of roads. The safest arrangement at these new junctions is to arrange them as 'left in – left out' and this is formalised by the restrictions proposed in the first Order.

This Order also consolidates the existing restrictions on other junctions along the A259 between Ferring and Littlehampton. This part of the order does not change the existing restrictions but is being made to bring them into one Order for ease of reference.

The second Order enacts a 24-hour clearway restriction, which has the effect of prohibiting parking on the carriageway of the newly widened section of road, where stationary vehicles would cause obstruction and a potential hazard due to the speed limit of the road.

The new Orders are therefore proposed to facilitate the passage of traffic and avoiding danger to traffic using the affected length of road.

It is also proposed to install two new Toucan crossings for pedestrians and cycles on the A259 in Angmering. The first would be located approximately 50 metres east of the

roundabout at its junction with Station Road. The second crossing would be located approximately 90 metres west of its junction with the A280.

As part of the scheme to improve the A259, new shared use pedestrian/cycle paths will be constructed on both sides of the A259. The new crossings are both proposed at locations where pedestrians and cyclists are likely to cross the road to access other routes or local amenities.

The attached drawings, numbered TQ0603SES, TQ0603SWS, TQ0703SEN, TQ0703SES and TQ0703SWS show the lengths of roads affected by the proposed clearway Order. Drawings are also attached showing the junctions affected by the prohibitions of right turns, and the locations of the proposed new crossings.

Director of Law & Assurance  
22 November 2021

JEA8013-MM

**WEST SUSSEX COUNTY COUNCIL**  
**(VARIOUS PARISHES: A259) (TRAFFIC REGULATION) (AND CONSOLIDATION) AND**  
**(ANGMERING: DAPPERS LANE) (ONE-WAY TRAFFIC) ORDER 2022**

West Sussex County Council in exercise of their powers under Sections 1 (1) 2 (1) and (2), 4 (2), and Part IV of Schedule 9 of the Road Traffic Regulation Act 1984 ("the Act") as amended and of all other enabling powers and after consultation with the Chief Officer of Police in accordance with Part III of Schedule 9 to the Act hereby make the following Order:-

**PART 1**  
**General**

1. This Order shall come into operation on the \*\* day of \*\*\*\*\* 2022 and may be cited as "West Sussex County Council (Various Parishes: A259) (Traffic Regulation) (And Consolidation) and (Angmering: Dappers Lane) (One Way Traffic) Order 2022" hereinafter called "this Order".
2. The prohibitions imposed by this Order shall be in addition to and not in derogation from any restriction imposed by any regulations made or having effect as if made under the Act or by or under an enactment.
3. In this Order –  
  
"Public Service Vehicle" shall have the same meaning as in section 1 of the Public Passenger Vehicles Act 1981 as amended.  
  
"Pedal Cycle" shall have the same meaning as defined in the Traffic Signs Regulations and General Directions 2016.
4. The Orders specified in the First Schedule to this Order are hereby revoked.

**PART 2**  
**Prohibition of Right Turn Provisions**

5. Save as provided in Article 11, no person shall cause or permit any vehicle to make a right turn as specified in the Second Schedule of this Order.

**PART 3**  
**Prohibition of Driving Except for Local Buses**

6. Save as provided in Articles 7 and 11, no person shall cause or permit any vehicle to proceed on the length of road specified in the Third Schedule to this Order.
7. Nothing in Article 6 shall apply to a Public Service Vehicle in operating a local service.

**PART 4**  
**Prohibition of U-Turns**

8. Save as provided in Article 11, no person shall cause or permit any vehicle to make a U-Turn as described in the Fourth Schedule to this Order.

**PART 5**  
**One Way Traffic**

9. Save as provided in Articles 10 and 11, no person shall cause or permit any vehicle to proceed in the length of road specified in column 1 of the Fifth Schedule to this Order, in a direction other than specified in column 2 of the Fifth Schedule to this Order.
10. Nothing in Article 10 shall apply to a pedal cycle proceeding in a designated cycle lane.

**PART 6**  
**General Exemptions**

11. Nothing in Articles 5, 6 and 8 shall apply to:
- (a) A vehicle proceeding under the direction or with the permission of a police constable in uniform; or
- (b) A vehicle being used for ambulance, fire brigade or police purposes in the event of an emergency.

**FIRST SCHEDULE**  
**Orders to be Revoked**

<b><u>Order</u></b>	<b><u>Part to be revoked</u></b>
The Administrative County of West Sussex (Traffic Regulation) Order 1938	The whole Order
The County Council of West Sussex (Ferring: Littlehampton Road (A259) And Roundstone By-Pass Road (A259)) (Traffic Regulation) Order 1990	The whole Order
The County Council of West Sussex (Angmering: Old Worthing Road (B2140) And Roundstone Bypass Road/Littlehampton Road (A259) – Cycletrack and Footway) (Prohibition of Driving) Order 1992	The whole Order
West Sussex County Council (Angmering: Dappers Lane) (One-Way Traffic) Order 2004	The whole Order
West Sussex County Council (Littlehampton: Various Roads) (Traffic Regulation) Order 2007	The whole Fourth Schedule
West Sussex County Council (Ferring: A259 Littlehampton Road) (Prohibition of U-Turns) Order 2013	The Whole Order

**SECOND SCHEDULE**  
**Prohibition of Right Turns**

**Road In Angmering**

**Prohibited Manoeuvre**

A259 Roundstone Bypass

- a) Westbound vehicles – no vehicle shall make a right turn into the exit from Haskins Garden Centre Car Park
- b) Westbound vehicles – no vehicle shall make a right turn into the entrance to Haskins Garden Centre Car Park
- c) Westbound vehicles – no vehicle shall make a right turn into the retail premises located 75 metres east of Roundstone Lane
- d) Westbound vehicles – no vehicle shall make a right turn into the access to Lowertrees Nursery

Haskins Garden Centre Exit Road

Southbound vehicles – No vehicle shall turn right so as to proceed westbound on A259 Roundstone Bypass

Haskins Garden Centre Entrance Road

Southbound vehicles – No vehicle shall turn right so as to proceed westbound on A259 Roundstone Bypass

Retail Premises located 75 metres east of Roundstone Lane

Southbound vehicles – No vehicle shall turn right so as to proceed westbound on A259 Roundstone Bypass

Access to Lowertrees Nursery

Southbound vehicles – No vehicle shall turn right so as to proceed westbound on A259 Roundstone Bypass

**Road In Littlehampton**

**Prohibited Manoeuvre**

A259 Worthing Road

- a) Westbound Vehicles – No vehicle shall make a right turn into Olliver Acre.
- b) Eastbound vehicles – No vehicle shall make a right turn into Cornfield Close.
- c) Westbound vehicles – No vehicle shall make a right turn into Windroos Drive







**WEST SUSSEX COUNTY COUNCIL**  
**((ARUN DISTRICT) (PARKING PLACES & TRAFFIC REGULATION)**  
**(CONSOLIDATION) ORDER 2010)**

**(ANGMERING: A259 AMENDMENT)**  
**ORDER 2022**

West Sussex County Council in exercise of their powers under Sections 1 (1) 2 (1) and (2), 4 (2), 45, 46, 49 and 53 and Part IV of Schedule 9 of the Road Traffic Regulation Act 1984 ("the Act") as amended and of all other enabling powers and after consultation with the Chief Officer of Police in accordance with Part III of Schedule 9 to the Act hereby make the following Order:-

1. This Order shall come into operation on the \*\*\*\*\* day of \*\*\*\*\* 2022 and may be cited as "West Sussex County Council ((Arun District) (Parking Places & Traffic Regulation) (Consolidation) Order 2010) (Angmering: A259 Amendment) Order 2022".
2. The "West Sussex County Council (Arun District) (Parking Places & Traffic Regulation) (Consolidation) Order 2010" is hereby amended by the replacement of the plans specified in the First Schedule to this Order, with the plans specified in the Second Schedule, attached hereto.
3. The "West Sussex County Council (Arun District) (Parking Places & Traffic Regulation) (Consolidation) Order 2010" is hereby amended by the addition of the plans specified in the Third Schedule to this Order, attached hereto.

**FIRST SCHEDULE**  
**Plans to be Replaced**

TQ0603SES (Issue Number 3)  
TQ0603SWS (Issue Number 4)  
TQ0703SEN (Issue Number 1)

**SECOND SCHEDULE**  
**Replacement Plan**

TQ0603SES (Issue Number 4)  
TQ0603SWS (Issue Number 5)  
TQ0703SEN (Issue Number 2)

**THIRD SCHEDULE**  
**Plans to be Added**

TQ0703SES (Issue Number 1)  
TQ0703SWS (Issue Number 1)



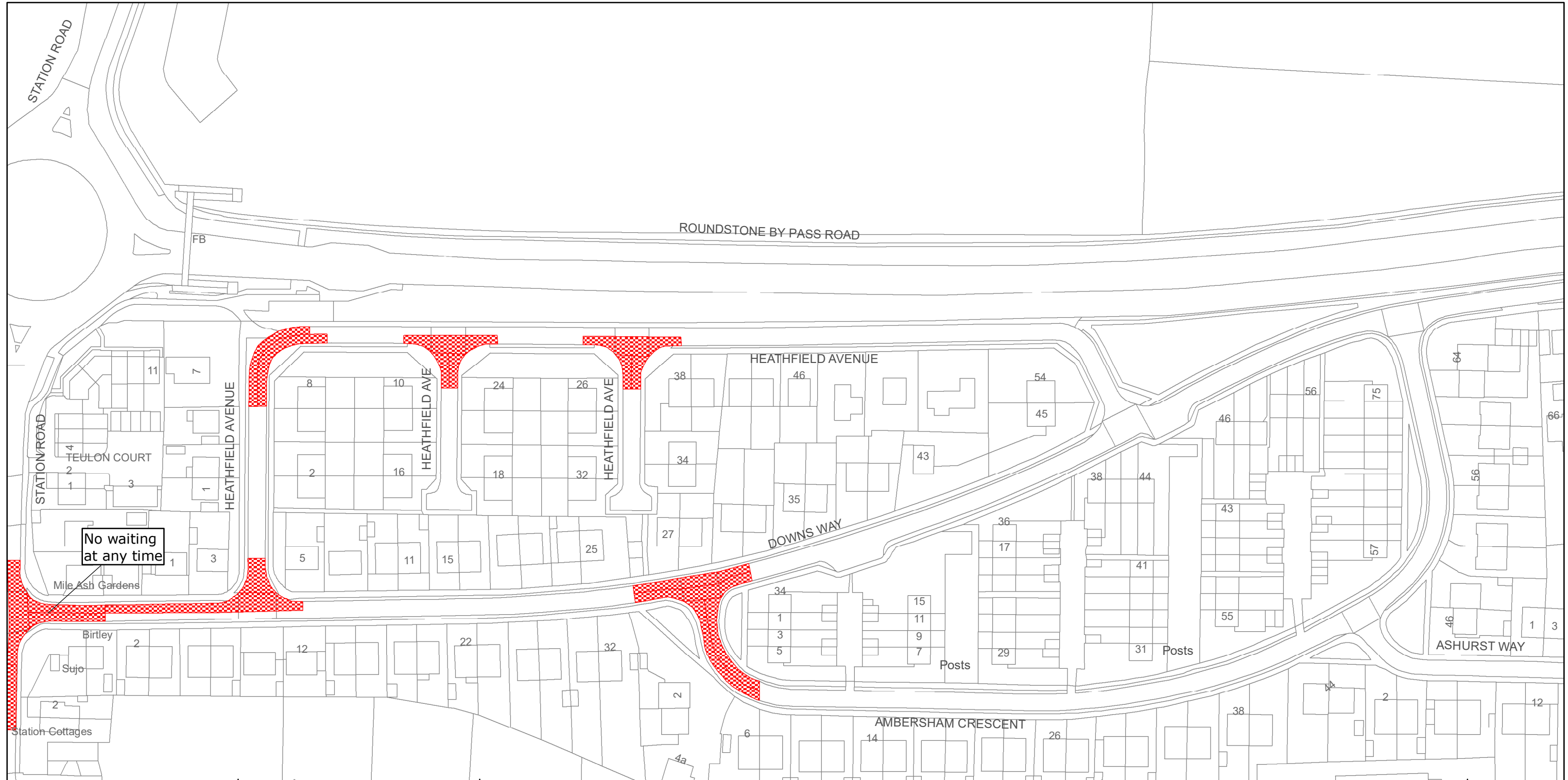

West Sussex County Council  
 Highways & Transport  
 The Grange  
 Tower Street  
 Chichester  
 West Sussex  
 PO19 1RH

ARUN DISTRICT: ANGMERING  
 WAITING RESTRICTIONS

TILE REF NO:  
 TQ0603SES

SHEET ISSUE NO 3  
 SHEET ACTIVE FROM - 16/02/2015



SCALE:  
 1:1250  
 at A3 size

Reproduced from or based upon 2013 Ordnance Survey material with permission of the Controller of HMSO (c) Crown Copyright reserved.  
 Unauthorised reproduction infringes Crown copyright and may lead to prosecution or civil proceedings West Sussex County Council Licence No. 100023447

# PAGE 2 OF 2: PROPOSED CHANGES TO RESTRICTIONS (CIRCLED)

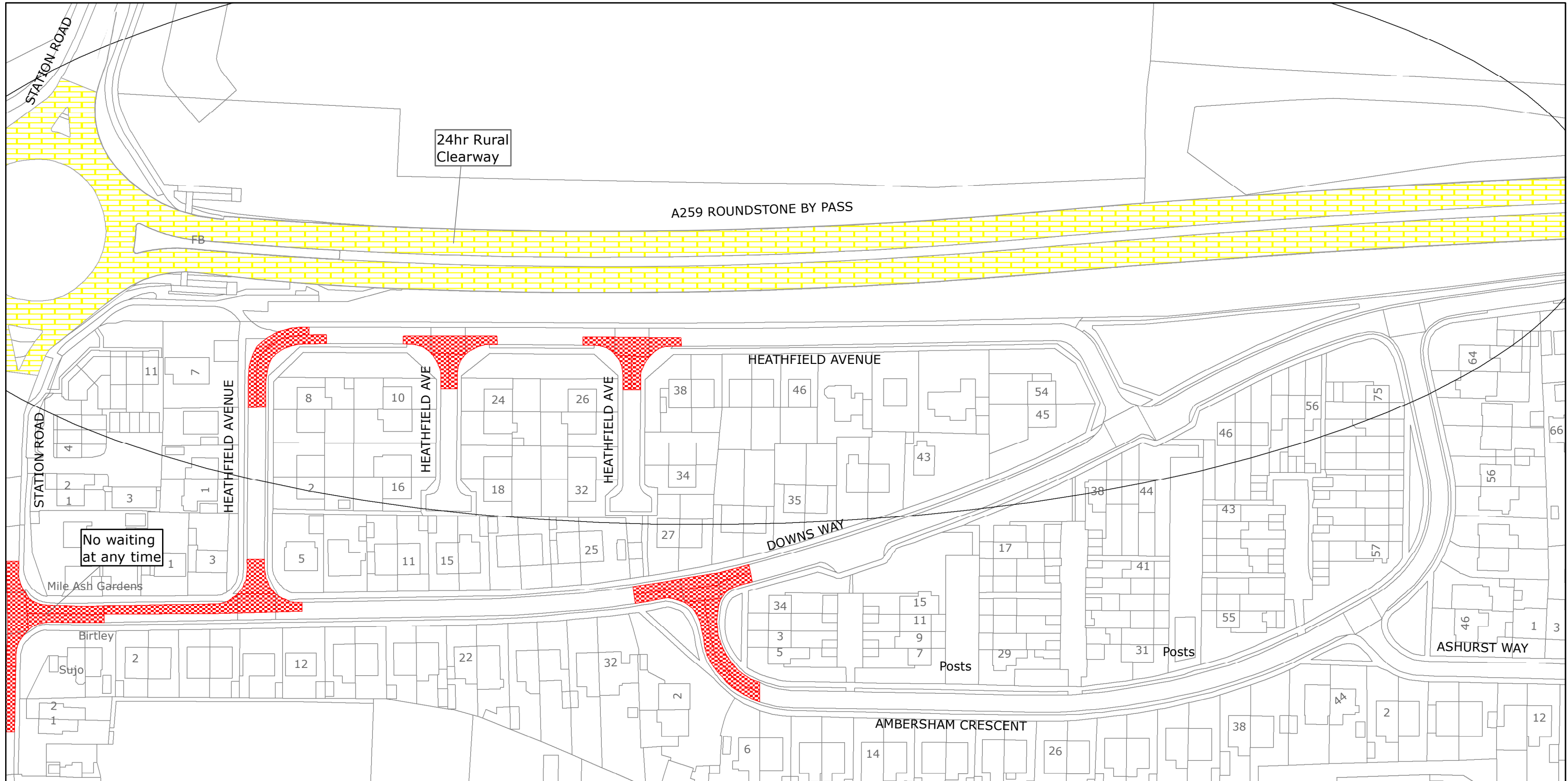

West Sussex County Council  
Highways & Transport  
The Grange  
Tower Street  
Chichester  
West Sussex  
PO19 1RH

ARUN DISTRICT: ANGMERING

PROPOSED WAITING RESTRICTIONS (11.10.2021)

TILE REF NO:  
TQ0603SES

SHEET ISSUE NO 4\_JEA8013  
SHEET ACTIVE FROM - DD.MM.YYYY



SCALE:  
1:1250  
at A3 size

Reproduced from or based upon 2021 Ordnance Survey mapping with permission of the Controller of HMSO (c) Crown Copyright reserved.  
Unauthorised reproduction infringes Crown copyright and may lead to prosecution or civil proceedings West Sussex County Council Licence No. 100018485

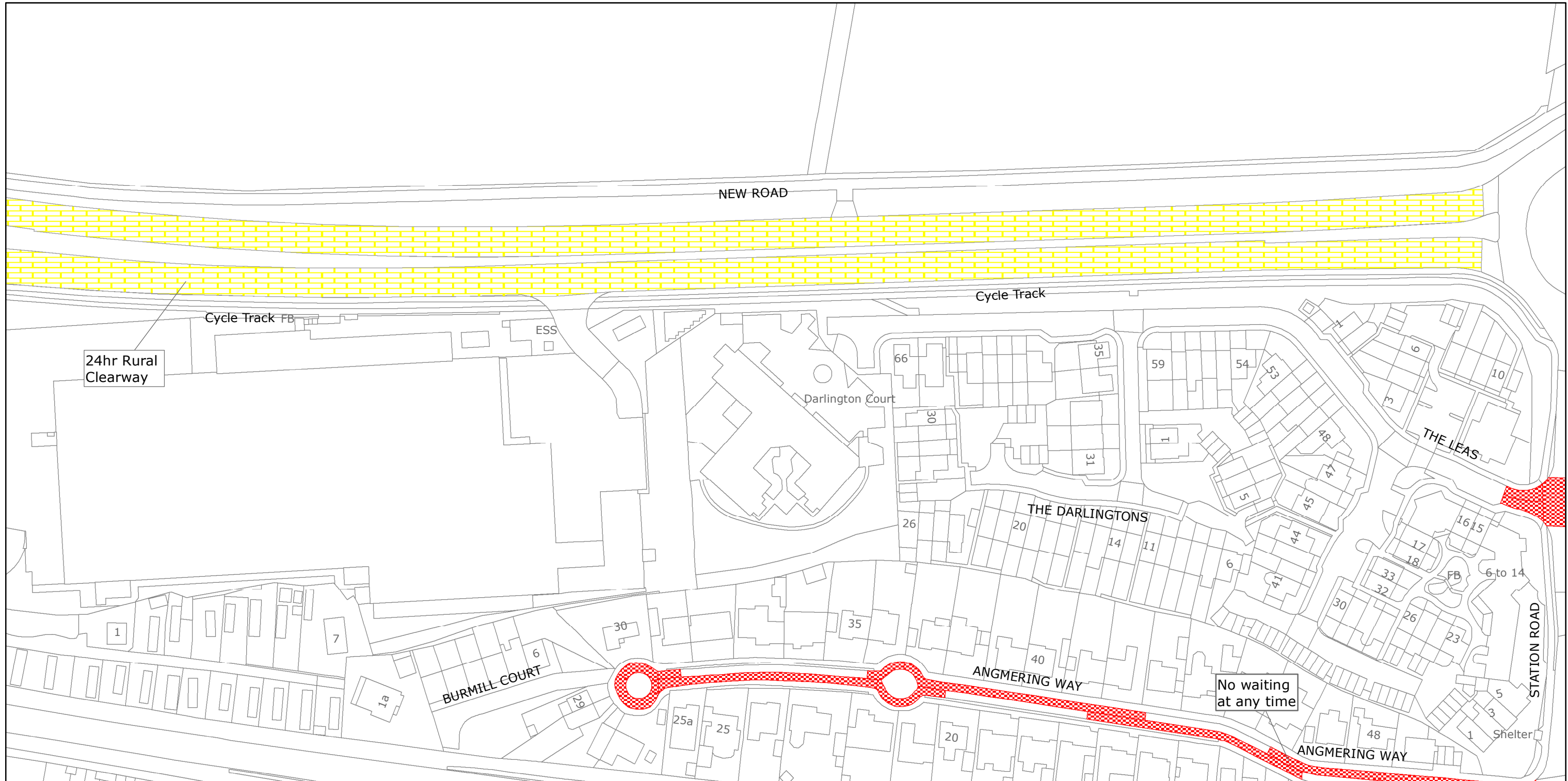

West Sussex County Council  
Highways & Transport  
The Grange  
Tower Street  
Chichester  
West Sussex  
PO19 1RH

ARUN DISTRICT: ANGMERING AND RUSTINGTON  
WAITING RESTRICTIONS

TILE REF NO:  
TQ0603SWS

SHEET ISSUE NO 4  
SHEET ACTIVE FROM - 05/04/2021



SCALE:  
1:1250  
at A3 size

# PAGE 2 OF 2: PROPOSED CHANGES TO RESTRICTIONS (CIRCLED)

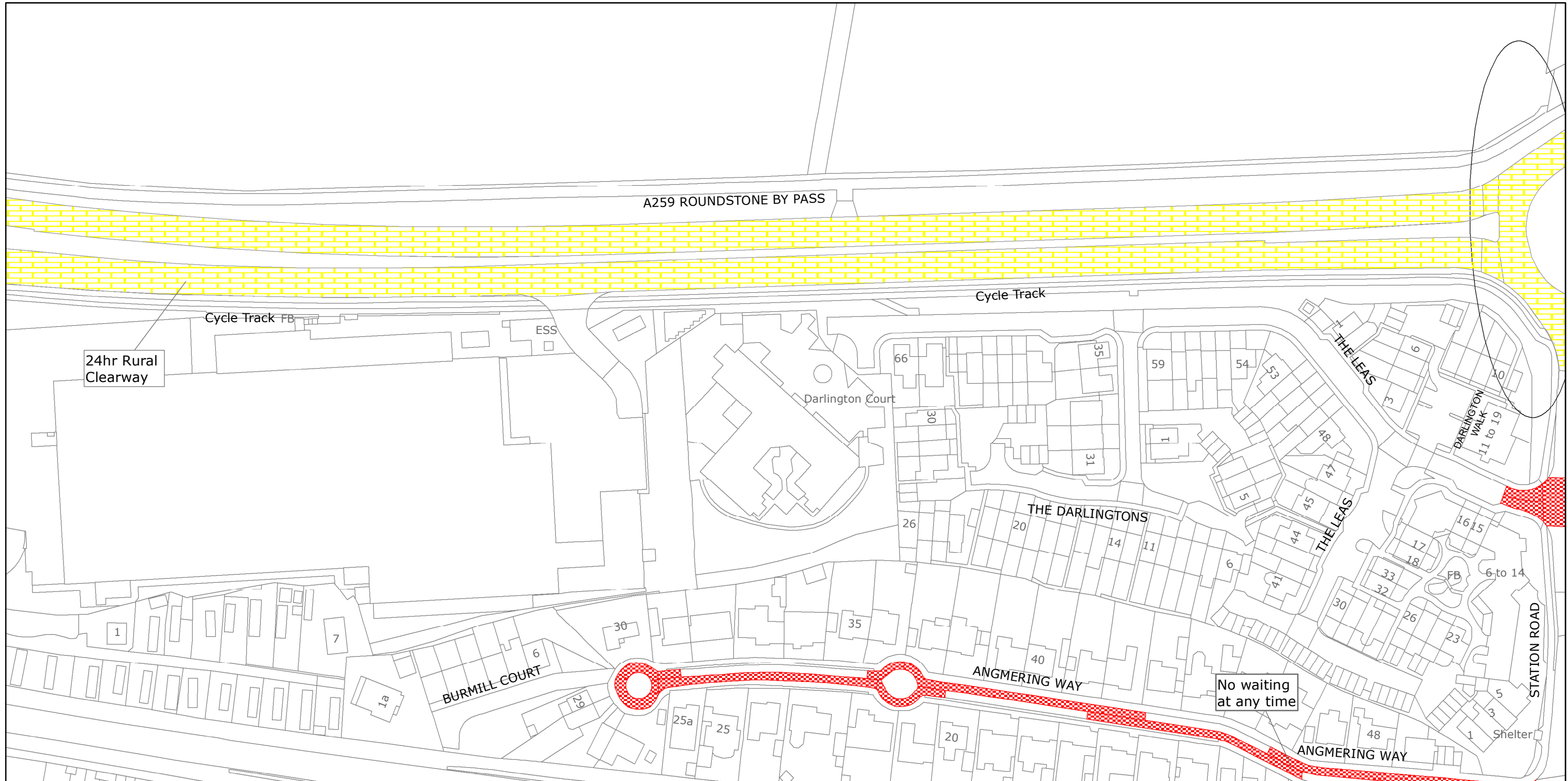

West Sussex County Council  
Highways & Transport  
The Grange  
Tower Street  
Chichester  
West Sussex  
PO19 1RH

ARUN DISTRICT: ANGMERING AND RUSTINGTON  
PROPOSED WAITING RESTRICTIONS (11.10.2021)

TILE REF NO:  
TQ0603SWS

SHEET ISSUE NO 5\_JEA8013  
SHEET ACTIVE FROM - DD.MM.YYYY



SCALE:  
1:1250  
at A3 size

Reproduced from or based upon 2021 Ordnance Survey mapping with permission of the Controller of HMSO (c) Crown Copyright reserved.  
Unauthorised reproduction infringes Crown copyright and may lead to prosecution or civil proceedings West Sussex County Council Licence No. 100018485



West Sussex County Council  
Infrastructure  
The Grange  
Tower Street  
Chichester  
West Sussex  
PO19 1RH

ARUN DISTRICT: ANGMERING  
WAITING RESTRICTIONS

TILE REF NO:  
TQ0703SEN

SHEET ISSUE NO 1  
SHEET ACTIVE FROM - 05/07/2010



SCALE:  
1:1250  
at A3 size

Reproduced from or based upon 2009 Ordnance Survey mapping with permission of the Controller of HMSO (c) Crown Copyright reserved.  
Unauthorised reproduction infringes Crown copyright and may lead to prosecution or civil proceedings West Sussex County Council Licence No. 100023447



PAGE 2 OF 2: PROPOSED CHANGES TO RESTRICTIONS (CIRCLED)



West Sussex County Council  
 Highways & Transport  
 The Grange  
 Tower Street  
 Chichester  
 West Sussex  
 PO19 1RH

ARUN DISTRICT: ANGMERING

PROPOSED WAITING RESTRICTIONS (11.10.2021)

Reproduced from or based upon 2021 Ordnance Survey mapping with permission of the Controller of HMSO (c) Crown Copyright reserved.  
 Unauthorised reproduction infringes Crown copyright and may lead to prosecution or civil proceedings West Sussex County Council Licence No. 100018485

TILE REF NO:  
 TQ0703SEN

SHEET ISSUE NO 2\_JEA8013  
 SHEET ACTIVE FROM - DD.MM.YYYY



SCALE:  
 1:1250  
 at A3 size

PAGE 1 OF 2: EXISTING RESTRICTIONS ONLY

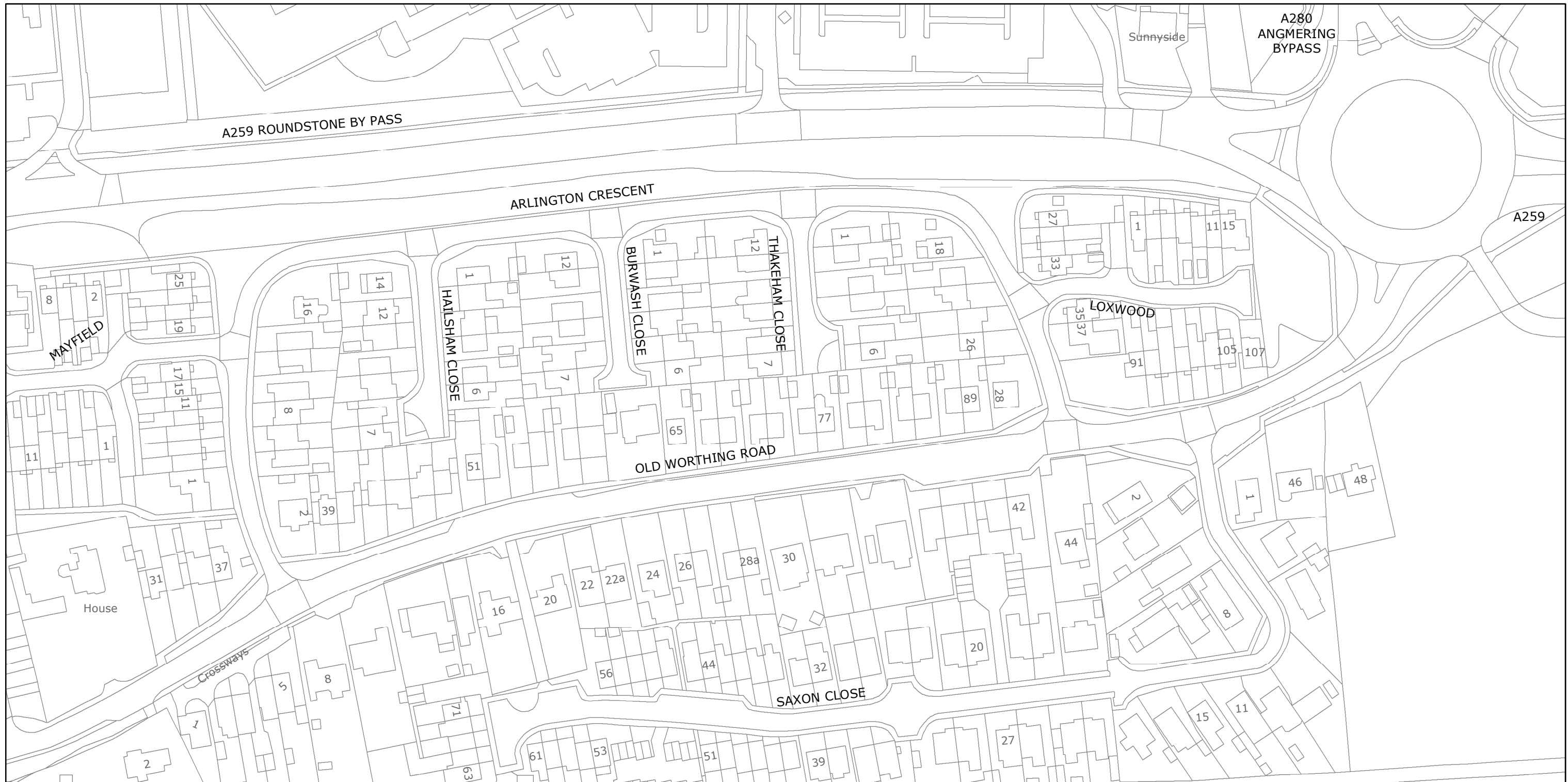

West Sussex County Council  
Highways & Transport  
The Grange  
Tower Street  
Chichester  
West Sussex  
PO19 1RH

ARUN DISTRICT: ANGMERING AND EAST PRESTON  
NO EXISTING WAITING RESTRICTIONS

Reproduced from or based upon 2021 Ordnance Survey mapping with permission of the Controller of HMSO (c) Crown Copyright reserved.  
Unauthorised reproduction infringes Crown copyright and may lead to prosecution or civil proceedings West Sussex County Council Licence No. 100018485

TILE REF NO:  
TQ0703SES

SHEET ISSUE NO  
SHEET ACTIVE FROM -



SCALE:  
1:1250  
at A3 size

PAGE 2 OF 2: PROPOSED CHANGES TO RESTRICTIONS (CIRCLED)

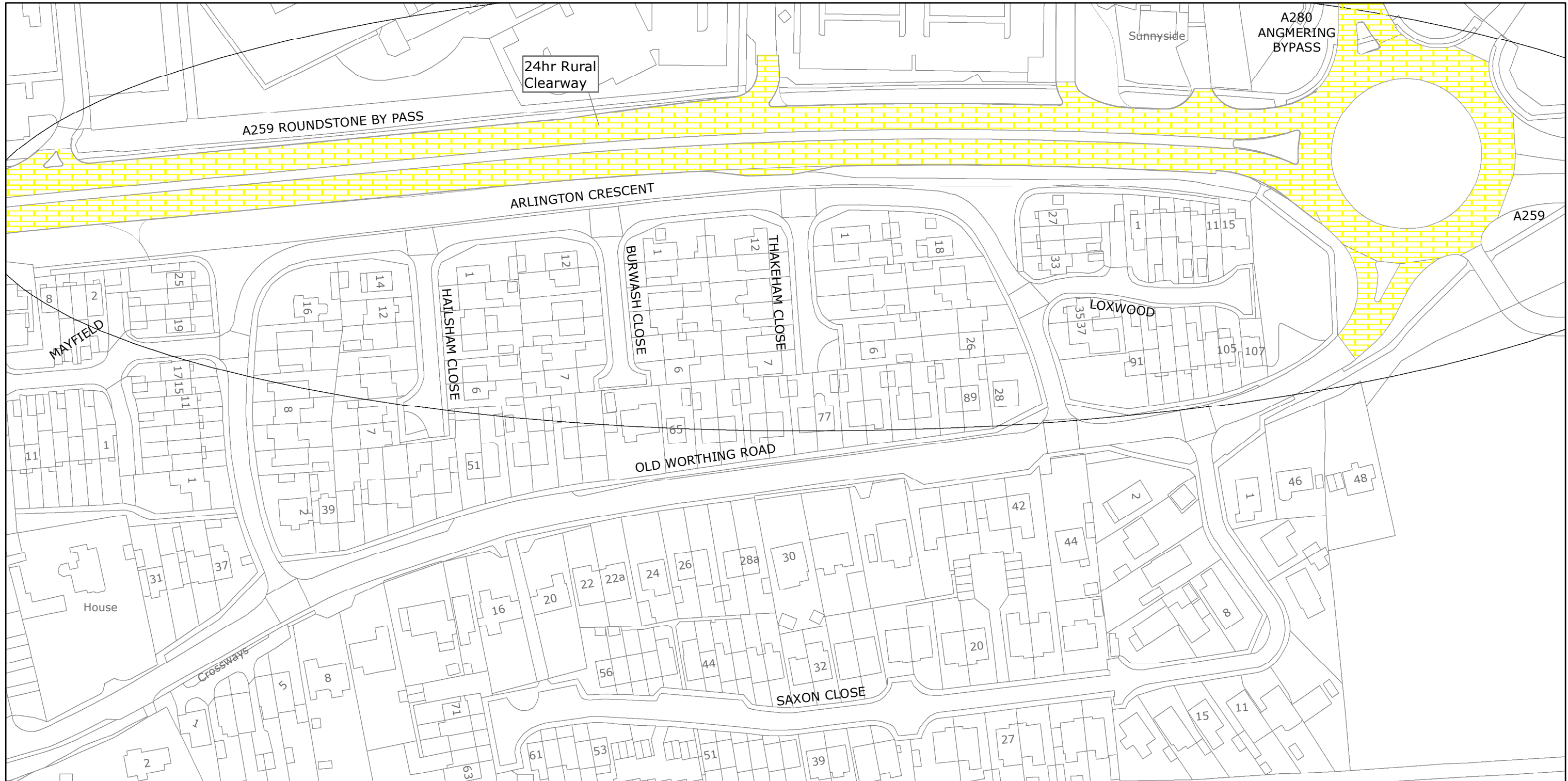

West Sussex County Council  
 Highways & Transport  
 The Grange  
 Tower Street  
 Chichester  
 West Sussex  
 PO19 1RH

ARUN DISTRICT: ANGMERING AND EAST PRESTON  
 PROPOSED WAITING RESTRICTIONS (11.10.2021)

TILE REF NO:  
 TQ0703SES

SHEET ISSUE NO 1\_JEA8013  
 SHEET ACTIVE FROM - DD.MM.YYYY



SCALE:  
 1:1250  
 at A3 size

Reproduced from or based upon 2021 Ordnance Survey mapping with permission of the Controller of HMSO (c) Crown Copyright reserved.  
 Unauthorised reproduction infringes Crown copyright and may lead to prosecution or civil proceedings West Sussex County Council Licence No. 100018485

PAGE 1 OF 2: EXISTING RESTRICTIONS ONLY

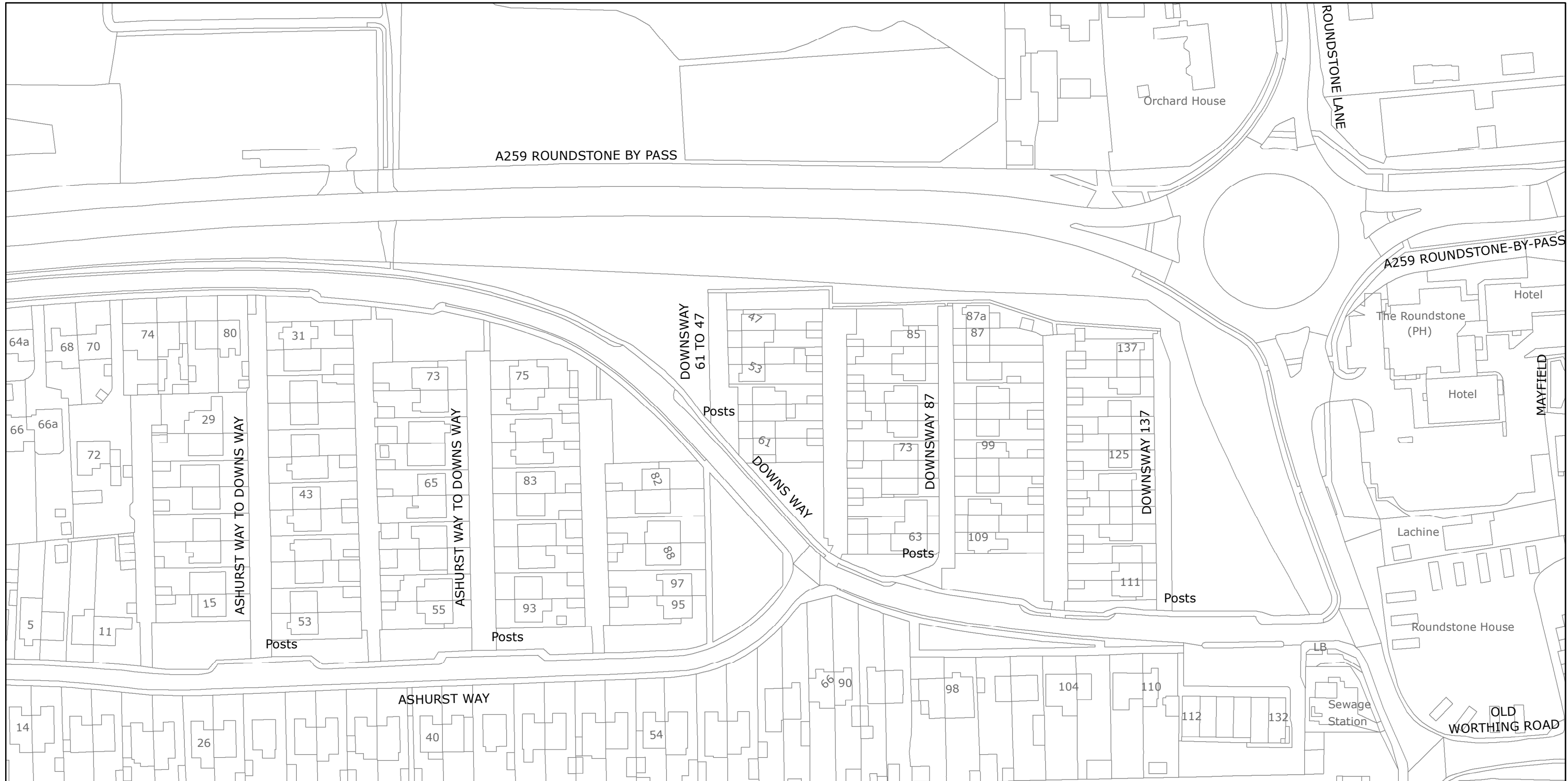

West Sussex County Council  
Highways & Transport  
The Grange  
Tower Street  
Chichester  
West Sussex  
PO19 1RH

ARUN DISTRICT: ANGMERING  
NO EXISTING WAITING RESTRICTIONS

Reproduced from or based upon 2021 Ordnance Survey mapping with permission of the Controller of HMSO (c) Crown Copyright reserved.  
Unauthorised reproduction infringes Crown copyright and may lead to prosecution or civil proceedings West Sussex County Council Licence No. 100018485

TILE REF NO:  
TQ0703SWS

SHEET ISSUE NO  
SHEET ACTIVE FROM -



SCALE:  
1:1250  
at A3 size

PAGE 2 OF 2: PROPOSED CHANGES TO RESTRICTIONS (CIRCLED)

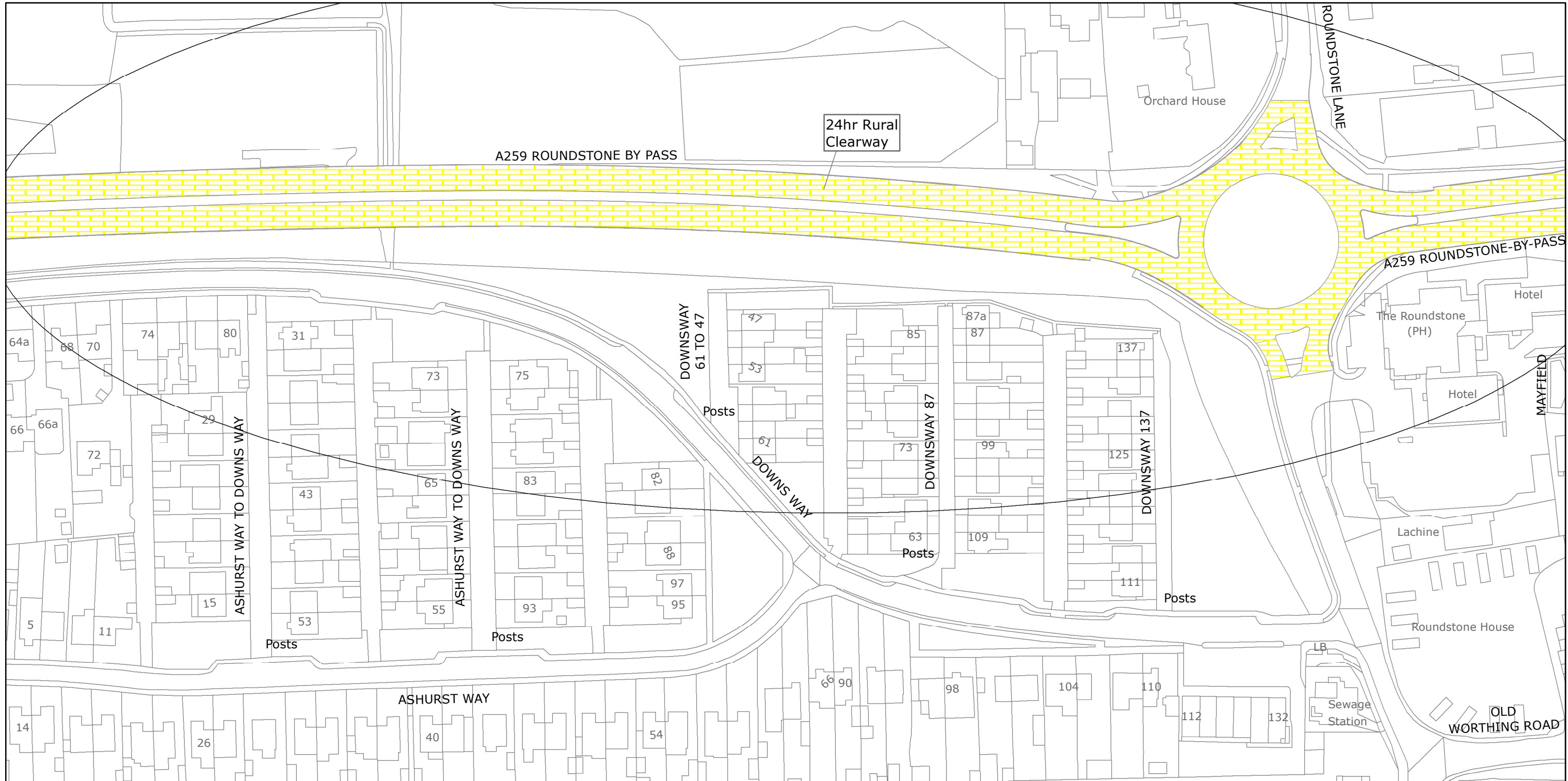

West Sussex County Council  
 Highways & Transport  
 The Grange  
 Tower Street  
 Chichester  
 West Sussex  
 PO19 1RH

ARUN DISTRICT: ANGMERING  
 PROPOSED WAITING RESTRICTIONS (11.10.2021)

Reproduced from or based upon 2021 Ordnance Survey mapping with permission of the Controller of HMSO (c) Crown Copyright reserved.  
 Unauthorised reproduction infringes Crown copyright and may lead to prosecution or civil proceedings West Sussex County Council Licence No. 100018485

TILE REF NO:  
 TQ0703SWS

SHEET ISSUE NO 1\_JEA8013  
 SHEET ACTIVE FROM - DD.MM.YYYY



SCALE:  
 1:1250  
 at A3 size

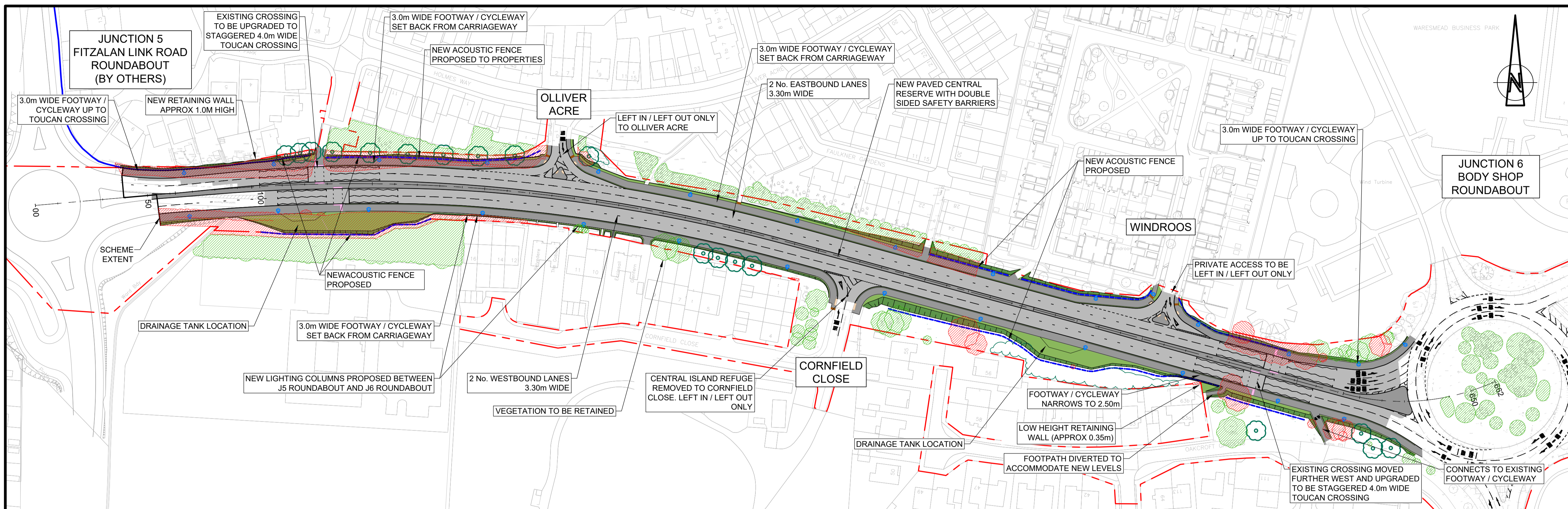

DO NOT SCALE FROM THIS DRAWING

NOTES

1. ALL DIMENSIONS ARE IN MILLIMETRES AND LEVELS ARE IN METRES ABOVE ORDNANCE DATUM UNLESS NOTED OTHERWISE.

- HIGHWAY BOUNDARY INCL CPO
- ACOUSTIC FENCING
- ▨ PROPOSED EXTENT OF VEGETATION CLEARANCE
- ▨ VEGETATION TO BE RETAINED
- NEW TREES/NATIVE SHRUBS

KEY PLAN

**PHASE 1 DUALLING**  
**JUNCTION 5 (FITZALAN LINK ROAD ROUNDABOUT) TO JUNCTION 6 (BODY SHOP ROUNDABOUT)**  
 SCALE 1:1000

- OVERVIEW (JUNCTION 5-6)**
- JUNCTION 5 (FITZALAN LINK ROAD) TO JUNCTION 6 (BODY SHOP ROUNDABOUT)
  - WIDENING OF THE EXISTING SINGLE CARRIAGEWAY TO DUAL CARRIAGEWAY IN BOTH DIRECTIONS.
  - NEW FITZALAN LINK ROAD/LYMINSTER BY-PASS ROUNDABOUT DELIVERED BY DEVELOPERS
  - NEW SHARED FOOTWAY / CYCLEWAY FACILITY PROVIDED ON THE SOUTH SIDE OF THE A259.
  - EXISTING RIGHT TURN ACCESS TO BE REMOVED IN FAVOUR OF LEFT IN/LEFT OUT ACCESS AT OLLIVER ACRE, CORNFIELD CLOSE AND WINDROOS.
  - FOOTWAY/CYCLEWAY RETAINED ON THE NORTH SIDE.
  - TWO NEW TOUCAN CROSSINGS
  - SPEED LIMIT REMAINS 40mph.

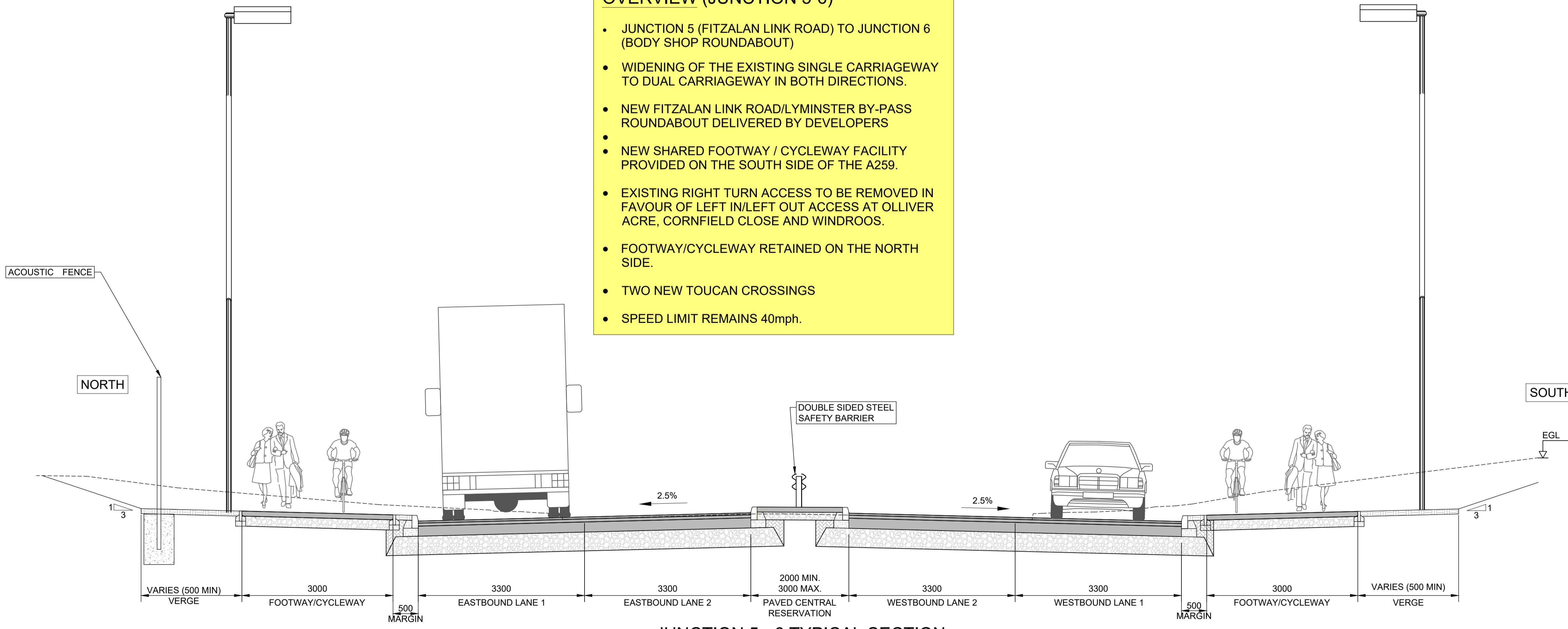

**JUNCTION 5 - 6 TYPICAL SECTION**  
 SCALE 1:50



REV.	BY	CHKD	APPD	DATE	DESCRIPTION
P04	ARL	ARL	ARL	08/08/20	UPDATED BASED ON DETAILED DESIGN
P03	UKG	LD	ARL	05/11/18	UPDATED VEG. SITE CLEARANCE HATCHING
P02	TCH	LD	ARL	10/04/18	SECOND ISSUE

CODE: **S2** DRAWING STATUS: **FOR INFORMATION**

**Tony Gee and Partners LLP**  
 Hardy House  
 140 High Street  
 Esher, Surrey  
 KT10 9QJ  
 Tel: 01372 461600  
 www.tonygee.com  
 Consulting Civil, Structural and Geotechnical Engineers

ON BEHALF OF  
**VolkerFitzpatrick**

OVERALL CLIENT  
  
**west sussex county council**

**A259 LITTLEHAMPTON CORRIDOR IMPROVEMENTS (EAST ARUN)**

**HIGHWAYS DETAILED DESIGN JUNCTION 5-6 PLAN & TYPICAL SECTION**  
 SHEET 1

DRAWING No. C117083-TG-GEN-S1-DR-CH-4001		
DRAWN : AJT	DESIGNED : CW	REVISION
SCALE : AS SHOWN	ORIGINAL SIZE : A1	<b>P03</b>

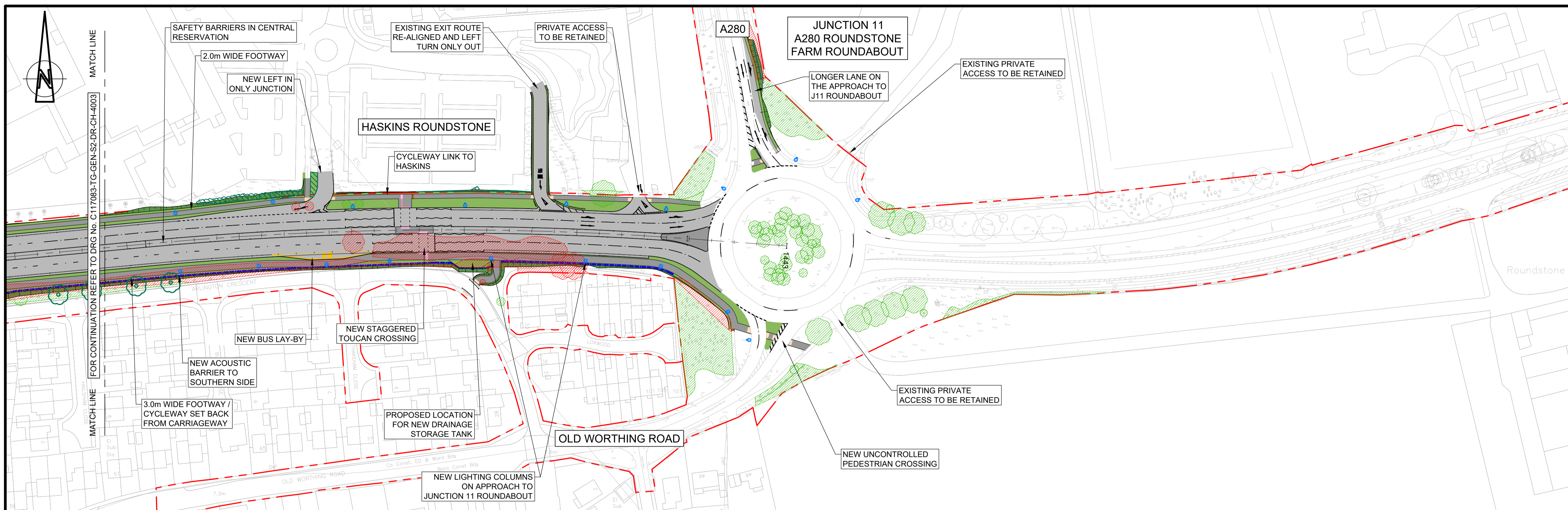

DO NOT SCALE FROM THIS DRAWING

NOTES  
1. ALL DIMENSIONS ARE IN MILLIMETRES AND LEVELS ARE IN METRES ABOVE ORDNANCE DATUM UNLESS NOTED OTHERWISE.

- HIGHWAY BOUNDARY INCL CPO
- ACUSTIC FENCING
- PROPOSED EXTENT OF VEGETATION CLEARANCE
- VEGETATION TO BE RETAINED
- NEW TREES/NATIVE SHRUBS

KEY PLAN

**PHASE 1 DUALLING**  
**JUNCTION 10 (ROUNDSTONE LANE ROUNDABOUT) TO JUNCTION 11 (A280 ROUNDSTONE FARM ROUNDABOUT)**  
 SCALE 1:1000

- OVERVIEW (JUNCTION 11)**
- JUNCTION 9 (STATION ROAD) TO JUNCTION 11 (A280)
  - WIDENING OF THE EXISTING SINGLE CARRIAGEWAY TO DUAL CARRIAGEWAY IN BOTH DIRECTIONS.
  - ROUNDABOUTS TO BE UPGRADED TO ALLOW FOR DUAL CARRIAGEWAY ON THE APPROACHES AND TO IMPROVE TRAFFIC FLOW.
  - NEW SHARED FOOTWAY / CYCLEWAY FACILITY PROVIDED ON THE SOUTH SIDE OF THE A259. NEW FOOTWAY PROVIDED ON THE NORTH SIDE
  - NEW SIGNALISED TOUCAN CROSSING BETWEEN HASKINS ENTRY AND EXIT POINTS.
  - SPEED LIMIT REMAINS 50mph.

REV.	BY	CHKD	APPD	DATE	DESCRIPTION
P04	ARL	ARL	ARL	08/08/20	UPDATED BASED ON DETAILED DESIGN
P03	UKG	LD	ARL	27/09/18	UPDATED VEG. SITE CLEARANCE
P02	TCH	LD	ARL	10/04/18	SECOND ISSUE

CODE: **S2** DRAWING STATUS: **FOR INFORMATION**

**Tony Gee** and Partners LLP  
 Hardy House  
 140 High Street  
 Esher, Surrey  
 KT10 9QJ  
 Tel: 01372 461600  
 www.tonygee.com  
 Consulting Civil, Structural and Geotechnical Engineers

ON BEHALF OF

**VolkerFitzpatrick**

OVERALL CLIENT

**west sussex county council**

**A259 LITTLEHAMPTON CORRIDOR IMPROVEMENTS (EAST ARUN)**

**HIGHWAYS DETAILED DESIGN**  
**JUNCTION 10-11**  
**PLAN & TYPICAL SECTION**  
 SHEET 4

DRAWING No. **C117083-TG-GEN-S2-DR-CH-4004**

DRAWN: AJT	DESIGNED: CW	REVISION
SCALE: AS SHOWN	ORIGINAL SIZE: A1	<b>P03</b>

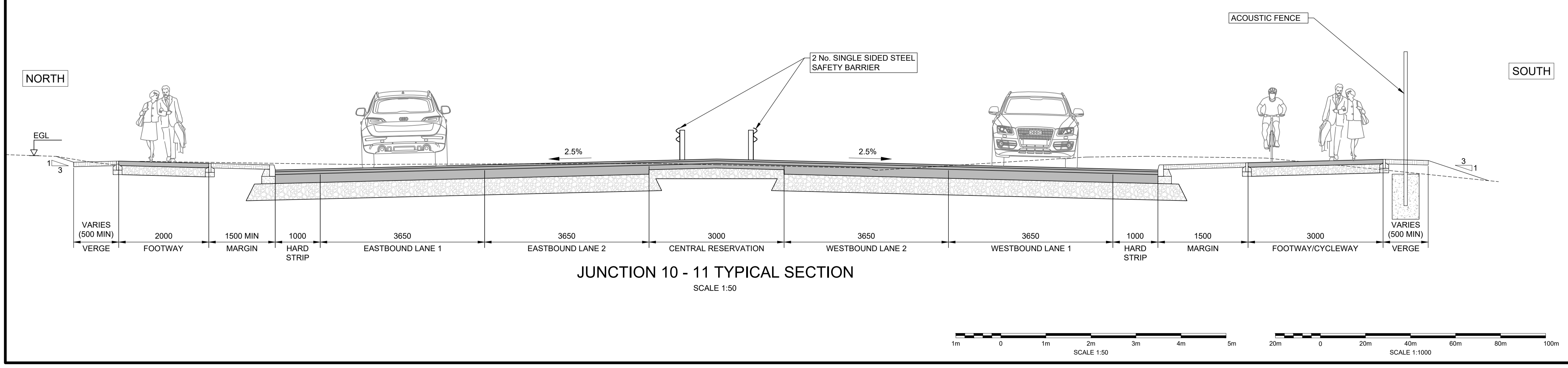

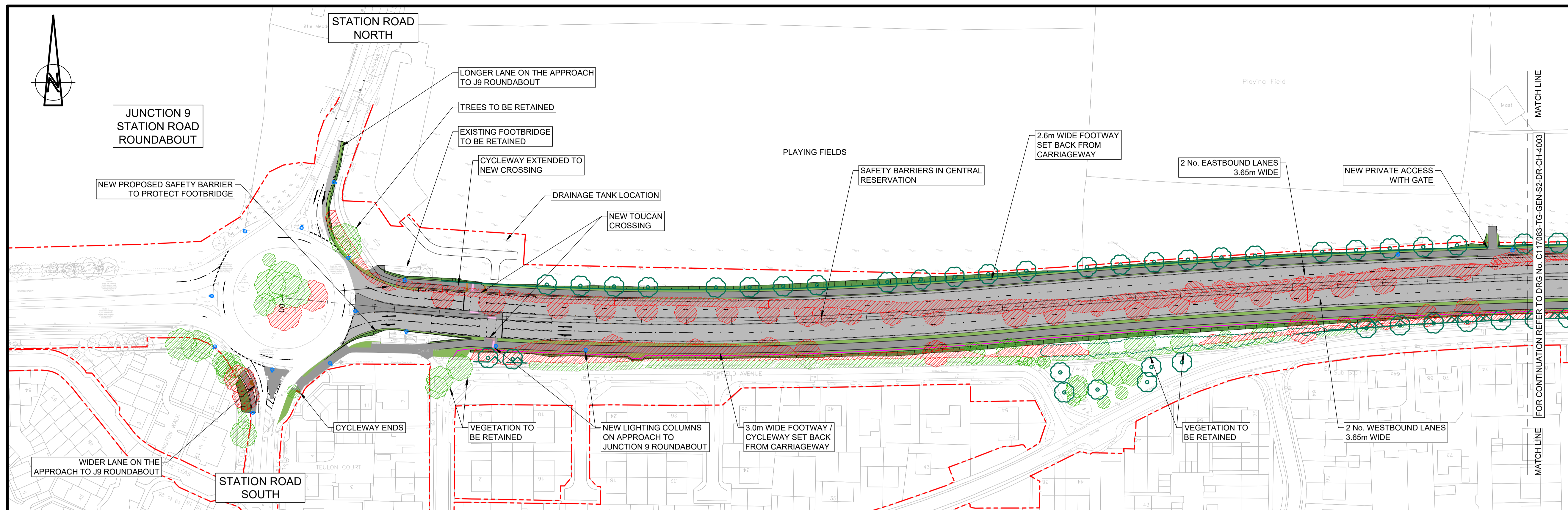

PHASE 1 DUALLING  
 JUNCTION 9 (STATION ROAD ROUNDABOUT) TO JUNCTION 10 (ROUNDSTONE LANE ROUNDABOUT)  
 SCALE 1:1000

- OVERVIEW (JUNCTION 9-10)**
- JUNCTION 9 (STATION ROAD) TO JUNCTION 11 (A280)
  - WIDENING OF THE EXISTING SINGLE CARRIAGEWAY TO DUAL CARRIAGEWAY IN BOTH DIRECTIONS.
  - ROUNDABOUTS TO BE UPGRADED TO ALLOW FOR DUAL CARRIAGEWAY ON THE APPROACHES AND TO IMPROVE TRAFFIC FLOW.
  - NEW SHARED FOOTWAY / CYCLEWAY FACILITIES PROVIDED ON THE SOUTH SIDE OF THE A259 AND NEW FOOTWAY ON THE NORTH SIDE.
  - LAYBYS REMOVED AND NO WORK PROPOSED TO THE FOOTBRIDGE AT STATION ROAD ROUNDABOUT. NEW TOUCAN CROSSING EAST OF FOOTBRIDGE.
  - EXISTING SIGNALISED CROSSING UPGRADED TO A STAGGERED TOUCAN CROSSING.
  - SPEED LIMIT REMAINS 50mph.

DO NOT SCALE FROM THIS DRAWING

NOTES  
 1. ALL DIMENSIONS ARE IN MILLIMETRES AND LEVELS ARE IN METRES ABOVE ORDNANCE DATUM UNLESS NOTED OTHERWISE.

- HIGHWAY BOUNDARY INCL CPO
- ACOUSTIC FENCING
- PROPOSED EXTENT OF VEGETATION CLEARANCE
- VEGETATION TO BE RETAINED
- NEW TREES/NATIVE SHRUBS

KEY PLAN

REV.	BY	CHKD	APPD	DATE	DESCRIPTION
P04	ARL	ARL	ARL	08/08/20	UPDATED BASED ON DETAILED DESIGN
P03	UKG	LD	ARL	27/09/18	UPDATED VEG. SITE CLEARANCE
P02	TCH	LD	ARL	10/04/18	SECOND ISSUE

CODE: **S2** DRAWING STATUS: **FOR INFORMATION**

**Tony Gee** and Partners LLP  
 Hardy House  
 140 High Street  
 Esher, Surrey  
 KT10 9QJ  
 Tel: 01372 461600  
 www.tonygee.com  
 Consulting Civil, Structural and Geotechnical Engineers

ON BEHALF OF  
**VolkerFitzpatrick**

OVERALL CLIENT  
**west sussex county council**

A259 LITTLEHAMPTON CORRIDOR IMPROVEMENTS (EAST ARUN)

HIGHWAYS DETAILED DESIGN  
 JUNCTION 9-10  
 PLAN & TYPICAL SECTION  
 SHEET 2

DRAWING No. C117083-TG-GEN-S2-DR-CH-4002

DRAWN : AJT	DESIGNED : CW	REVISION
SCALE : AS SHOWN	ORIGINAL SIZE : A1	P03

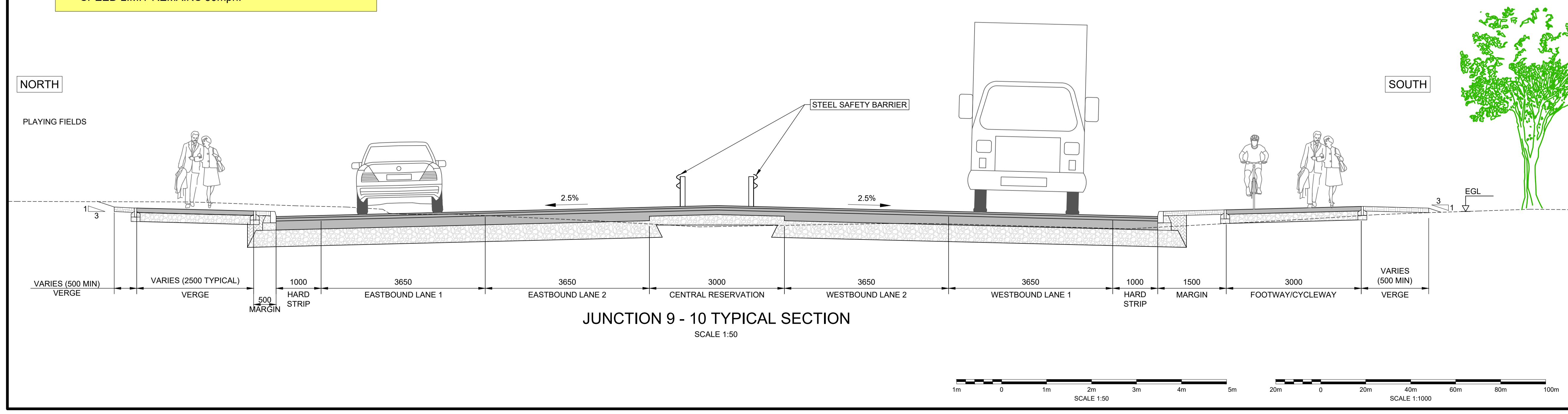

JUNCTION 9 - 10 TYPICAL SECTION  
 SCALE 1:50

