

TRAFFIC REGULATION ORDER (TRO) CONSULTATION

ADR9017MM – Monks Farm Development, Lancing

6/10/22 – 3/11/22

Contents

Notice	Page 2
Statement of Reasons	Page 3
Draft Order	Page 4
Plan "Prohib of Driving" - existing & proposed	Page 6
Plan "Speed Limits" - existing & proposed	Page 7

West Sussex County Council
(Lancing: Coombes Road and Various Roads) (30 MPH Speed Limit) and (Traffic Regulation) Order 2022

NOTICE is hereby given that West Sussex County Council proposes to make a permanent Traffic regulation Order under the provisions of the Road Traffic Regulation Act 1984, the effect of which will be to introduce 30 MPH speed limits on the following roads in Lancing:

Coombes Road – from a point 60m south of its junction with The Drive, northwards for a distance of 120m; and

Sussex Pad Access Road/The Drive - from its junction with Coombes Road, westwards to the (to be constructed) roundabout at its junction with the A27; and

New Link Road to New Monks Farm Development – from the (to be constructed) roundabout at its junction with the A27 and The Drive, southwards to the roundabout at its junction with the Old Shoreham Road Link Road.

The Order also introduces a new prohibition of driving on **Coombes Road** from a point 60m south of its junction with The Drive, to its current junction with the A27, and on **Old Shoreham Road**, from its junction with the Old Shoreham Road Link Road, northwards to its current junction with the A27.

These restrictions reflect the new road layout due to be constructed at the junctions of the A27 with The Drive, Coombes Road and Old Shoreham Road as part of the New Monks Farm development.

Full details of the proposals in this notice can be viewed on the Traffic Regulation Order page of the West Sussex County Council website. The [website](#) includes a response form for any comments or objections.

People without access to a computer who wish to view details of the scheme should telephone the West Sussex County Council Contact Centre on 01243 642105 to receive the documents by post.

Any comments or objections about the proposal must be received before 3 November 2022. These may be submitted via the response form on the website mentioned above, by e-mail to tro.consultation@westsussex.gov.uk or in writing to TRO Team, West Sussex County Council, The Grange, Tower Street, Chichester, PO19 1RH. For legal reasons, only correspondence including a full name and address will be considered. Please quote reference ADR9017-MM in all correspondence.

Dated this 6th day of October 2022.
Director of Law & Assurance, County Hall, Chichester.

West Sussex County Council
(Lancing: Coombes Road and Various Roads) (30 MPH Speed Limit) and (Traffic Regulation) Order 2022

Statement of Reasons for Proposing to Make the Order

West Sussex County Council proposes to make a permanent Traffic Regulation Order that will introduce 30 MPH speed limits on the following roads in Lancing:

Coombes Road – from a point 60m south of its junction with Sussex Pad Access Road/The Drive, northwards for a distance of 120m; and
Sussex Pad Access Road/The Drive - from its junction with Coombes Road, westwards to the (to be constructed) roundabout at its junction with the A27; and
New Link Road to New Monks Farm Development – from the (to be constructed) roundabout at its junction with the A27 and The Drive, southwards to the roundabout at its junction with the Old Shoreham Road Link Road.

The Order also introduces a new prohibition of driving on **Coombes Road** from a point 60m south of its junction with The Drive, to its current junction with the A27, and on **Old Shoreham Road**, from its junction with the Old Shoreham Road Link Road, northwards to its current junction with the A27.

Planning permission has been granted for a new development at New Monks Farm in Lancing, which is presently under construction. The development will be accessed via a new roundabout which will be constructed on the A27, west of the current traffic lights at its junction with Coombes Road and Old Shoreham Road. The current traffic light junction will be closed, and new link roads constructed to provide access to Coombes Road and Old Shoreham Road from the new roundabout.

The proposed TRO enacts new 30 mph speed limits on the new link road between the A27 and Coombes Road. This new road will also provide access to the Sussex Pad restaurant and a 30 mph speed limit is considered appropriate to maintain safety on the new road. This speed limit also extends a short distance into Coombes Road to maintain safety at the new junction layout.

The prohibition of driving restrictions are needed to enact the closure of the current junctions of Coombes Road and Old Shoreham Road with the A27. Access to these roads will be maintained via new link roads as described above.

The new order is therefore proposed to avoid danger to persons or other traffic using the affected lengths of road.

The attached drawing, titled New Monks Farm Proposed Speed Limits shows the speed limits associated with this proposal. The attached drawing, titled New Monks Farm S278 Side Road Order shows the proposed prohibition of Driving Restrictions.

Director of Law & Assurance
21 July 2022
ADR9017-MM

WEST SUSSEX COUNTY COUNCIL
(LANCING: COOMBES ROAD AND VARIOUS ROADS) (30 MPH SPEED LIMIT) AND
(TRAFFIC REGULATION) ORDER 2022

West Sussex County Council in exercise of their powers under Section 84 (1) a of the Road Traffic Regulation Act 1984 ("the Act"), and after consultation with the chief officer of police in accordance with Part III and Part IV of Schedule 9 to the Act hereby make the following Order:-

1. This Order shall come into operation on the ***** day of ***** and may be cited as "West Sussex County Council (Lancing: Coombes Road and Various Roads) (30 MPH Speed Limit) and (Traffic Regulation) Order 2022"
2. No person shall cause or permit any vehicle to proceed at a speed exceeding 30 miles per hour in the length of road specified in the First Schedule to this Order.
3. Nothing in Paragraph 3 shall apply to a vehicle being used by naval, military or air force purposes while being driven by a person for the timebeing subject to the orders of a member of the armed forces of the Crown on an occasion when –
 - (a) the person driving the vehicle is a member of the special forces as defined by the Road Traffic Exemptions (Special Forces) (Variation and Amendment) Regulations 2011; and
 - (b) the vehicle is being driven-
 - (i) in response, or for practice in responding, to a national security emergency by a person who has been trained in driving vehicles at high speeds; or
 - (ii) for the purpose of training a person in driving vehicles at high speeds.
4. No Person shall cause or permit any vehicle to proceed on the lengths of roads specified in the Second Schedule to this Order.
5. Nothing in Article 4 shall apply to:
 - i) A vehicle being used by the police, Fire Brigade or Ambulance Service in the event of an emergency; or
 - ii) A vehicle directed to proceed by a police officer in uniform

FIRST SCHEDULE
30 MPH Speed Limit

Road in Lancing	Length of Restriction
Coombes Road	From a point 60 metres south of its junction with Sussex Pad Access Road/The Drive, northwards for a distance of 120 metres.
Sussex Pad Access Road/The Drive	From its junction with Coombes Road, westwards to the roundabout at its junction with the A27.
New Link Road to New Monks Farm Development	From the roundabout at its junction with the A27, southwards to the roundabout at its junction with the Old Shoreham Road Link Road

SECOND SCHEDULE
Prohibition of Driving

Road in Lancing	Length of Restriction
Coombes Road	From a point 60 metres south of its junction with Sussex Pad Access Road/The Drive, southwards to its junction with the A27.
Old Shoreham Road	From its junction with the Old Shoreham Road Link Road, northwards to its junction with the A27.

Explanatory Note – This Order enacts restrictions on new roads and new road layouts which have not been constructed or formally named at the time it is necessary to prepare the Order. It is expressly the intention of the Council that the restrictions enacted by this Order shall apply to the roads described in the schedules if they are subsequently assigned different names after the Order is made.

For and on behalf of WEST SUSSEX COUNTY COUNCIL

Authorised Signatory:

NAME:

DATE MADE:

ADR9017-MM

EXISTING SPEED LIMITS
SCALE: 1:2000

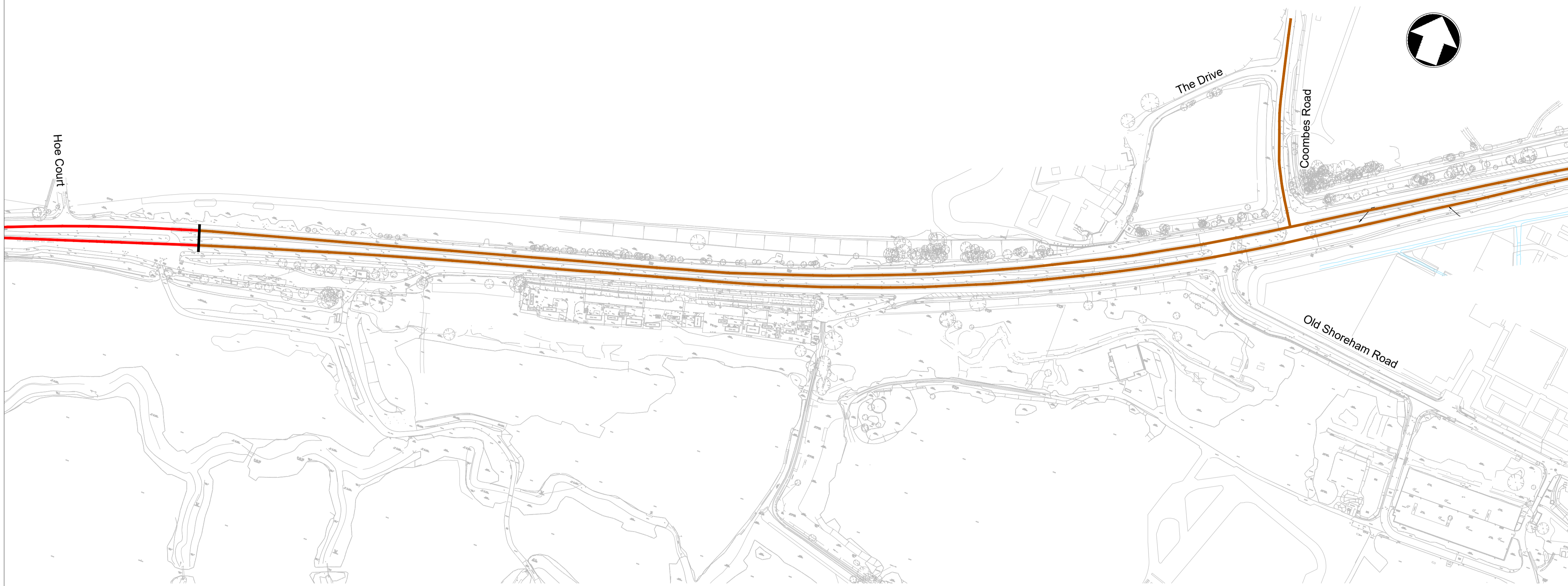

PROPOSED SPEED LIMITS
SCALE: 1:2000

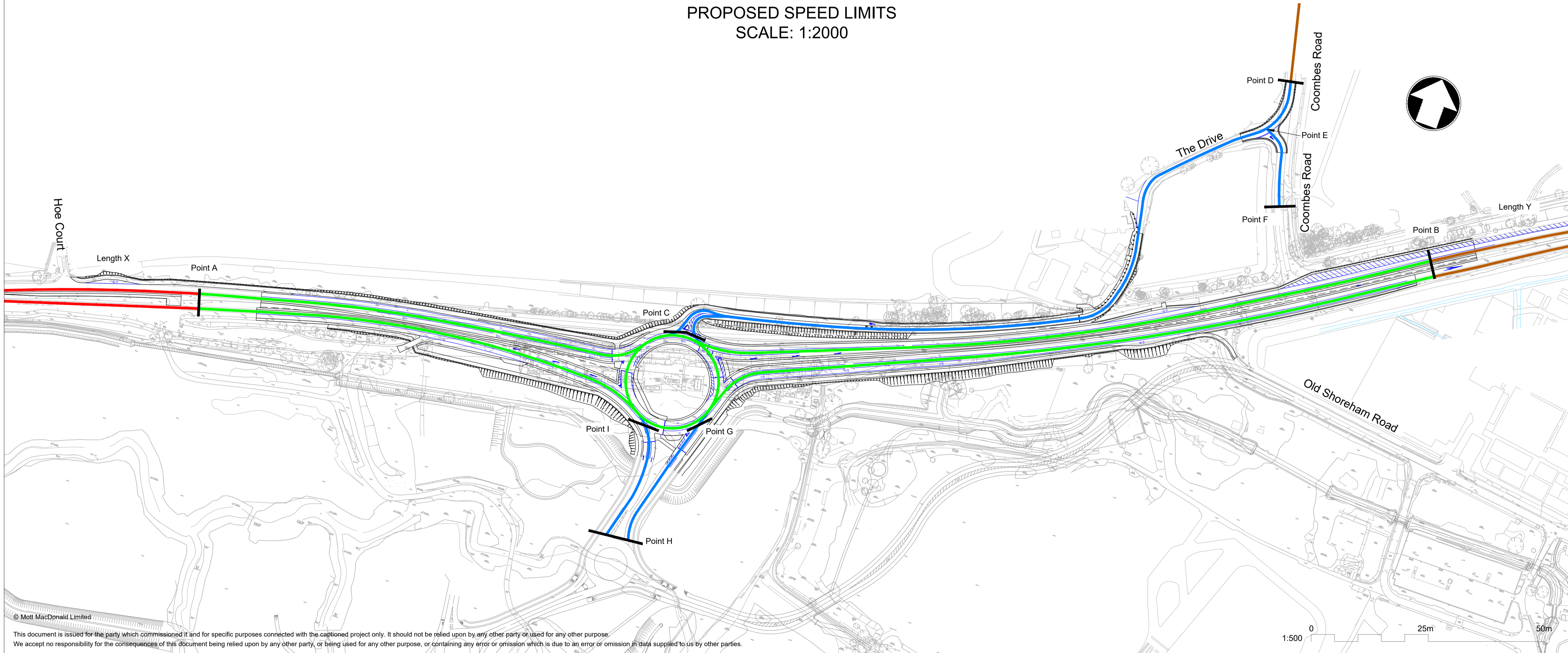

- Notes
1. General arrangement design based on the Proposed A27 Old Shoreham Road Improvements Development Access & Sussex via Iancing College Drawing VN201557/PL-03 rev. E produced by Vectos September 2020.
 2. This drawing should be read in conjunction with all design drawings and specifications.
 3. All dimensions are in meters unless otherwise stated. All levels are in meters above Ordnance Datum (AOD). All dimensions and levels should be checked on site. All levels are in meters above Ordnance Datum (AOD). All dimensions and levels should be checked on site.
 4. Do not scale any items of information from the drawing.

Key to symbols

—	Existing 40 mph Limit
—	Existing National Speed Limit
—	Proposed 30 mph Limit
—	Proposed 50 mph Limit

Reference drawings

HE600434-MMD-HGN-A27_4-DR-CH-0101 - Highways General Arrangement 1 of 5
 HE600434-MMD-HGN-A27_4-DR-CH-0102 - Highways General Arrangement 2 of 5
 HE600434-MMD-HGN-A27_4-DR-CH-0103 - Highways General Arrangement 3 of 5
 HE600434-MMD-HGN-A27_4-DR-CH-0104 - Highways General Arrangement 4 of 5
 HE600434-MMD-HGN-A27_4-DR-CH-0105 - Highways General Arrangement 5 of 5

C01	08/12/21	AZ	Issue for construction	MP	IM
Rev	Date	Drawn	Description	Ch'k'd	App'd

Status Stamp

FOR CONSTRUCTION

M
MOTT
MACDONALD

Mott MacDonald House
8-10 Sydenham Road
Croydon
CR0 2EE
United Kingdom
T +44 (0)20 8774 2000
F +44 (0)20 8681 5706
W www.mottmac.com

Client
Community Stadium Ltd
American Express Community Std.
Village Way, Falmer
Brighton
BN1 9BL

Title
New Monks Farm S278
Proposed Speed Limits

Sheet 1 of 1

Designed	A.ZAVADSKA	AZ	Eng check	M.PEKNICA	MP
Drawn	A.ZAVADSKA	AZ	Coordination	S.JARVIS	SJ
Dwg check	M.PEKNICA	MP	Approved	I.D.MACGREGOR	IM
MMD Project Number	387562		Scale at A1	AS SHOWN	Security
Suitability Description	Published - BUILD & COMMISSION				STD
Drawing Number	HE600434-MMD-HGN-A27_4-DR-CH-0141				Suit. Code
					A5
					Revision
					C01