

**TRAFFIC REGULATION ORDER (TRO) CONSULTATION**

**MDS9001MM – Mid Sussex EV Charging Bays**

**10/11/22 – 1/12/22**

**Contents**

Notice	Page 2
Statement of Reasons	Page 3
Draft Order	Page 5
Plans (existing & proposed)	Pages 7-22

**West Sussex County Council**  
**((Mid Sussex District) (Parking Places & Traffic Regulation) (Consolidation**  
**No.2) Order 2006)**

**(Various Roads: Electric Vehicle Charging Amendment) Order 2022**

NOTICE is hereby given that West Sussex County Council proposes to make a permanent Traffic regulation Order under the provisions of the Road Traffic Regulation Act 1984, the effect of which will be to introduce parking bays for use only by electric vehicles being recharged at any time on the following roads in Mid Sussex District:

BURGESS HILL: Eastdale Road (north side, layby west of Manor Road junction), Grove Road (north side, east of Mill Road junction), Howard Avenue (west side, south of Perryfields junction). HASSOCKS: Clayton Avenue (north side, west of Downs View Road junction), Parklands Road (south side, west of Windmill Avenue junction). HAYWARDS HEATH: Appledore Gardens (west side, north of Pelham Road junction), Priory Way (east side, north of Syresham Gardens junction). TURNERS HILL: Withypits East (north side west of Withypits junction).

At each of these locations it is proposed to install on-street electric vehicle charging points. Each bay will accommodate six vehicles.

Full details of the proposals, including detailed plans showing the location of the proposed bays, can be viewed on the Traffic Regulation Order page of the West Sussex County Council website. The [website](#) includes a response form for any comments or objections.

People without access to a computer who wish to view details of the scheme should telephone the West Sussex County Council Contact Centre on 01243 642105 to receive the documents by post.

Any comments or objections about the proposal must be received before 1 December 2022. These may be submitted via the response form on the website mentioned above, by e-mail to [tro.consultation@westsussex.gov.uk](mailto:tro.consultation@westsussex.gov.uk) or in writing to TRO Team, West Sussex County Council, The Grange, Tower Street, Chichester, PO19 1RH. For legal reasons, only correspondence including a full name and address will be considered. Please quote reference MDS9001-MM in all correspondence.

Dated this 10th day of November 2022.  
Director of Law & Assurance, County Hall, Chichester.

**West Sussex County Council**  
**((Mid Sussex District) (Parking Places & Traffic Regulation) (Consolidation**  
**No.2) Order 2006)**

**(Various Roads: Electric Vehicle Charging Amendment) Order 2022**

**Statement of Reasons for Proposing to Make the Order**

West Sussex County Council proposes to make a permanent Traffic Regulation Order that will introduce parking bays for use only by electric vehicles being recharged at any time on the following roads in Mid Sussex District:

BURGESS HILL: Eastdale Road (north side, layby west of Manor Road junction), Grove Road (north side, east of Mill Road junction), Howard Avenue (west side, south of Perryfields junction). HASSOCKS: Clayton Avenue (north side, west of Downs View Road junction), Parklands Road (south side, west of Windmill Avenue junction). HAYWARDS HEATH: Appledore Gardens (west side, north of Pelham Road junction), Priors Way (east side, north of Syresham Gardens junction). TURNERS HILL: Withypits East (north side west of Withypits junction).

West Sussex County Council is committed to encouraging the use of electric vehicles and to providing charging facilities to make their use as convenient as possible. A partnership agreement has been entered into with Connected Kerb, who will meet the cost of installing and maintaining electric vehicle charging points in car parks and on-street locations across the county.

More information about the project and how the charge points will operate is available on the Electric Vehicle page of the West Sussex County Council website.

Following local consultation, the first charging points are proposed at locations where existing need has been identified. To ensure the charging points are not obstructed by parked petrol/diesel vehicles, or by electric vehicles which are not being charged, it is proposed to prohibit parking by any vehicle except an electric vehicle on charge at the locations of the new charging points.

The new order is therefore proposed to improve the amenities of the area through which the roads run.

The attached table lists the drawings showing the proposed restrictions and an index of the roads affected by the proposed order.

Director of Law & Assurance  
18 October 2022  
MDS9001-MM

**Roads in Burgess Hill**

Eastdale Road

Grove Road

Howard Avenue

**Roads in Hassocks**

Clayton Avenue

Parklands Road

**Roads in Haywards Heath**

Appledore Gardens

Priory Way

**Road in Turners Hill**

Withypits East

**Drawing Number**

TQ3219NES

TQ3119SES

TQ3019NWN

**Drawing Number**

TQ3015SEN

TQ3015SES

**Drawing Number**

TQ3424NWN

TQ3323SEN

**Drawing Number**

TQ3435SWN

**WEST SUSSEX COUNTY COUNCIL**  
**((MID SUSSEX DISTRICT) (PARKING PLACES & TRAFFIC REGULATION)**  
**(CONSOLIDATION NO.2) ORDER 2006**

**(VARIOUS ROADS: ELECTRIC VEHICLE CHARGING AMENDMENT) ORDER 2022**

West Sussex County Council in exercise of their powers under Sections 1 (a) 2 (1) and (2), 4 (2), 45, 46, 49 and 53 and Part IV of Schedule 9 of the Road Traffic Regulation Act 1984 ("the Act") as amended and of all other enabling powers and after consultation with the Chief Officer of Police in accordance with Part III of Schedule 9 to the Act hereby make the following Order:-

1. The Order shall come into operation on the \*\*\*\* day of \*\*\*\*\* 2022 and may be cited as "West Sussex County Council) ((Mid Sussex District) (Parking Places & Traffic Regulation) (Consolidation No.2) Order 2006) (Electric Vehicle Charging Amendment) Order) Order 2022".
2. The West Sussex County Council (Mid Sussex District) (Parking Places & Traffic Regulation) (Consolidation No.2) Order 2006 is hereby amended by inserting into Article 3.1 the term of interpretation specified in the First Schedule to This Order.
3. The West Sussex County Council (Mid Sussex District) (Parking Places & Traffic Regulation) (Consolidation No.2) Order 2006 is hereby amended by the deletion of the plans specified in the Second Schedule to this Order, and their replacement by the plans specified in the Third Schedule to this Order, attached hereto.
4. The West Sussex County Council (Mid Sussex District) (Parking Places & Traffic Regulation) (Consolidation No.2) Order 2006 is hereby amended by the insertion of the plans specified in the Fourth Schedule to this Order, attached hereto.

**FIRST SCHEDULE**  
**Additional Terms of Interpretation**

"Electric Vehicle Recharging" means an electrically powered vehicle attached to and receiving electric charge from a public electric vehicle charging point installed and operated by West Sussex County Council or their authorised service provider.

**SECOND SCHEDULE**  
**Plans to be Deleted**

TQ3015SEN (Issue Number 7)  
TQ3015SES (Issue Number 3)  
TQ3119SES (Issue Number 5)  
TQ3323SEN (Issue Number 8)  
TQ3424NWN (Issue Number 1)  
TQ3435SWN (Issue Number 3)

**THIRD SCHEDULE**  
**Replacement Plans**

TQ3015SEN (Issue Number 8)  
TQ3015SES (Issue Number 4)  
TQ3119SES (Issue Number 6)  
TQ3323SEN (Issue Number 9)  
TQ3424NWN (Issue Number 2)  
TQ3435SWN (Issue Number 4)

**FOURTH SCHEDULE**  
**Plans to be Inserted**

TQ3019NWN (Issue Number 1)  
TQ3219NES (Issue Number 1)

**For and on behalf of WEST SUSSEX COUNTY COUNCIL**

*Authorised Signatory:*

*NAME:*

*DATE MADE:*  
*MDS9001-MM*

PAGE 1 OF 2: EXISTING RESTRICTIONS ONLY

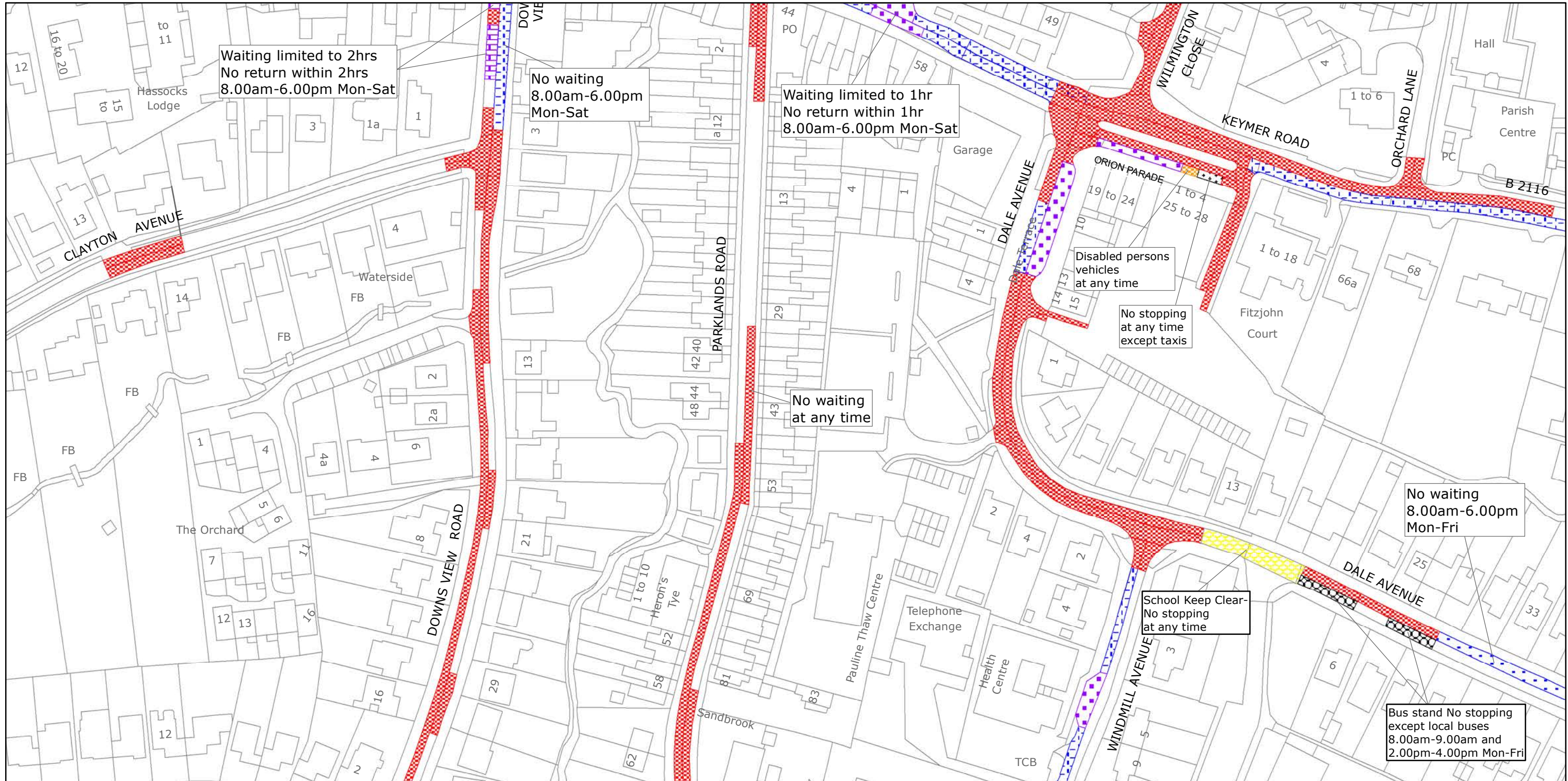

West Sussex County Council  
 Highways & Transport  
 The Grange  
 Tower Street  
 Chichester  
 West Sussex  
 PO19 1RH

MID SUSSEX DISTRICT: HASSOCKS  
 WAITING RESTRICTIONS

Reproduced from or based upon 2021 Ordnance Survey mapping with permission of the Controller of HMSO (c) Crown Copyright reserved.  
 Unauthorised reproduction infringes Crown copyright and may lead to prosecution or civil proceedings West Sussex County Council Licence No. 100018485

TILE REF NO:  
 TQ3015SEN

SHEET ISSUE NO 7  
 SHEET ACTIVE FROM - 22/01/2021



SCALE:  
 1:1250  
 at A3 size

PAGE 2 OF 2: PROPOSED CHANGES TO RESTRICTIONS (CIRCLED)

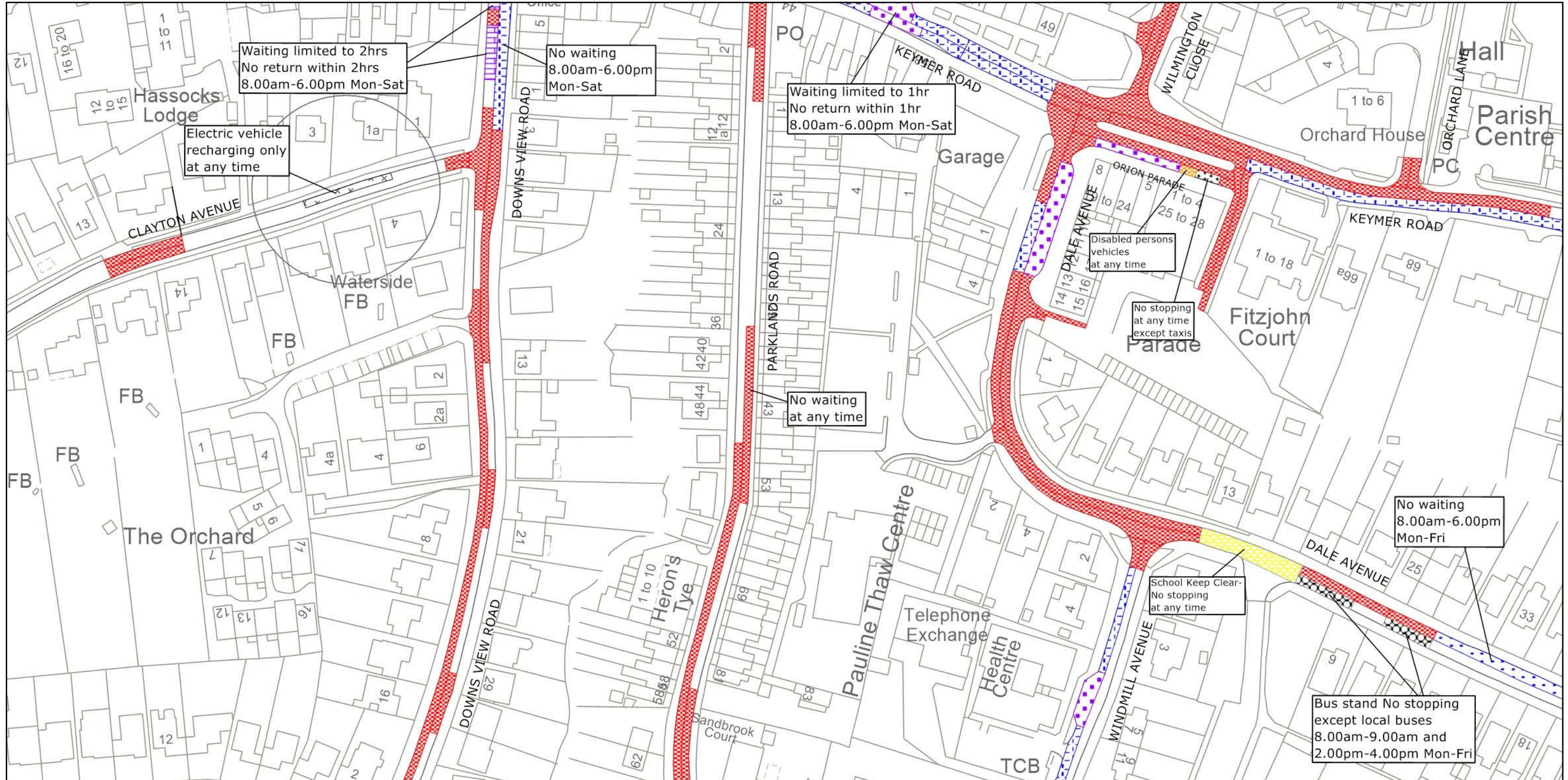

West Sussex County Council  
 Highways & Transport  
 The Grange  
 Tower Street  
 Chichester  
 West Sussex  
 PO19 1RH

MID SUSSEX DISTRICT: HASSOCKS  
 PROPOSED WAITING RESTRICTIONS (12.10.2022)

TILE REF NO:  
 TQ3015SEN  
 SHEET ISSUE NO 8\_MDS9001  
 SHEET ACTIVE FROM - DD.MM.YYYY

N  
 SCALE:  
 1:1250  
 at A3 size

Reproduced from or based upon 2022 Ordnance Survey mapping with permission of the Controller of HMSO (c) Crown Copyright reserved. Unauthorised reproduction infringes Crown copyright and may lead to prosecution or civil proceedings West Sussex County Council Licence No. 100018485



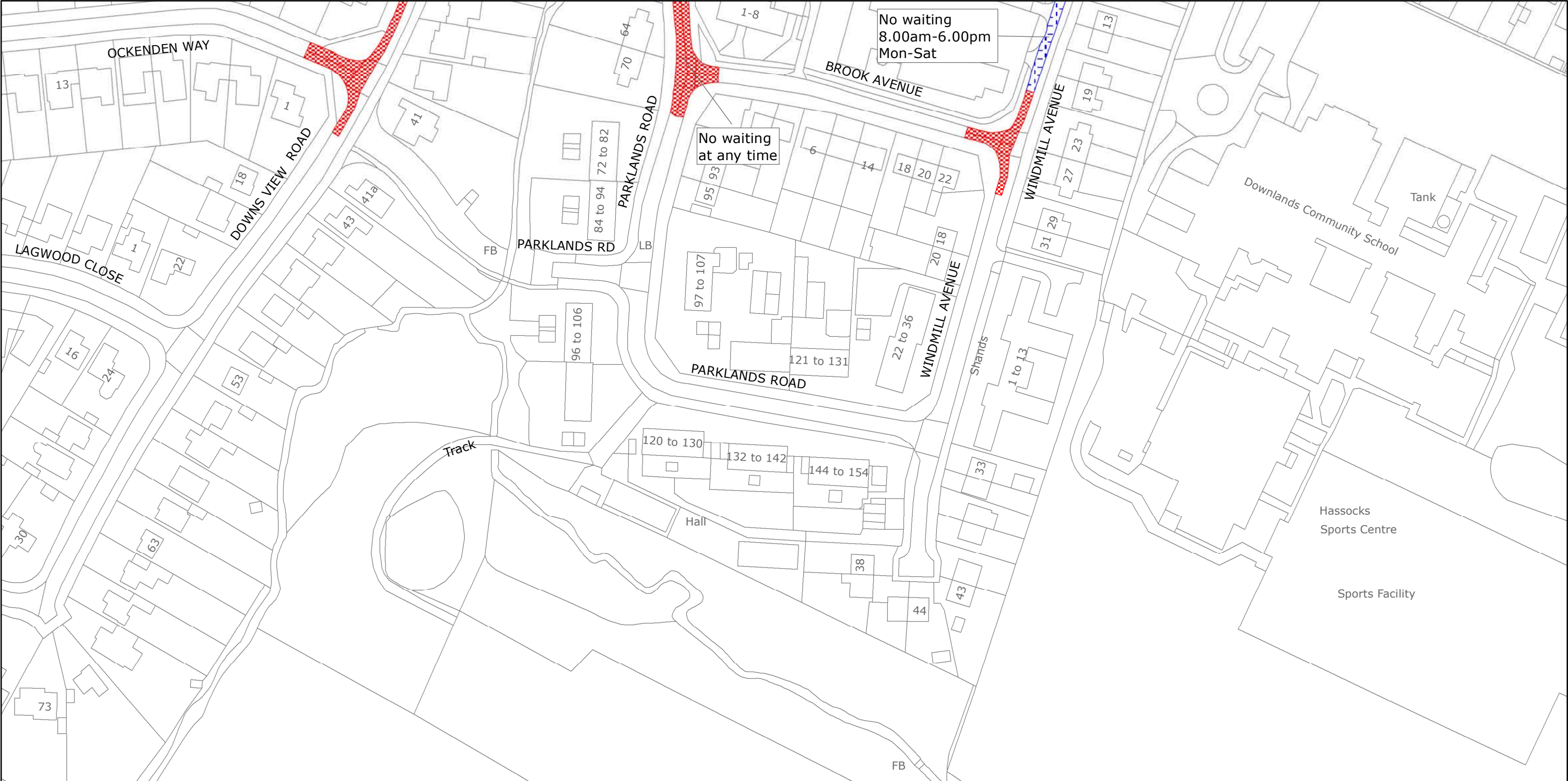

West Sussex County Council  
 Highways & Transport  
 The Grange  
 Tower Street  
 Chichester  
 West Sussex  
 PO19 1RH

MID SUSSEX DISTRICT: HASSOCKS  
 WAITING RESTRICTIONS

Reproduced from or based upon 2021 Ordnance Survey mapping with permission of the Controller of HMSO (c) Crown Copyright reserved.  
 Unauthorised reproduction infringes Crown copyright and may lead to prosecution or civil proceedings West Sussex County Council Licence No. 100018485

TILE REF NO:  
 TQ3015SES

SHEET ISSUE NO 3  
 SHEET ACTIVE FROM - 22/01/2021

N  
  
 SCALE:  
 1:1250  
 at A3 size

PAGE 2 OF 2: PROPOSED CHANGES TO RESTRICTIONS (CIRCLED)

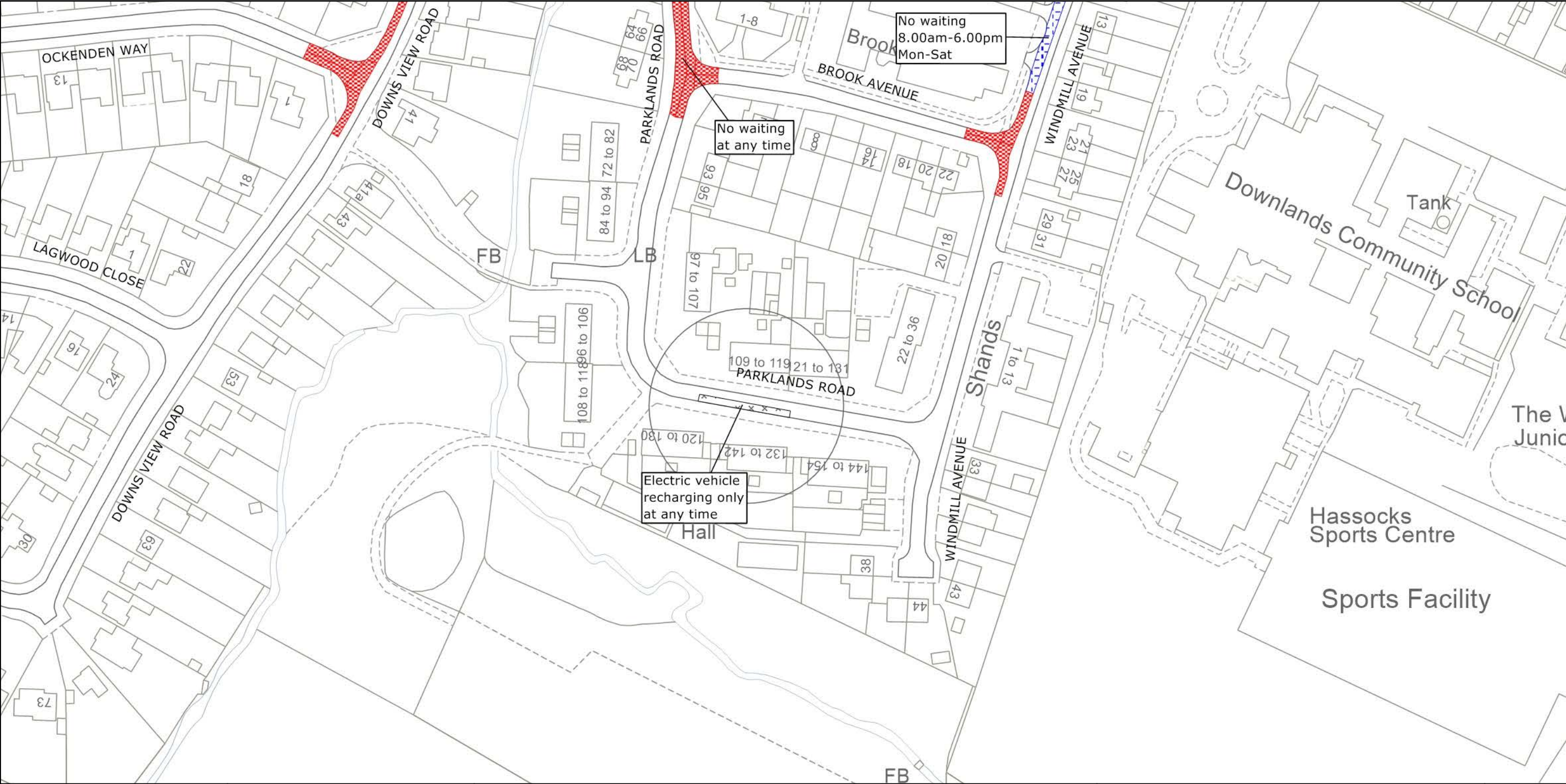

West Sussex County Council  
 Highways & Transport  
 The Grange  
 Tower Street  
 Chichester  
 West Sussex  
 PO19 1RH

MID SUSSEX DISTRICT: HASSOCKS  
 PROPOSED WAITING RESTRICTIONS (12.10.2022)

TILE REF NO:  
**TQ3015SES**  
 SHEET ISSUE NO 4\_MDS9001  
 SHEET ACTIVE FROM - DD.MM.YYYY

N  
  
 SCALE:  
 1:1250  
 at A3 size

Reproduced from or based upon 2022 Ordnance Survey mapping with permission of the Controller of HMSO (c) Crown Copyright reserved. Unauthorised reproduction infringes Crown copyright and may lead to prosecution or civil proceedings West Sussex County Council Licence No. 100018485



West Sussex County Council  
Highways & Transport  
The Grange  
Tower Street  
Chichester  
West Sussex  
PO19 1RH

MID SUSSEX DISTRICT: BURGESS HILL  
NO EXISTING WAITING RESTRICTIONS

TILE REF NO:  
TQ3019NWN  
SHEET ISSUE NO  
SHEET ACTIVE FROM -

N  
SCALE:  
1:1250  
at A3 size

Reproduced from or based upon 2022 Ordnance Survey mapping with permission of the Controller of HMSO (c) Crown Copyright reserved. Unauthorised reproduction infringes Crown copyright and may lead to prosecution or civil proceedings West Sussex County Council Licence No. 100018485

PAGE 2 OF 2: PROPOSED CHANGES TO RESTRICTIONS (CIRCLED)



West Sussex County Council  
 Highways & Transport  
 The Grange  
 Tower Street  
 Chichester  
 West Sussex  
 PO19 1RH

MID SUSSEX DISTRICT: BURGESS HILL  
 PROPOSED WAITING RESTRICTIONS (12.10.2022)

Reproduced from or based upon 2022 Ordnance Survey mapping with permission of the Controller of HMSO (c) Crown Copyright reserved. Unauthorised reproduction infringes Crown copyright and may lead to prosecution or civil proceedings West Sussex County Council Licence No. 100018485

TILE REF NO:  
 TQ3019NWN

SHEET ISSUE NO 1\_MDS9001  
 SHEET ACTIVE FROM - DD.MM.YYYY

N  
  
 SCALE:  
 1:1250  
 at A3 size

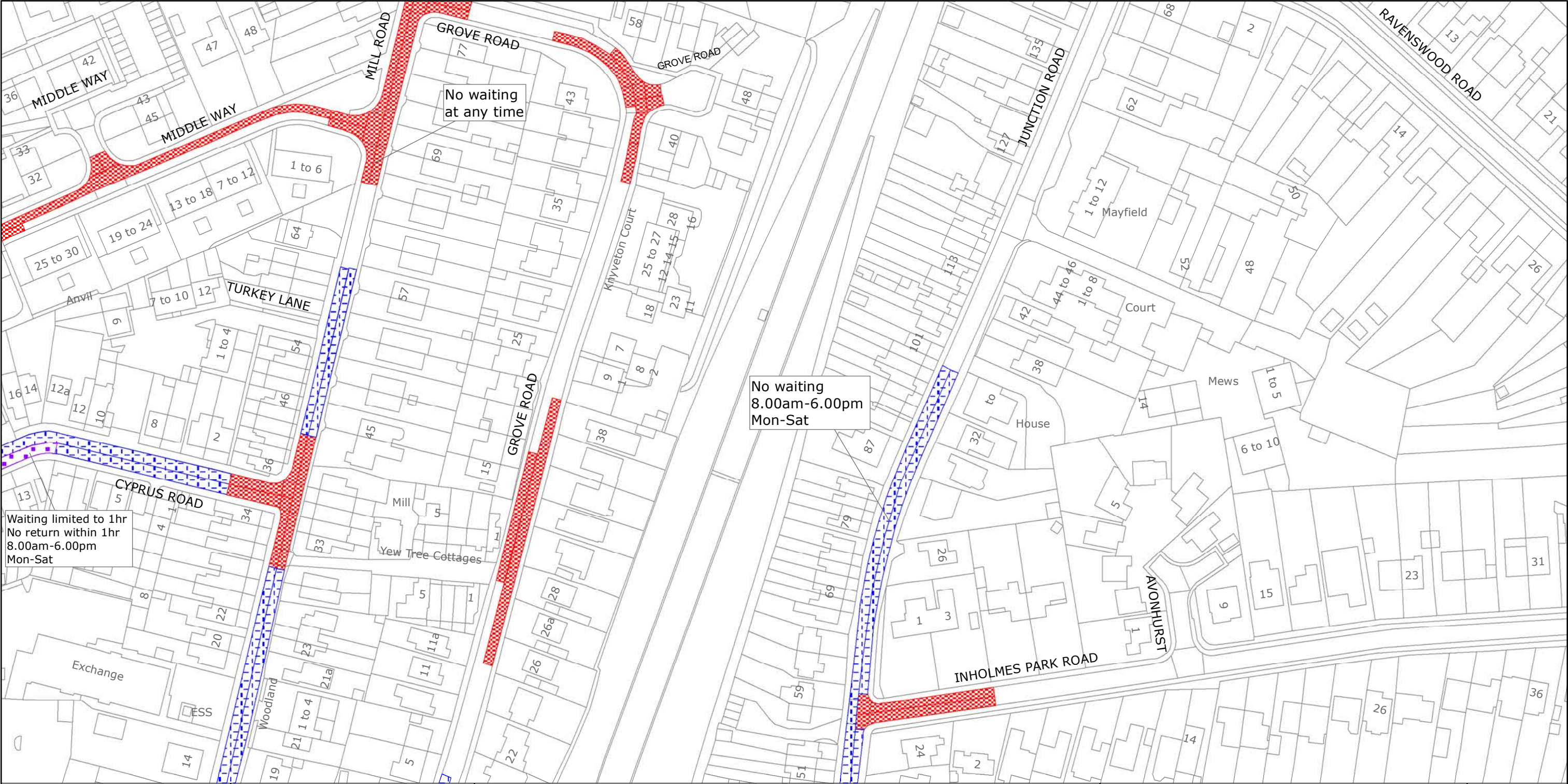

West Sussex County Council  
 Highways & Transport  
 The Grange  
 Tower Street  
 Chichester  
 West Sussex  
 PO19 1RH

MID SUSSEX DISTRICT: BURGESS HILL  
 WAITING RESTRICTIONS

Reproduced from or based upon 2020 Ordnance Survey mapping with permission of the Controller of HMSO (c) Crown Copyright reserved.  
 Unauthorised reproduction infringes Crown copyright and may lead to prosecution or civil proceedings West Sussex County Council Licence No. 100018485

TILE REF NO:  
**TQ3119SES**  
 SHEET ISSUE NO 5  
 SHEET ACTIVE FROM - 23/11/2020

N  
  
 SCALE:  
 1:1250  
 at A3 size

PAGE 2 OF 2: PROPOSED CHANGES TO RESTRICTIONS (CIRCLED)

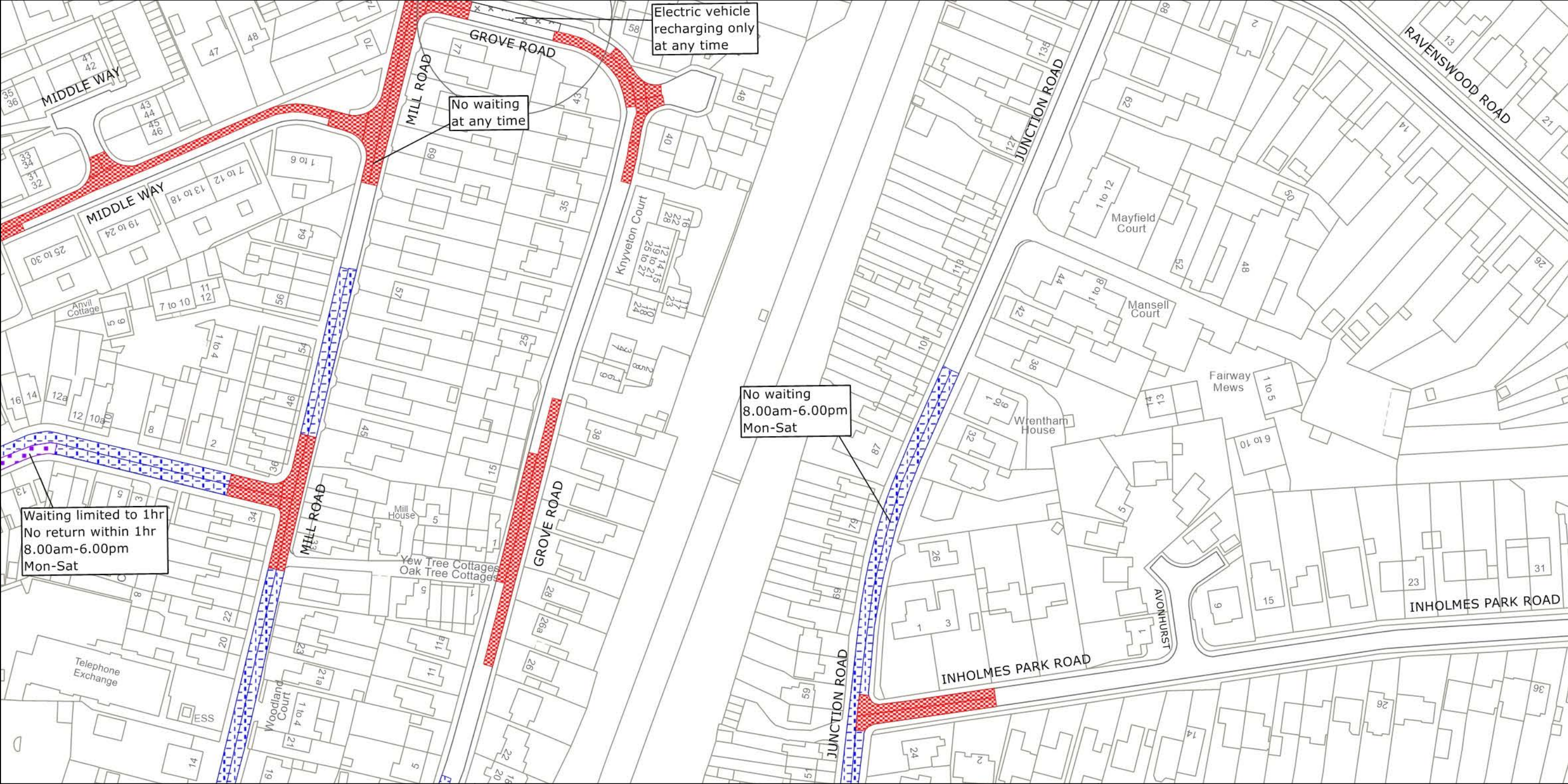

West Sussex County Council  
 Highways & Transport  
 The Grange  
 Tower Street  
 Chichester  
 West Sussex  
 PO19 1RH

MID SUSSEX DISTRICT: BURGESS HILL  
 PROPOSED WAITING RESTRICTIONS (12.10.2022)

TILE REF NO:  
 TQ3119SES  
 SHEET ISSUE NO 6\_MDS9001  
 SHEET ACTIVE FROM - DD.MM.YYYY

N  
  
 SCALE:  
 1:1250  
 at A3 size

Reproduced from or based upon 2022 Ordnance Survey mapping with permission of the Controller of HMSO (c) Crown Copyright reserved. Unauthorised reproduction infringes Crown copyright and may lead to prosecution or civil proceedings West Sussex County Council Licence No. 100018485

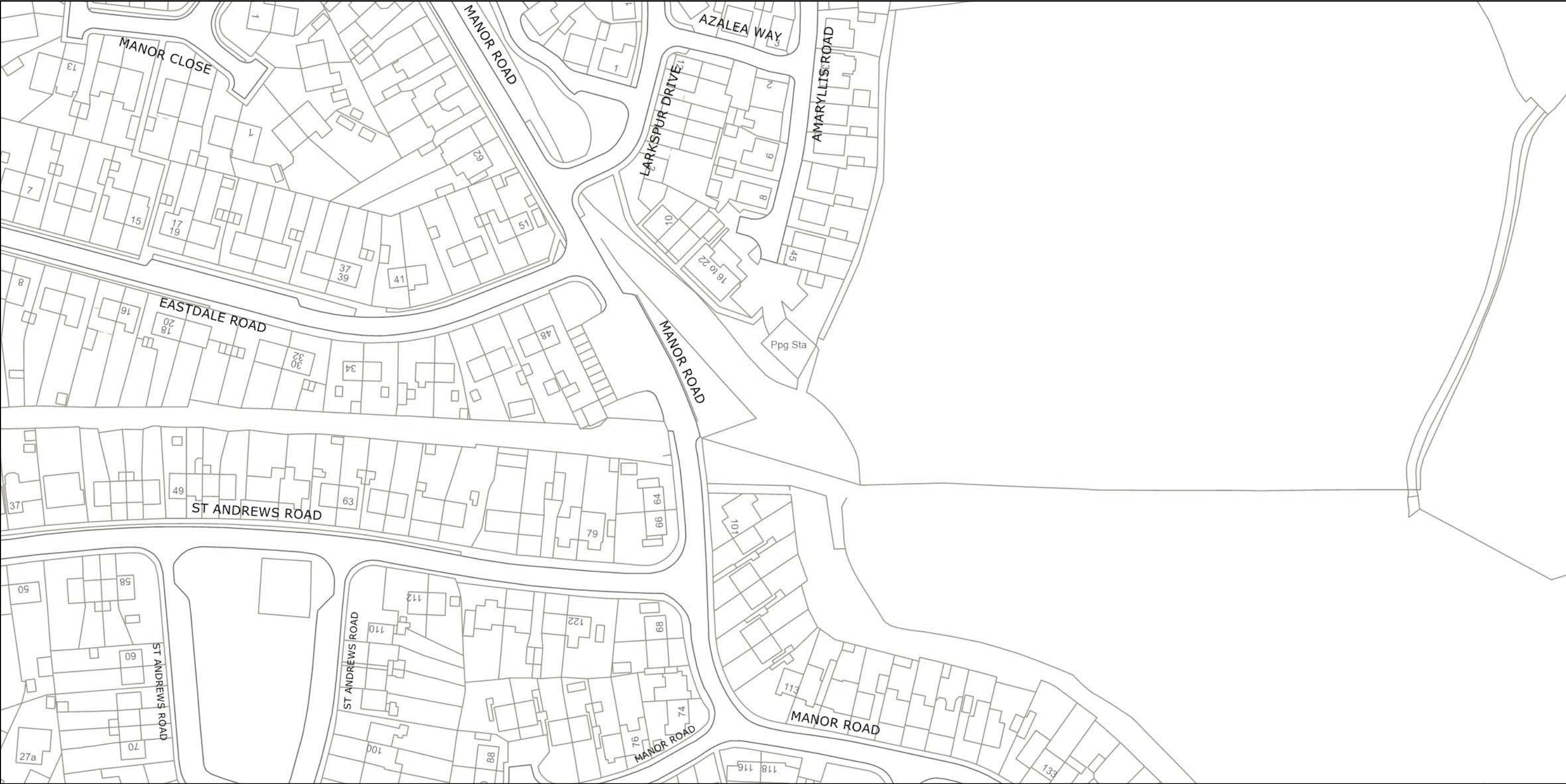

West Sussex County Council  
 Highways & Transport  
 The Grange  
 Tower Street  
 Chichester  
 West Sussex  
 PO19 1RH

MID SUSSEX DISTRICT: BURGESS HILL  
 NO EXISTING WAITING RESTRICTIONS

TILE REF NO:  
 TQ3219NES  
 SHEET ISSUE NO  
 SHEET ACTIVE FROM -

N  
  
 SCALE:  
 1:1250  
 at A3 size

Reproduced from or based upon 2022 Ordnance Survey mapping with permission of the Controller of HMSO (c) Crown Copyright reserved. Unauthorised reproduction infringes Crown copyright and may lead to prosecution or civil proceedings West Sussex County Council Licence No. 100018485

PAGE 2 OF 2: PROPOSED CHANGES TO RESTRICTIONS (CIRCLED)



West Sussex County Council  
 Highways & Transport  
 The Grange  
 Tower Street  
 Chichester  
 West Sussex  
 PO19 1RH

MID SUSSEX DISTRICT: BURGESS HILL  
 PROPOSED WAITING RESTRICTIONS (12.10.2022)

TILE REF NO:  
 TQ3219NES  
 SHEET ISSUE NO 1\_MDS9001  
 SHEET ACTIVE FROM - DD.MM.YYYY

N  
  
 SCALE:  
 1:1250  
 at A3 size

Reproduced from or based upon 2022 Ordnance Survey mapping with permission of the Controller of HMSO (c) Crown Copyright reserved. Unauthorised reproduction infringes Crown copyright and may lead to prosecution or civil proceedings West Sussex County Council Licence No. 100018485



PAGE 1 OF 2: EXISTING RESTRICTIONS ONLY

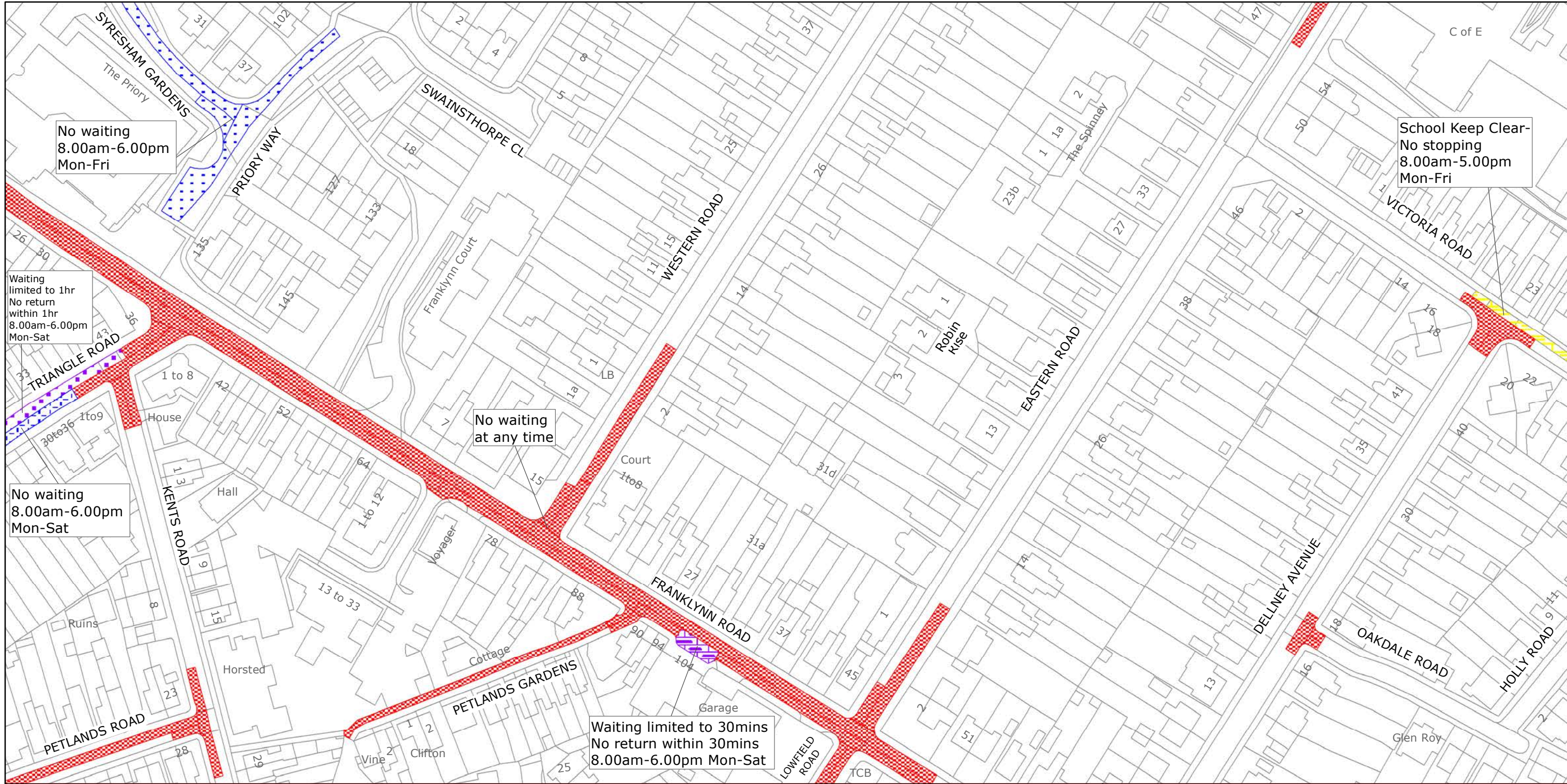

West Sussex County Council  
 Highways & Transport  
 The Grange  
 Tower Street  
 Chichester  
 West Sussex  
 PO19 1RH

MID SUSSEX DISTRICT: HAYWARDS HEATH  
 WAITING RESTRICTIONS

TILE REF NO:  
 TQ3323SEN

SHEET ISSUE NO 8  
 SHEET ACTIVE FROM - 01/12/2017



SCALE:  
 1:1250  
 at A3 size

Reproduced from or based upon 2017 Ordnance Survey mapping with permission of the Controller of HMSO (c) Crown Copyright reserved.  
 Unauthorised reproduction infringes Crown copyright and may lead to prosecution or civil proceedings West Sussex County Council Licence No. 100018485

PAGE 2 OF 2: PROPOSED CHANGES TO RESTRICTIONS (CIRCLED)

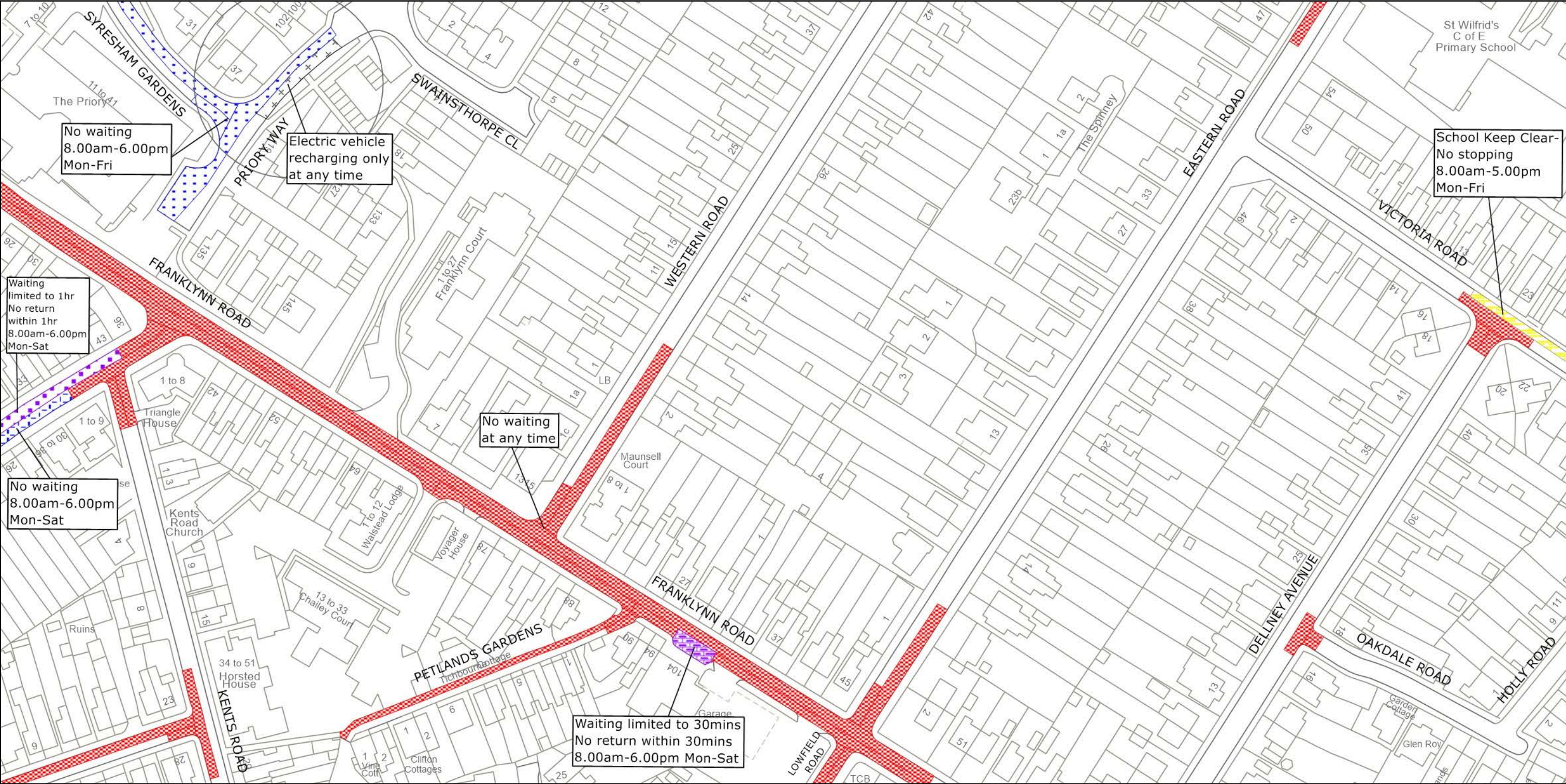

West Sussex County Council  
 Highways & Transport  
 The Grange  
 Tower Street  
 Chichester  
 West Sussex  
 PO19 1RH

MID SUSSEX DISTRICT: HAYWARDS HEATH  
 PROPOSED WAITING RESTRICTIONS (12.10.2022)

Reproduced from or based upon 2022 Ordnance Survey mapping with permission of the Controller of HMSO (c) Crown Copyright reserved. Unauthorised reproduction infringes Crown copyright and may lead to prosecution or civil proceedings West Sussex County Council Licence No. 100018485

TILE REF NO:  
**TQ3323SEN**

SHEET ISSUE NO 9\_MDS9001  
 SHEET ACTIVE FROM - DD.MM.YYYY

**N**  
  
 SCALE:  
 1:1250  
 at A3 size

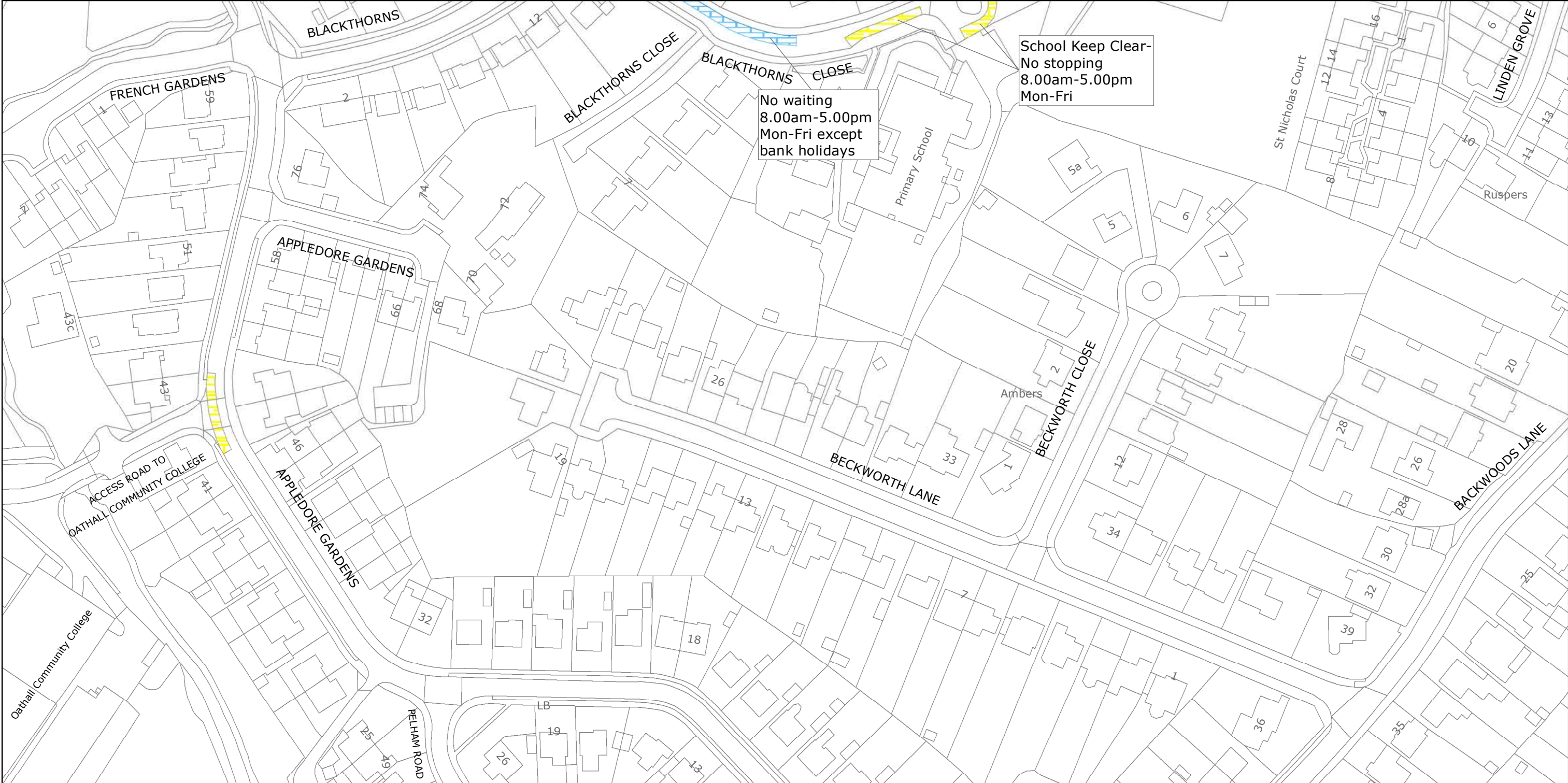

West Sussex County Council  
 Highways & Transport  
 The Grange  
 Tower Street  
 Chichester  
 West Sussex  
 PO19 1RH

MID SUSSEX DISTRICT: HAYWARDS HEATH  
 AND LINDFIELD  
 WAITING RESTRICTIONS

Reproduced from or based upon 2019 Ordnance Survey mapping with permission of the Controller of HMSO (c) Crown Copyright reserved.  
 Unauthorised reproduction infringes Crown copyright and may lead to prosecution or civil proceedings West Sussex County Council Licence No. 100018485

TILE REF NO:  
 TQ3424NWN

SHEET ISSUE NO 1  
 SHEET ACTIVE FROM - 30/09/2019



SCALE:  
 1:1250  
 at A3 size

PAGE 2 OF 2: PROPOSED CHANGES TO RESTRICTIONS (CIRCLED)

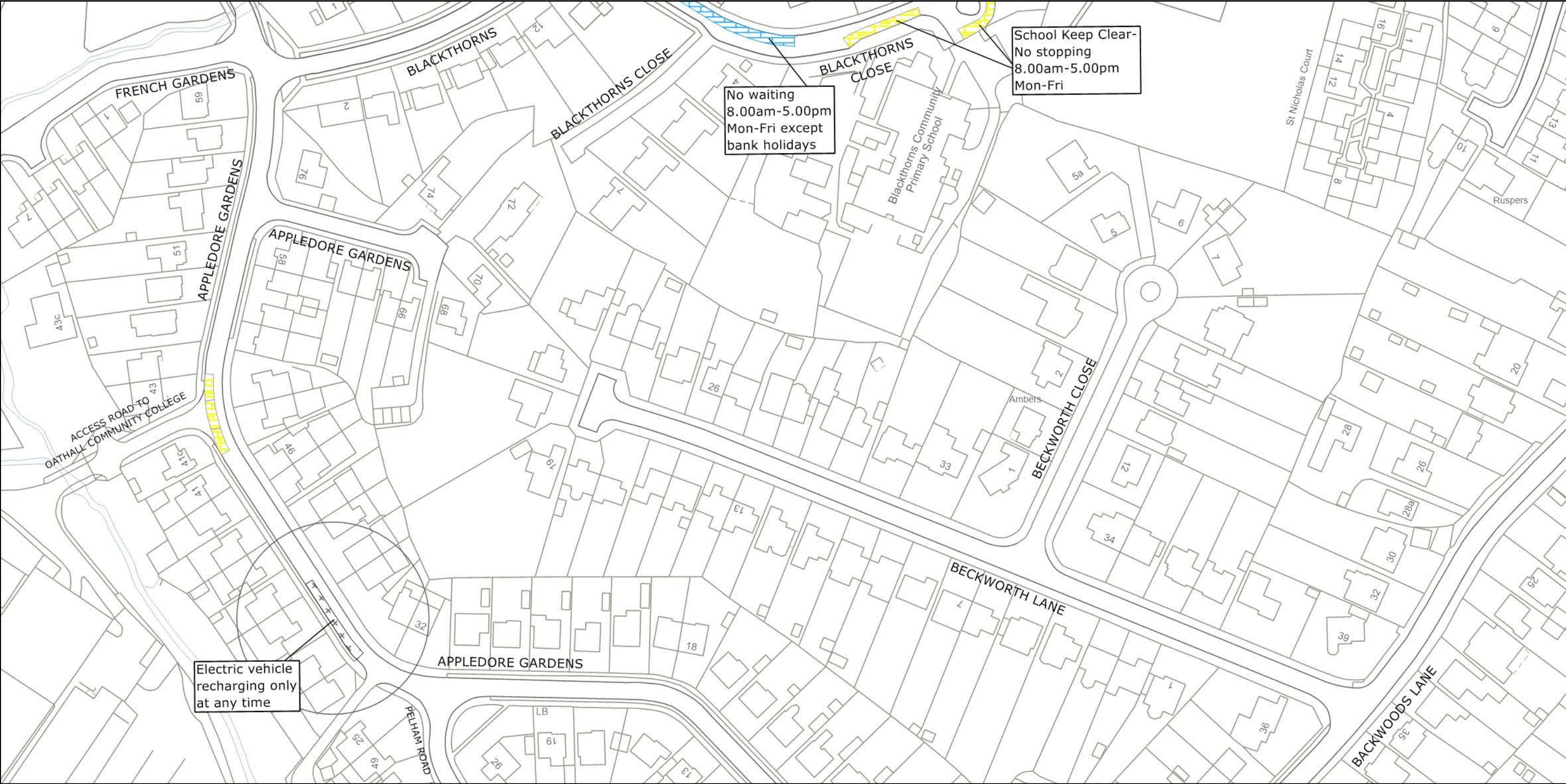

West Sussex County Council  
 Highways & Transport  
 The Grange  
 Tower Street  
 Chichester  
 West Sussex  
 PO19 1RH

MID SUSSEX DISTRICT: HAYWARDS HEATH AND LINDFIELD  
 PROPOSED WAITING RESTRICTIONS (12.10.2022)

TILE REF NO:  
**TQ3424NWN**  
 SHEET ISSUE NO 2\_MDS9001  
 SHEET ACTIVE FROM - DD.MM.YYYY

N  
  
 SCALE:  
 1:1250  
 at A3 size

Reproduced from or based upon 2022 Ordnance Survey mapping with permission of the Controller of HMSO (c) Crown Copyright reserved. Unauthorised reproduction infringes Crown copyright and may lead to prosecution or civil proceedings West Sussex County Council Licence No. 100018485

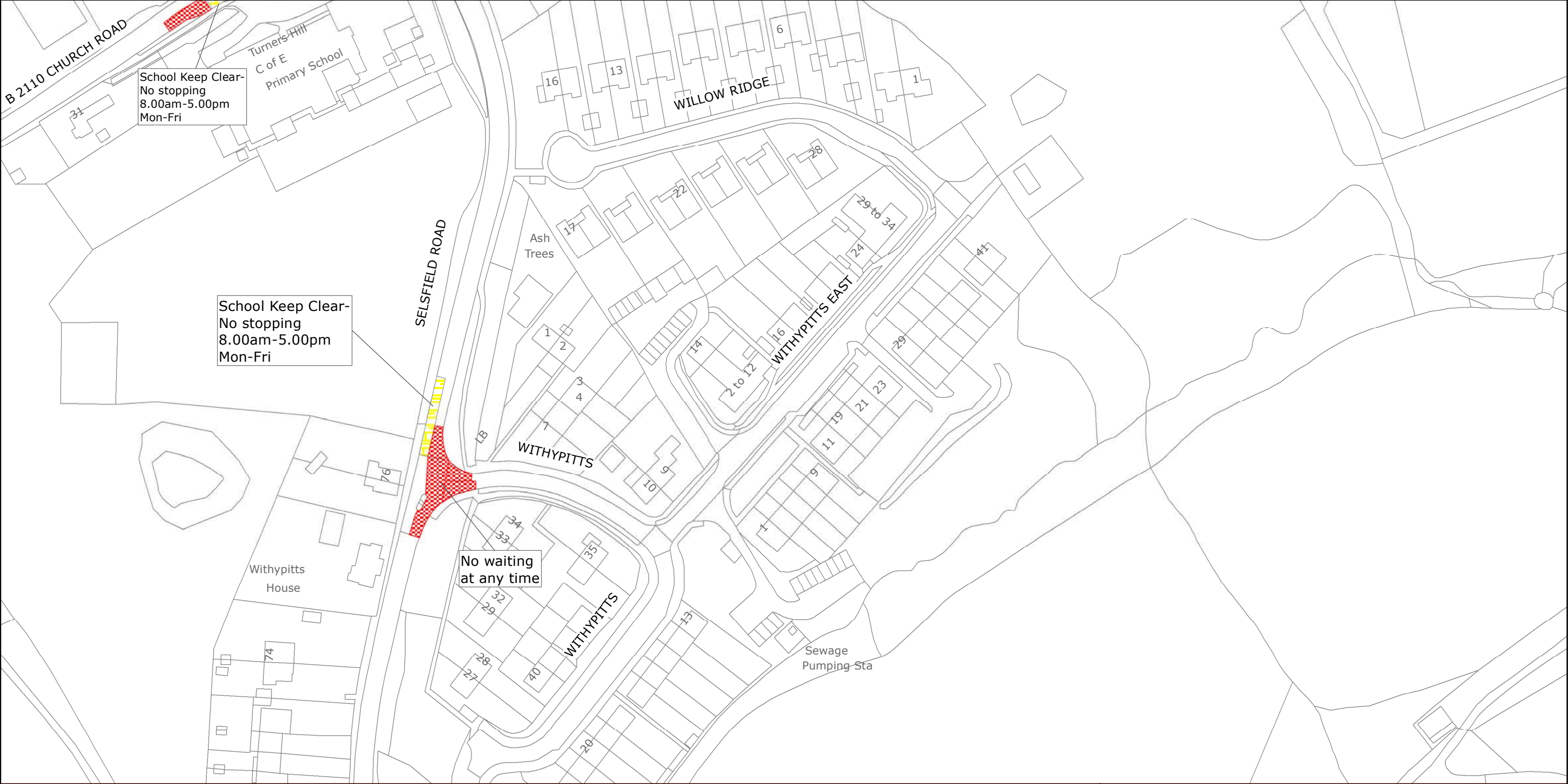

West Sussex County Council  
 Highways & Transport  
 The Grange  
 Tower Street  
 Chichester  
 West Sussex  
 PO19 1RH

MID SUSSEX DISTRICT: TURNERS HILL  
 WAITING RESTRICTIONS

TILE REF NO:  
**TQ3435SWN**  
 SHEET ISSUE NO 3  
 SHEET ACTIVE FROM - 01/12/2017

N  
  
 SCALE:  
 1:1250  
 at A3 size

Reproduced from or based upon 2017 Ordnance Survey mapping with permission of the Controller of HMSO (c) Crown Copyright reserved. Unauthorised reproduction infringes Crown copyright and may lead to prosecution or civil proceedings West Sussex County Council Licence No. 100018485

PAGE 2 OF 2: PROPOSED CHANGES TO RESTRICTIONS (CIRCLED)



West Sussex County Council  
 Highways & Transport  
 The Grange  
 Tower Street  
 Chichester  
 West Sussex  
 PO19 1RH

MID SUSSEX DISTRICT: TURNERS HILL  
 PROPOSED WAITING RESTRICTIONS (12.10.2022)

TILE REF NO:  
 TQ3435SWN  
 SHEET ISSUE NO 4\_MDS9001  
 SHEET ACTIVE FROM - DD.MM.YYYY

N  
  
 SCALE:  
 1:1250  
 at A3 size

Reproduced from or based upon 2022 Ordnance Survey mapping with permission of the Controller of HMSO (c) Crown Copyright reserved. Unauthorised reproduction infringes Crown copyright and may lead to prosecution or civil proceedings West Sussex County Council Licence No. 100018485