

TRAFFIC REGULATION ORDER (TRO) CONSULTATION
ADR9018MM – Adur: Electric Vehicle Charging Bays
17/11/22 – 8/12/22

Contents

Notice	Page 2
Statement of Reasons	Page 3
Draft Order	Page 5
Plan "c_adurtq1604nen" - existing restrictions	Page 7
Plan "c_adurtq1604nen" - proposals	Page 8
Plan "c_adurtq1605ses" - existing restrictions	Page 9
Plan "c_adurtq1605ses" - proposals	Page 10
Plan "c_adurtq1703nes" - existing restrictions	Page 11
Plan "c_adurtq1703nes" - proposals	Page 12
Plan "c_adurtq1705swn" - existing restrictions	Page 13
Plan "c_adurtq1705swn" - proposals	Page 14
Plan "c_adurtq1804swn" - existing restrictions	Page 15
Plan "c_adurtq1804swn" - proposals	Page 16
Plan "c_adurtq1805sen" - existing restrictions	Page 17
Plan "c_adurtq1805sen" - proposals	Page 18
Plan "c_adurtq2106sen" - existing restrictions	Page 19
Plan "c_adurtq2106sen" - proposals	Page 20
Plan "c_adurtq2204nwn" - existing restrictions	Page 21
Plan "c_adurtq2204nwn" - proposals	Page 22
Plan "c_adurtq2304nwn" - existing restrictions	Page 23
Plan "c_adurtq2304nwn" - proposals	Page 24
Plan "c_adurtq2406nws" - existing restrictions	Page 25
Plan "c_adurtq2406nws" - proposals	Page 26
Plan "c_adurtq2406sen" - existing restrictions	Page 27
Plan "c_adurtq2406sen" - proposals	Page 28

West Sussex County Council
((Adur District) (Parking Places & Traffic Regulation) (Consolidation) Order
2009)

(Various Roads: Electric Vehicle Charging Amendment) Order 2022

NOTICE is hereby given that West Sussex County Council proposes to make a permanent Traffic regulation Order under the provisions of the Road Traffic Regulation Act 1984, the effect of which will be to introduce parking bays for use only by electric vehicles being recharged at any time on the following roads in Adur District:

LANCING: Freshbrook Road (south side near the junction of Russels Drive), Hayley Road (east side near the junction of Lisher Road) Winston Road (east side near the junction of West End Way). SHOREHAM/SOUTHWICK: Cromleigh Way (north side, east of Overhill), Downsway (east side near junction of Edburton Gardens), Harbour Way (a; north side near junction of Emerald Quay & b; north side near junction of The Moorings), Highdown (north side near junction with Highdown Close). SOMPTING: Millfield (west side near the junction of Rectory Farm Road), Test Road (north side near Hamble Road junction), Whitestyles Road (east side between its junctions with Blacksmiths Road).

At each of these locations it is proposed to install on-street electric vehicle charging points. Each bay will accommodate six vehicles.

Full details of the proposals, including detailed plans showing the location of the proposed bays, can be viewed on the Traffic Regulation Order page of the West Sussex County Council website. The [website](#) includes a response form for any comments or objections.

People without access to a computer who wish to view details of the scheme should telephone the West Sussex County Council Contact Centre on 01243 642105 to receive the documents by post.

Any comments or objections about the proposal must be received before 8 December 2022. These may be submitted via the response form on the website mentioned above, by e-mail to tro.consultation@westsussex.gov.uk or in writing to TRO Team, West Sussex County Council, The Grange, Tower Street, Chichester, PO19 1RH. For legal reasons, only correspondence including a full name and address will be considered. Please quote reference ADR9018-MM in all correspondence.

Dated this 17th day of November 2022.
Director of Law & Assurance, County Hall, Chichester.

West Sussex County Council
((Adur District) (Parking Places & Traffic Regulation) (Consolidation)
Order 2009)

(Various Roads: Electric Vehicle Charging Amendment) Order 2022

Statement of Reasons for Proposing to Make the Order

West Sussex County Council proposes to make a permanent Traffic Regulation Order that will introduce parking bays for use only by electric vehicles being recharged at any time on the following roads in Adur District:

LANCING: Freshbrook Road (south side near the junction of Russels Drive), Hayley Road (east side near the junction of Lisher Road) Winston Road (east side near the junction of West End Way). SHOREHAM/SOUTHWICK: Cromleigh Way (north side, east of Overhill). Downsway (east side near junction of Edburton Gardens), Harbour Way (a; north side near junction of Emerald Quay & b; north side near junction of The Moorings), Highdown (north side near junction with Highdown Close). SOMPTING: Millfield (west side near the junction of Rectory Farm Road), Test Road (north side near Hamble Road junction), Whitestyles Road (east side between its junctions with Blacksmiths Road).

West Sussex County Council is committed to encouraging the use of electric vehicles and to providing charging facilities to make their use as convenient as possible. A partnership agreement has been entered into with Connected Kerb, who will meet the cost of installing and maintaining electric vehicle charging points in car parks and on-street locations across the county.

More information about the project and how the charge points will operate is available on the Electric Vehicle page of the West Sussex County Council website.

Following local consultation, the first charging points are proposed at locations where existing need has been identified. To ensure the charging points are not obstructed by parked petrol/diesel vehicles, or by electric vehicles which are not being charged, it is proposed to prohibit parking by any vehicle except an electric vehicle on charge at the locations of the new charging points.

The new order is therefore proposed to improve the amenities of the area through which the road runs.

The attached table lists the drawings showing the proposed restrictions and an index of the roads affected by the proposed order.

Director of Law & Assurance
18 October 2022
ADR9018-MM

Roads in Lancing	Drawing Number
Freshbrook Road	TQ1804SWN
Hayley Road	TQ1805SEN
Winston Road	TQ1703NES
Roads in Shoreham/Southwick	Drawing Number
Cromleigh Way	TQ2406NWS
Downsway	TQ2106SEN
Harbour Way	TQ2204NWN & TQ2304NWN
Highdown	TQ2406SEN
Roads in Sompting	Drawing Number
Millfield	TQ1705SWN
Test Road	TQ1604NEN
Whitestyles Road	TQ1605SES

WEST SUSSEX COUNTY COUNCIL
((ADUR DISTRICT) (PARKING PLACES & TRAFFIC REGULATION)
(CONSOLIDATION) ORDER 2009

(VARIOUS ROADS: ELECTRIC VEHICLE CHARGING AMENDMENT) ORDER 2022

West Sussex County Council in exercise of their powers under Sections 1 (a) 2 (1) and (2), 4 (2), 45, 46, 49 and 53 and Part IV of Schedule 9 of the Road Traffic Regulation Act 1984 ("the Act") as amended and of all other enabling powers and after consultation with the Chief Officer of Police in accordance with Part III of Schedule 9 to the Act hereby make the following Order:-

1. The Order shall come into operation on the **** day of ***** 2022 and may be cited as "West Sussex County Council ((Adur District) (Parking Places & Traffic Regulation) (Consolidation) Order 2009) (Electric Vehicle Charging Amendment) Order Order 2022".
2. The West Sussex County Council (Adur District) (Parking Places & Traffic Regulation) (Consolidation) Order 2009 is hereby amended by inserting into Article 3.1 the term of interpretation specified in the First Schedule to This Order.
3. The West Sussex County Council (Adur District) (Parking Places & Traffic Regulation) (Consolidation) Order 2009 is hereby amended by the deletion of the plans specified in the Second Schedule to this Order, and their replacement by the plans specified in the Third Schedule to this Order, attached hereto.
4. The West Sussex County Council (Adur District) (Parking Places & Traffic Regulation) (Consolidation) Order 2009 is hereby amended by the insertion of the plans specified in the Fourth Schedule to this Order, attached hereto.

FIRST SCHEDULE
Additional Terms of Interpretation

"Electric Vehicle Recharging" means an electrically powered vehicle attached to and receiving electric charge from a public electric vehicle charging point installed and operated by West Sussex County Council or their authorised service provider.

SECOND SCHEDULE
Plans to be Deleted

TQ1604NEN (Issue Number 1)
TQ1605SES (Issue Number 2)
TQ1703NES (Issue Number 4)
TQ1705SWN (Issue Number 1)
TQ1804SWN (Issue Number 4)
TQ1805SEN (Issue Number 1)
TQ2204NWN (Issue Number 2)

TQ2304NWN (Issue Number 1)

THIRD SCHEDULE
Replacement Plans

TQ1604NEN (Issue Number 2)
TQ1605SES (Issue Number 3)
TQ1703NES (Issue Number 5)
TQ1705SWN (Issue Number 2)
TQ1804SWN (Issue Number 5)
TQ1805SEN (Issue Number 2)
TQ2204NWN (Issue Number 3)
TQ2304NWN (Issue Number 2)

FOURTH SCHEDULE
Plans to be Inserted

TQ2106SEN (Issue Number 1)
TQ2406SEN (Issue Number 1)
TQ2406NWS (Issue Number 1)

For and on behalf of WEST SUSSEX COUNTY COUNCIL

Authorised Signatory:

NAME:

DATE MADE:

ADR9018-MM

PAGE 1 OF 2: EXISTING RESTRICTIONS ONLY

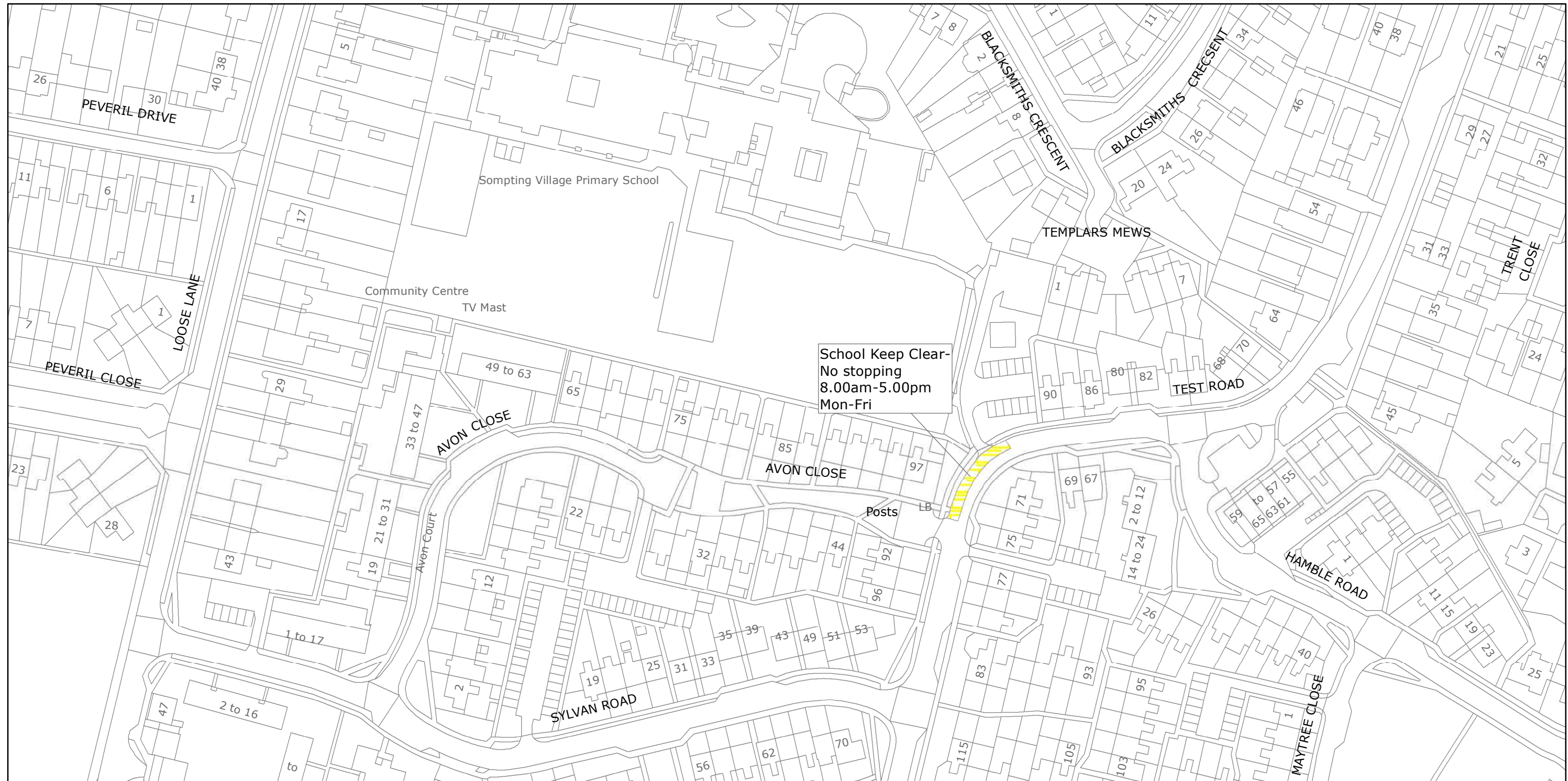

West Sussex County Council
 Highways & Transport
 The Grange
 Tower Street
 Chichester
 West Sussex
 PO19 1RH

ADUR DISTRICT: SOMPTING
 WAITING RESTRICTIONS

TILE REF NO:
 TQ1604NEN

SHEET ISSUE NO 1
 SHEET ACTIVE FROM - 12/03/2020



SCALE:
 1:1250
 at A3 size

Reproduced from or based upon 2020 Ordnance Survey mapping with permission of the Controller of HMSO (c) Crown Copyright reserved.
 Unauthorised reproduction infringes Crown copyright and may lead to prosecution or civil proceedings West Sussex County Council Licence No. 100018485

PAGE 2 OF 2: PROPOSED CHANGES TO RESTRICTIONS (CIRCLED)

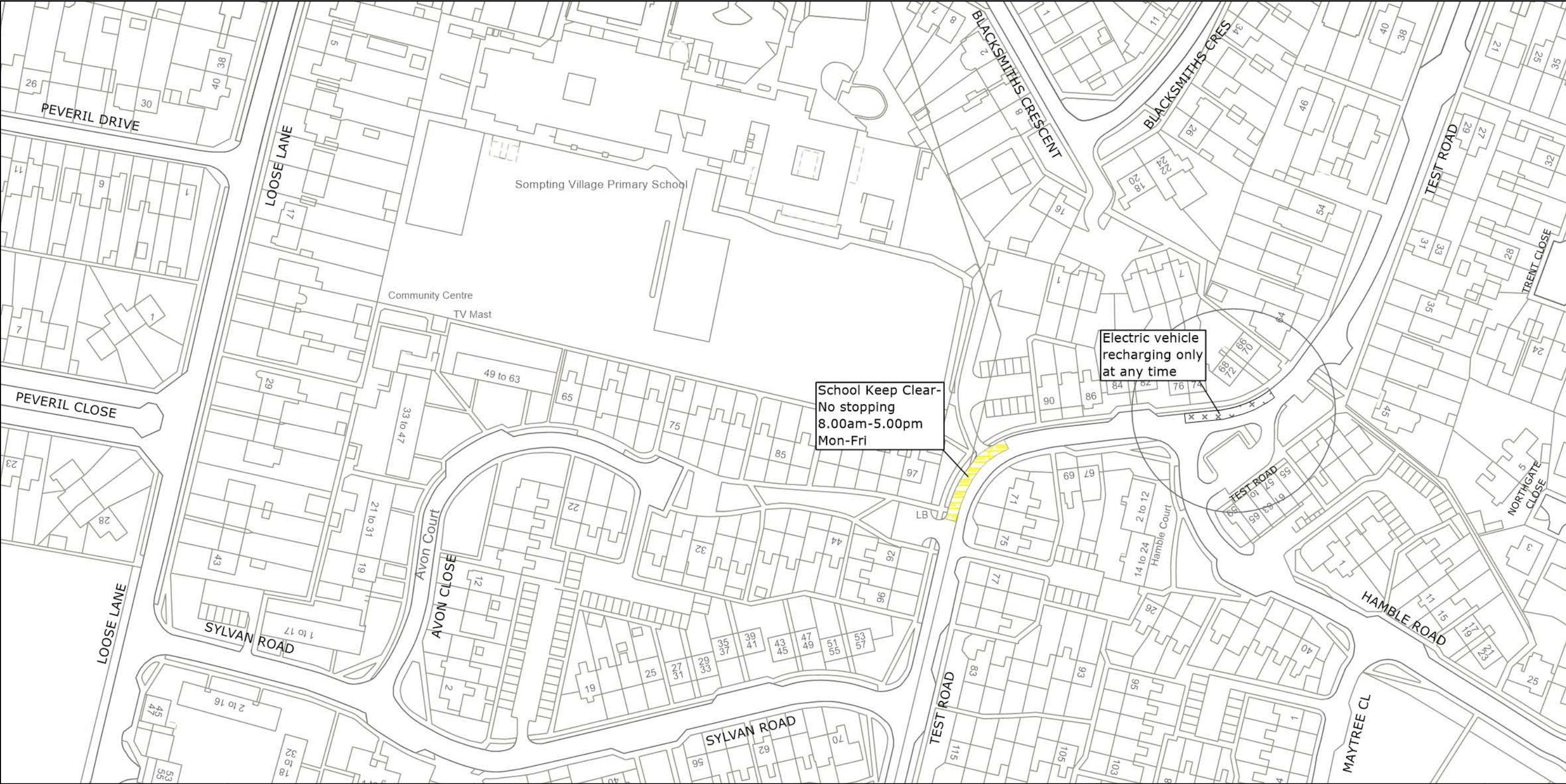

West Sussex County Council
 Highways & Transport
 The Grange
 Tower Street
 Chichester
 West Sussex
 PO19 1RH

ADUR DISTRICT: SOMPTING
 PROPOSED WAITING RESTRICTIONS (12.10.2022)

TILE REF NO:
 TQ1604NEN
 SHEET ISSUE NO 2_ADR9018
 SHEET ACTIVE FROM - DD.MM.YYYY

N

 SCALE:
 1:1250
 at A3 size

Reproduced from or based upon 2022 Ordnance Survey mapping with permission of the Controller of HMSO (c) Crown Copyright reserved. Unauthorised reproduction infringes Crown copyright and may lead to prosecution or civil proceedings West Sussex County Council Licence No. 100018485

PAGE 1 OF 2: EXISTING RESTRICTIONS ONLY

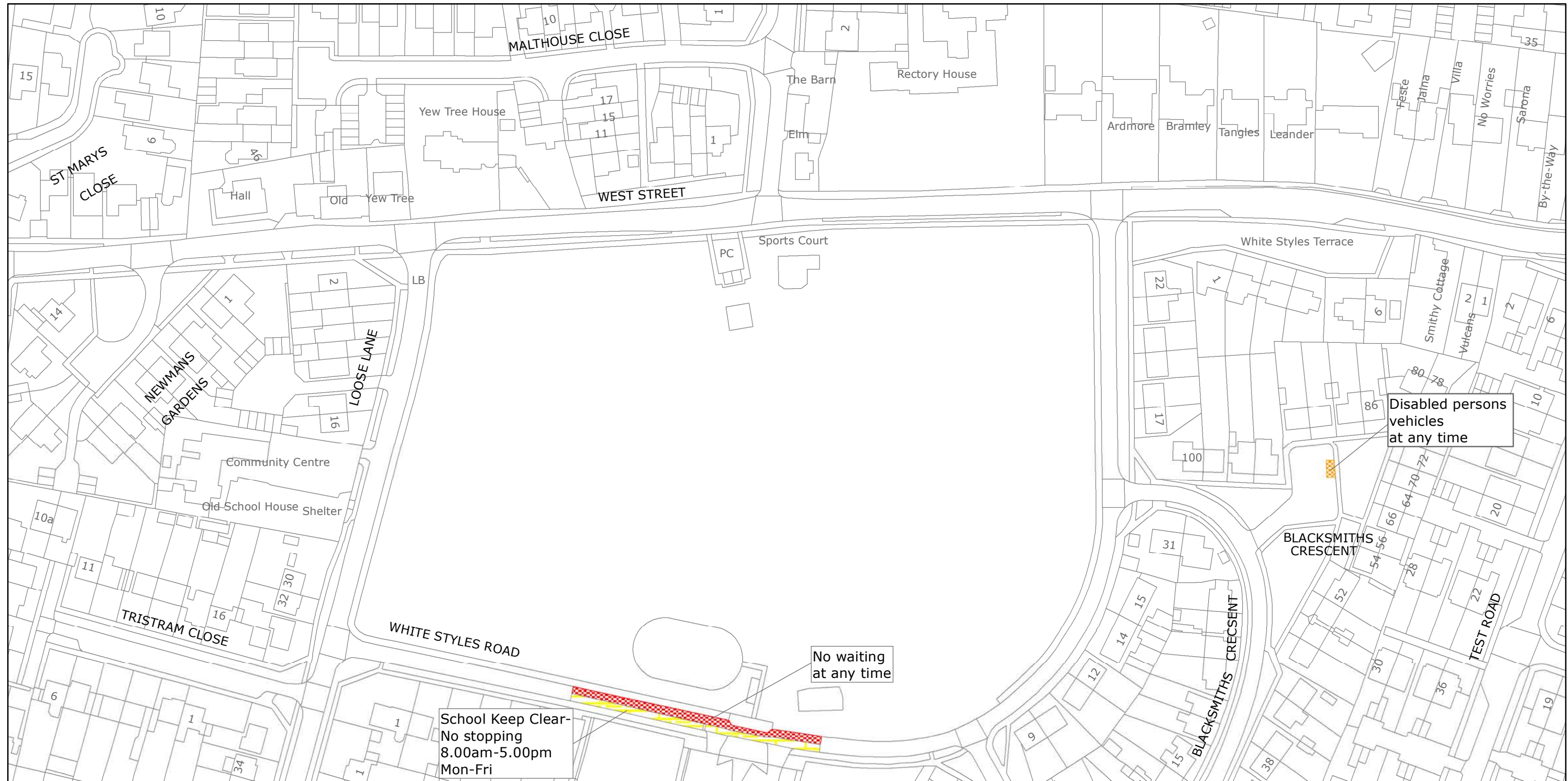

West Sussex County Council
 Highways & Transport
 The Grange
 Tower Street
 Chichester
 West Sussex
 PO19 1RH

ADUR DISTRICT: SOMPTING
 WAITING RESTRICTIONS

Reproduced from or based upon 2020 Ordnance Survey mapping with permission of the Controller of HMSO (c) Crown Copyright reserved.
 Unauthorised reproduction infringes Crown copyright and may lead to prosecution or civil proceedings West Sussex County Council Licence No. 100018485

TILE REF NO:
 TQ1605SES

SHEET ISSUE NO 2
 SHEET ACTIVE FROM - 12/03/2020



SCALE:
 1:1250
 at A3 size

PAGE 2 OF 2: PROPOSED CHANGES TO RESTRICTIONS (CIRCLED)

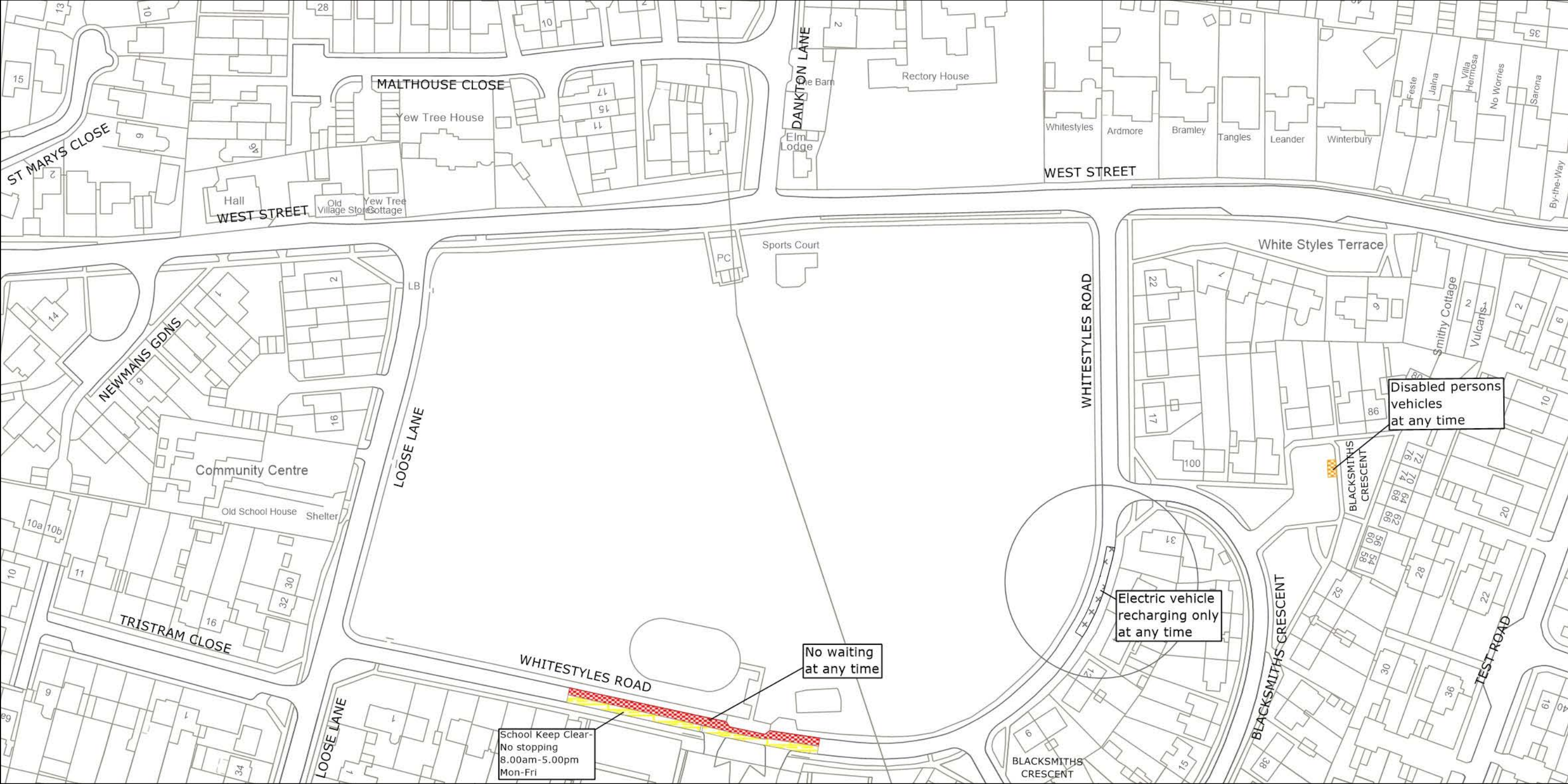

West Sussex County Council
 Highways & Transport
 The Grange
 Tower Street
 Chichester
 West Sussex
 PO19 1RH

ADUR DISTRICT: SOMPTING
 PROPOSED WAITING RESTRICTIONS (12.10.2022)

TILE REF NO:
 TQ1605SES
 SHEET ISSUE NO 3_ADR9018
 SHEET ACTIVE FROM - DD.MM.YYYY

N
 SCALE:
 1:1250
 at A3 size

Reproduced from or based upon 2022 Ordnance Survey mapping with permission of the Controller of HMSO (c) Crown Copyright reserved. Unauthorised reproduction infringes Crown copyright and may lead to prosecution or civil proceedings West Sussex County Council Licence No. 100018485

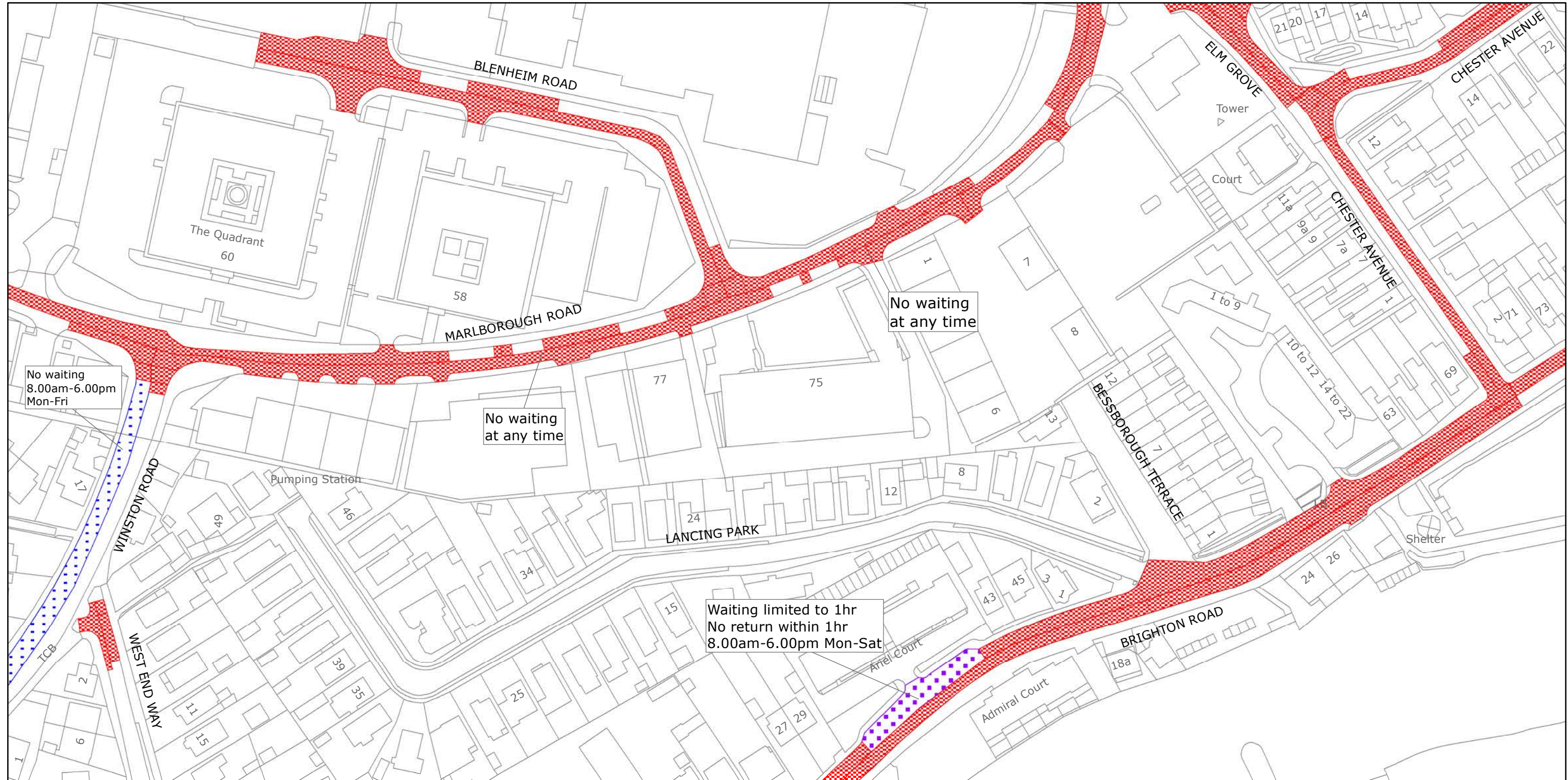

West Sussex County Council
Highways & Transport
The Grange
Tower Street
Chichester
West Sussex
PO19 1RH

ADUR DISTRICT: LANCING
WAITING RESTRICTIONS

Reproduced from or based upon 2022 Ordnance Survey mapping with permission of the Controller of HMSO (c) Crown Copyright reserved.
Unauthorised reproduction infringes Crown copyright and may lead to prosecution or civil proceedings West Sussex County Council Licence No. 100018485

TILE REF NO:
TQ1703NES

SHEET ISSUE NO 4
SHEET ACTIVE FROM - 06.06.2022



SCALE:
1:1250
at A3 size

PAGE 2 OF 2: PROPOSED CHANGES TO RESTRICTIONS (CIRCLED)

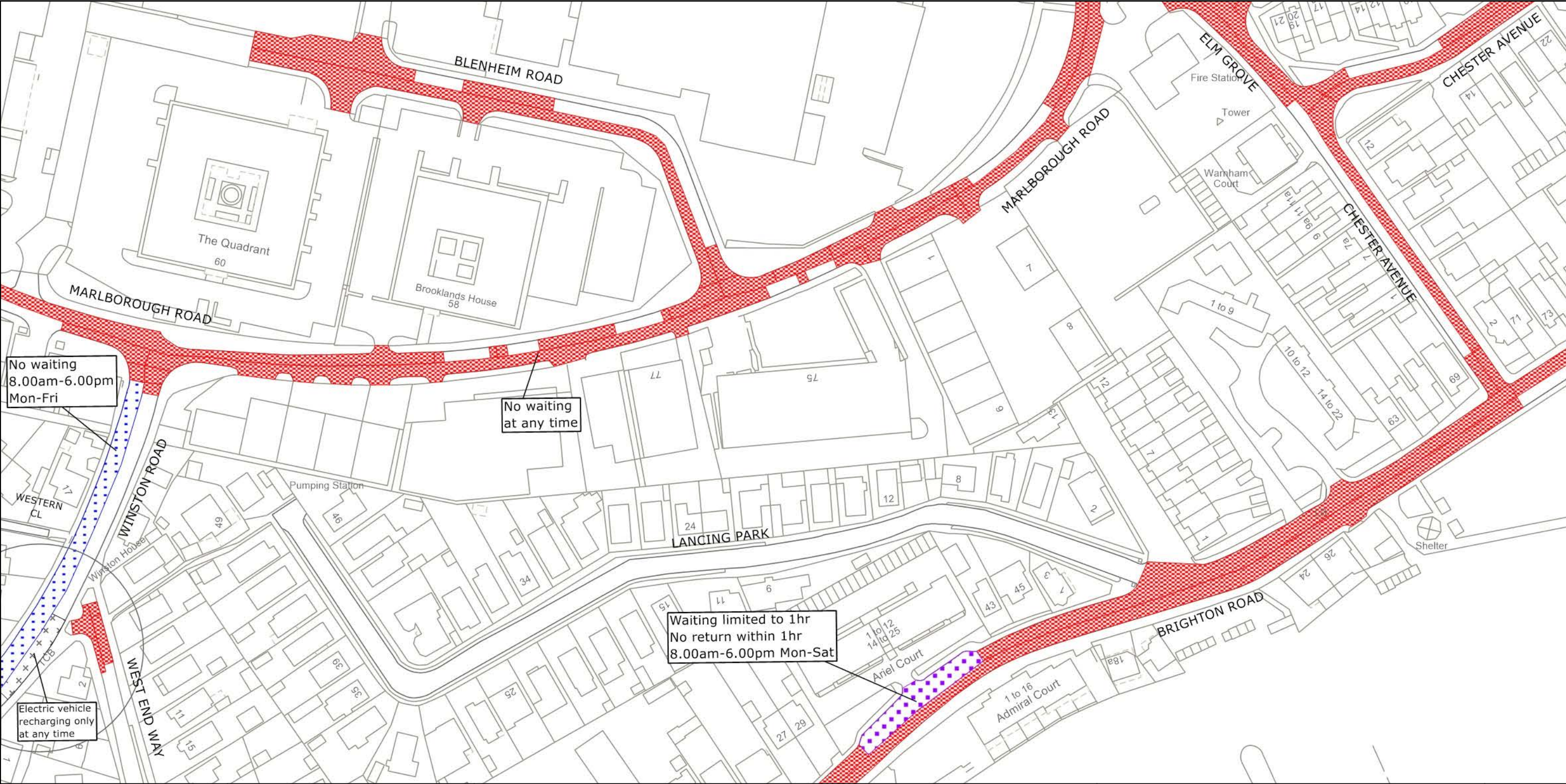

West Sussex County Council
 Highways & Transport
 The Grange
 Tower Street
 Chichester
 West Sussex
 PO19 1RH

ADUR DISTRICT: LANCING
 PROPOSED WAITING RESTRICTIONS (12.10.2022)

TILE REF NO:
 TQ1703NES
 SHEET ISSUE NO 5_ADR9018
 SHEET ACTIVE FROM - DD.MM.YYYY

N

 SCALE:
 1:1250
 at A3 size

Reproduced from or based upon 2022 Ordnance Survey mapping with permission of the Controller of HMSO (c) Crown Copyright reserved. Unauthorised reproduction infringes Crown copyright and may lead to prosecution or civil proceedings West Sussex County Council Licence No. 100018485

PAGE 1 OF 2: EXISTING RESTRICTIONS ONLY

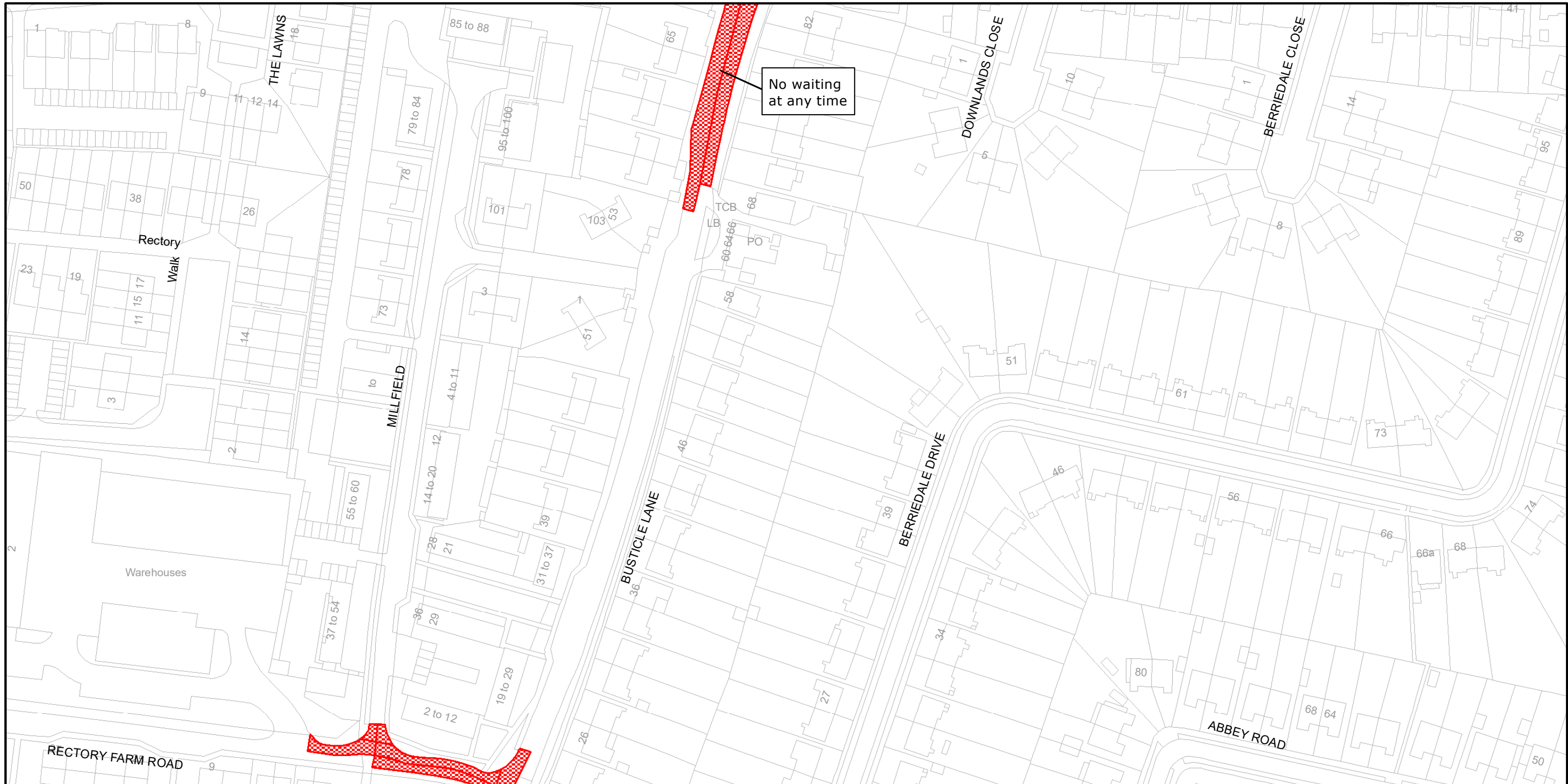

No waiting
at any time



West Sussex County Council
Infrastructure
The Grange
Tower Street
Chichester
West Sussex
PO19 1RH

ADUR DISTRICT: SOMPTING
WAITING RESTRICTIONS

TILE REF NO:
TQ1705SWN

SHEET NO 1

SHEET ACTIVE FROM - 05/03/2009



SCALE:
1:1250
at A3 size

Reproduced from or based upon 2008 Ordnance Survey mapping with permission of the Controller of HMSO (c) Crown Copyright reserved.
Unauthorised reproduction infringes Crown copyright and may lead to prosecution or civil proceedings West Sussex County Council Licence No. 100023447

PAGE 2 OF 2: PROPOSED CHANGES TO RESTRICTIONS (CIRCLED)



West Sussex County Council
 Highways & Transport
 The Grange
 Tower Street
 Chichester
 West Sussex
 PO19 1RH

ADUR DISTRICT: SOMPTING
 PROPOSED WAITING RESTRICTIONS (12.10.2022)

TILE REF NO:
 TQ1705SWN
 SHEET ISSUE NO 2_ADR9018
 SHEET ACTIVE FROM - DD.MM.YYYY

N

 SCALE:
 1:1250
 at A3 size

Reproduced from or based upon 2022 Ordnance Survey mapping with permission of the Controller of HMSO (c) Crown Copyright reserved. Unauthorised reproduction infringes Crown copyright and may lead to prosecution or civil proceedings West Sussex County Council Licence No. 100018485

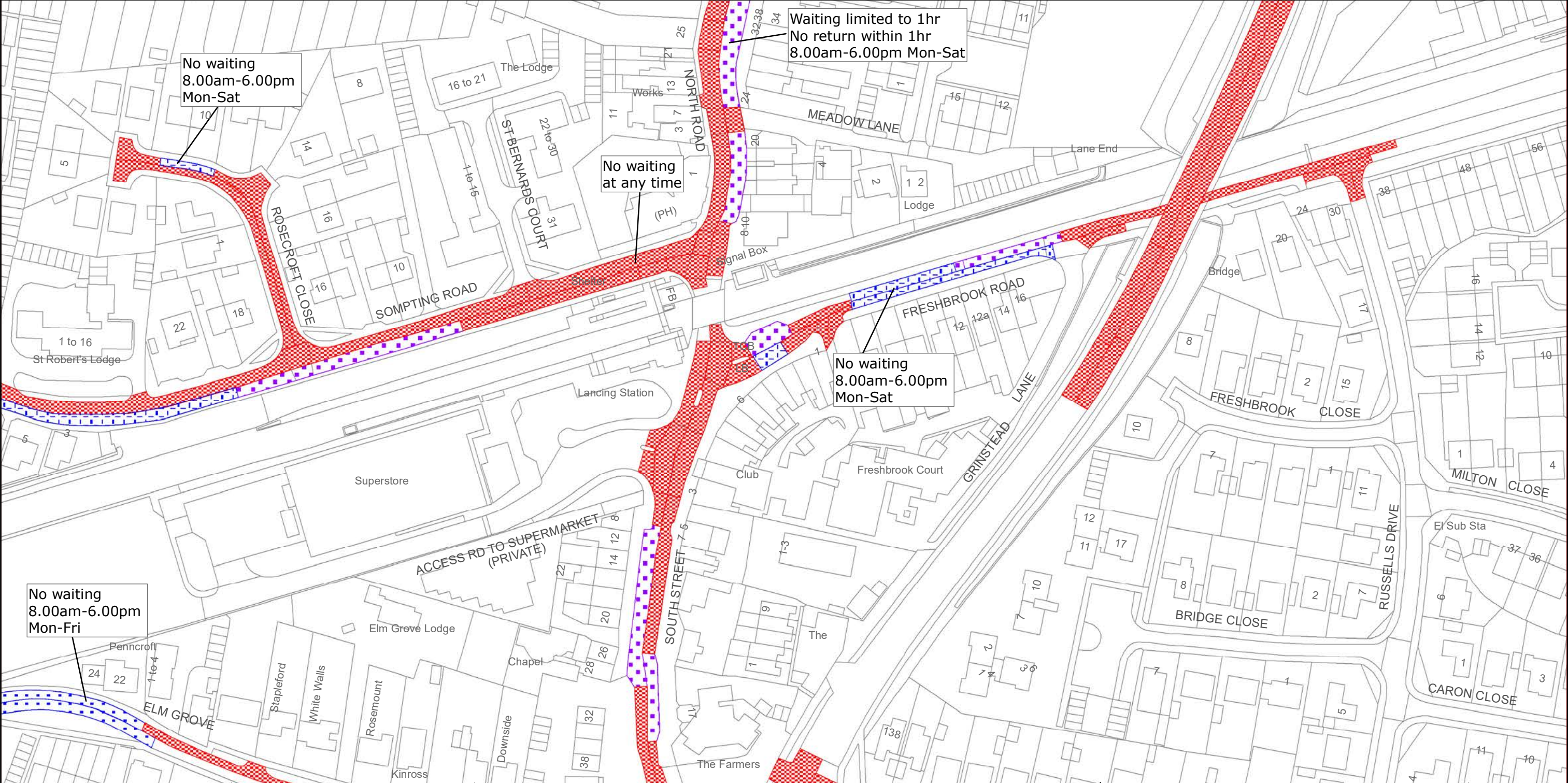

No waiting
8.00am-6.00pm
Mon-Fri

No waiting
8.00am-6.00pm
Mon-Sat

No waiting
at any time

Waiting limited to 1hr
No return within 1hr
8.00am-6.00pm Mon-Sat

No waiting
8.00am-6.00pm
Mon-Sat



West Sussex County Council
Highways & Transport
The Grange
Tower Street
Chichester
West Sussex
PO19 1RH

ADUR DISTRICT: LANCING
WAITING RESTRICTIONS

Reproduced from or based upon 2010 Ordnance Survey mapping with permission of the Controller of HMSO (c) Crown Copyright reserved. Unauthorised reproduction infringes Crown copyright and may lead to prosecution or civil proceedings West Sussex County Council Licence No. 100018485

TILE REF NO:
TQ1804SWN

SHEET ISSUE NO 4
SHEET ACTIVE FROM - 02/12/2013

N
SCALE:
1:1250
at A3 size

PAGE 2 OF 2: PROPOSED CHANGES TO RESTRICTIONS (CIRCLED)

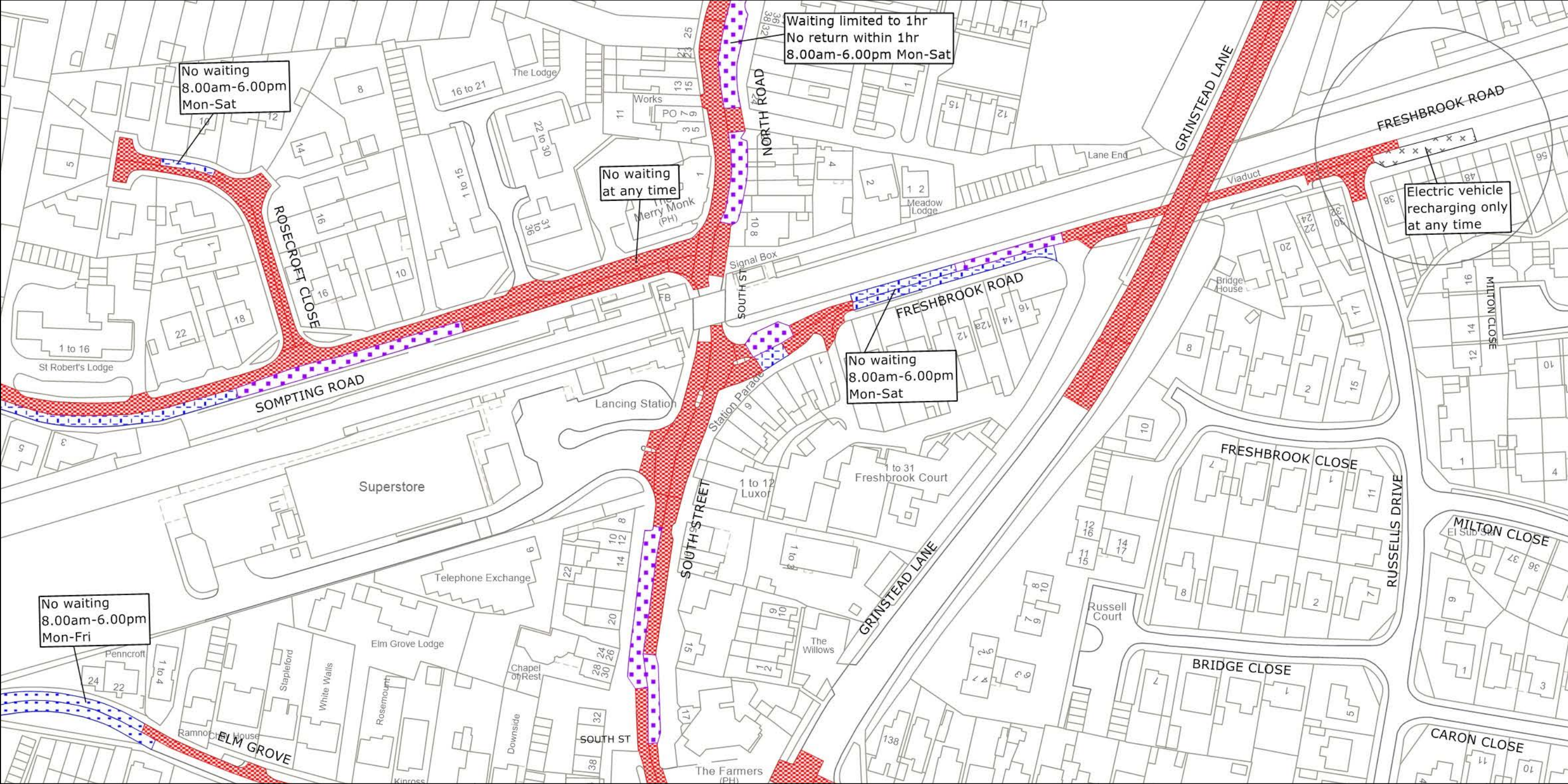

West Sussex County Council
 Highways & Transport
 The Grange
 Tower Street
 Chichester
 West Sussex
 PO19 1RH

ADUR DISTRICT: LANCING
 PROPOSED WAITING RESTRICTIONS (12.10.2022)

TILE REF NO:
 TQ1804SWN
 SHEET ISSUE NO 5_ADR9018
 SHEET ACTIVE FROM - DD.MM.YYYY

N

 SCALE:
 1:1250
 at A3 size

Reproduced from or based upon 2022 Ordnance Survey mapping with permission of the Controller of HMSO (c) Crown Copyright reserved. Unauthorised reproduction infringes Crown copyright and may lead to prosecution or civil proceedings West Sussex County Council Licence No. 100018485

PAGE 1 OF 2: EXISTING RESTRICTIONS ONLY



West Sussex County Council
Highways & Transport
The Grange
Tower Street
Chichester
West Sussex
PO19 1RH

ADUR DISTRICT: LANCING
WAITING RESTRICTIONS

TILE REF NO:
TQ1805SEN

SHEET ISSUE NO 1
SHEET ACTIVE FROM -30/03/2015



SCALE:
1:1250
at A3 size

Reproduced from or based upon 2013 Ordnance Survey material with permission of the Controller of HMSO (c) Crown Copyright reserved.
Unauthorised reproduction infringes Crown copyright and may lead to prosecution or civil proceedings West Sussex County Council Licence No. 100023447

PAGE 2 OF 2: PROPOSED CHANGES TO RESTRICTIONS (CIRCLED)



West Sussex County Council
 Highways & Transport
 The Grange
 Tower Street
 Chichester
 West Sussex
 PO19 1RH

ADUR DISTRICT: LANCING
 PROPOSED WAITING RESTRICTIONS (12.10.2022)

TILE REF NO:
 TQ1805SEN
 SHEET ISSUE NO 2_ADR9018
 SHEET ACTIVE FROM - DD.MM.YYYY

N

 SCALE:
 1:1250
 at A3 size

Reproduced from or based upon 2022 Ordnance Survey mapping with permission of the Controller of HMSO (c) Crown Copyright reserved. Unauthorised reproduction infringes Crown copyright and may lead to prosecution or civil proceedings West Sussex County Council Licence No. 100018485

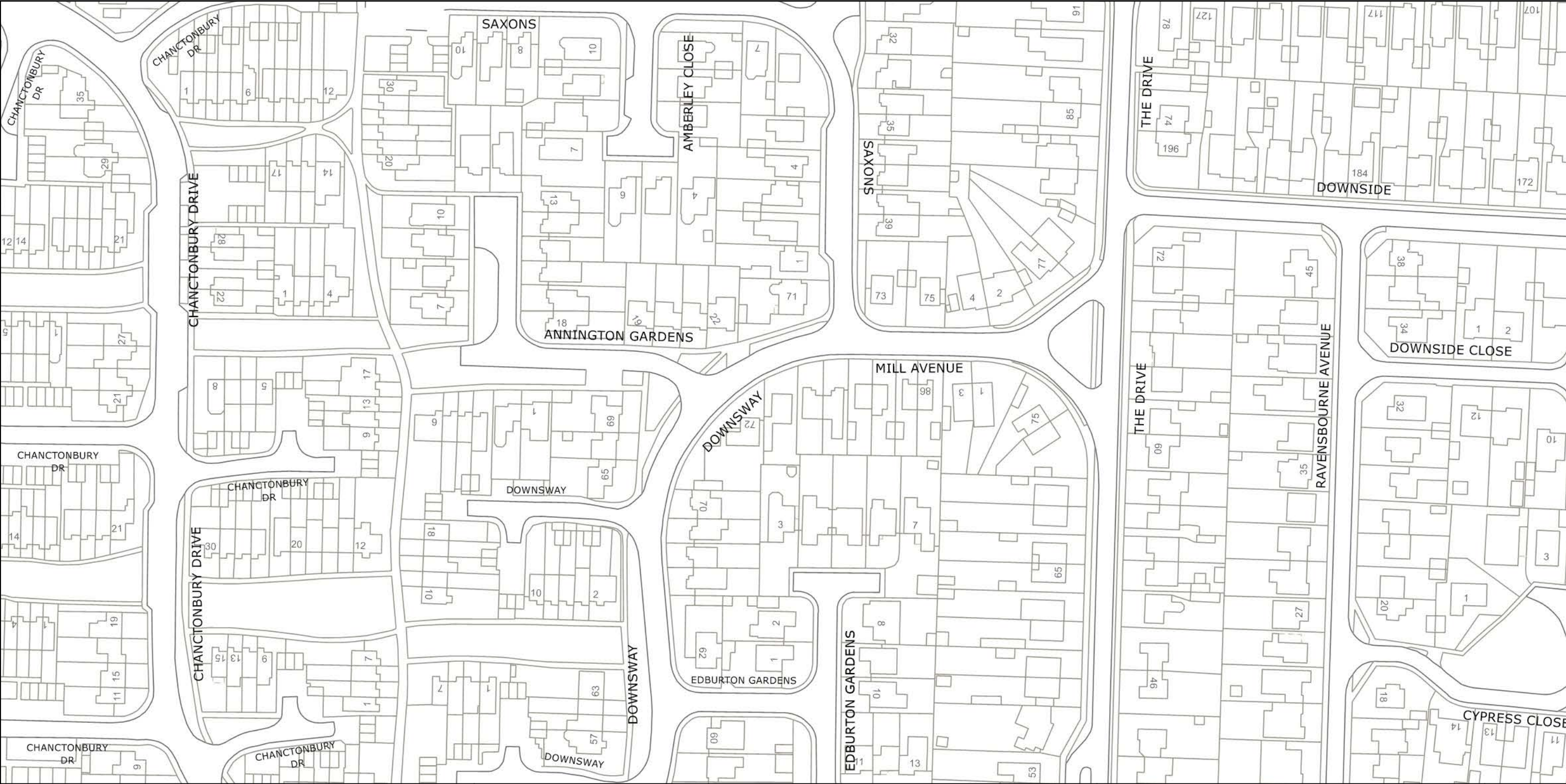

West Sussex County Council
 Highways & Transport
 The Grange
 Tower Street
 Chichester
 West Sussex
 PO19 1RH

ADUR DISTRICT: SHOREHAM/SOUTHWICK
 NO EXISTING WAITING RESTRICTIONS

TILE REF NO:
 TQ2106SEN
 SHEET ISSUE NO
 SHEET ACTIVE FROM -

N

 SCALE:
 1:1250
 at A3 size

Reproduced from or based upon 2022 Ordnance Survey mapping with permission of the Controller of HMSO (c) Crown Copyright reserved. Unauthorised reproduction infringes Crown copyright and may lead to prosecution or civil proceedings West Sussex County Council Licence No. 100018485

PAGE 2 OF 2: PROPOSED CHANGES TO RESTRICTIONS (CIRCLED)

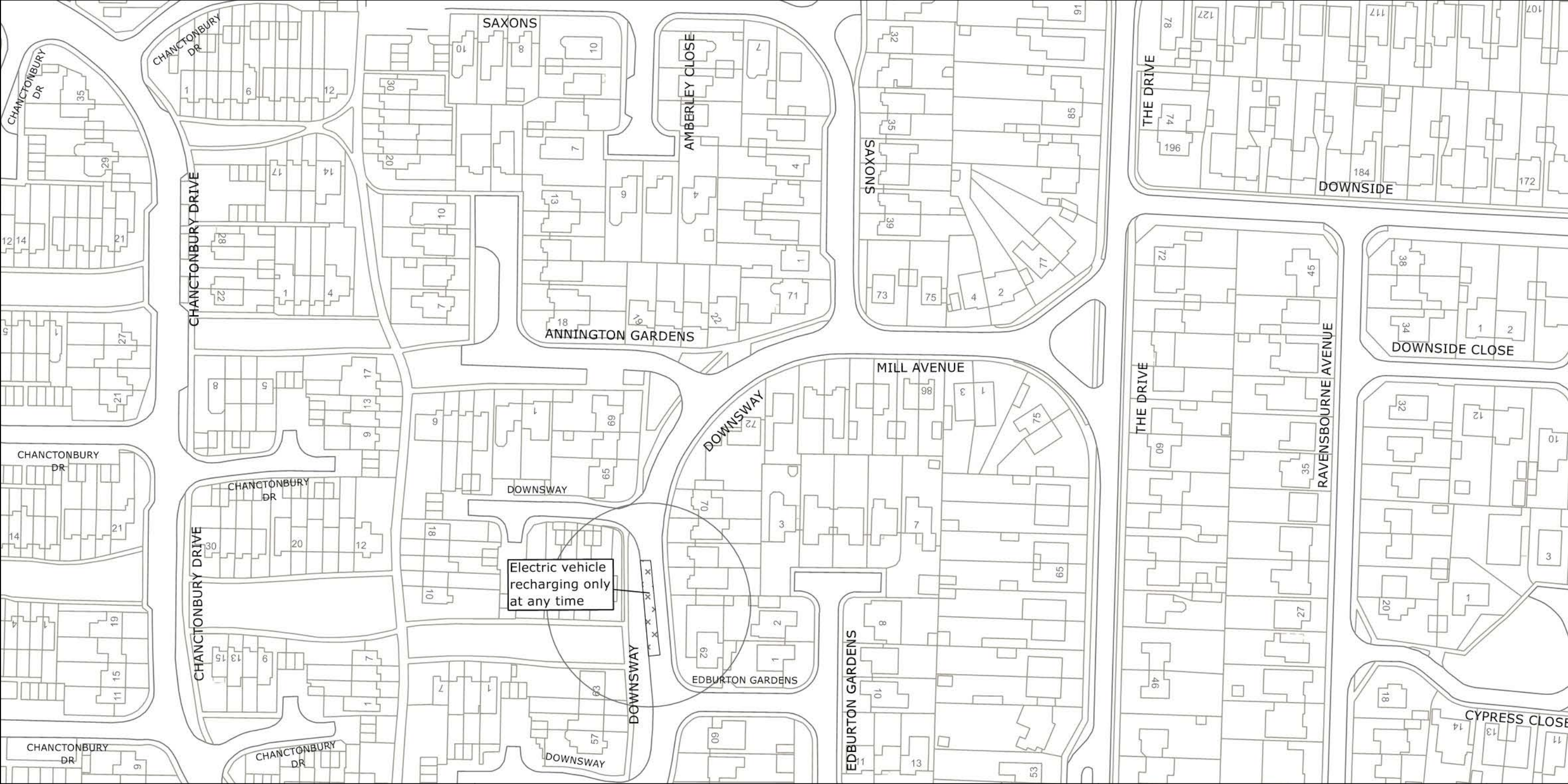

West Sussex County Council
 Highways & Transport
 The Grange
 Tower Street
 Chichester
 West Sussex
 PO19 1RH

ADUR DISTRICT: SHOREHAM/SOUTHWICK
 PROPOSED WAITING RESTRICTIONS (12.10.2022)

TILE REF NO:
TQ2106SEN
 SHEET ISSUE NO 1_ADR9018
 SHEET ACTIVE FROM - DD.MM.YYYY

N

 SCALE:
 1:1250
 at A3 size

Reproduced from or based upon 2022 Ordnance Survey mapping with permission of the Controller of HMSO (c) Crown Copyright reserved. Unauthorised reproduction infringes Crown copyright and may lead to prosecution or civil proceedings West Sussex County Council Licence No. 100018485

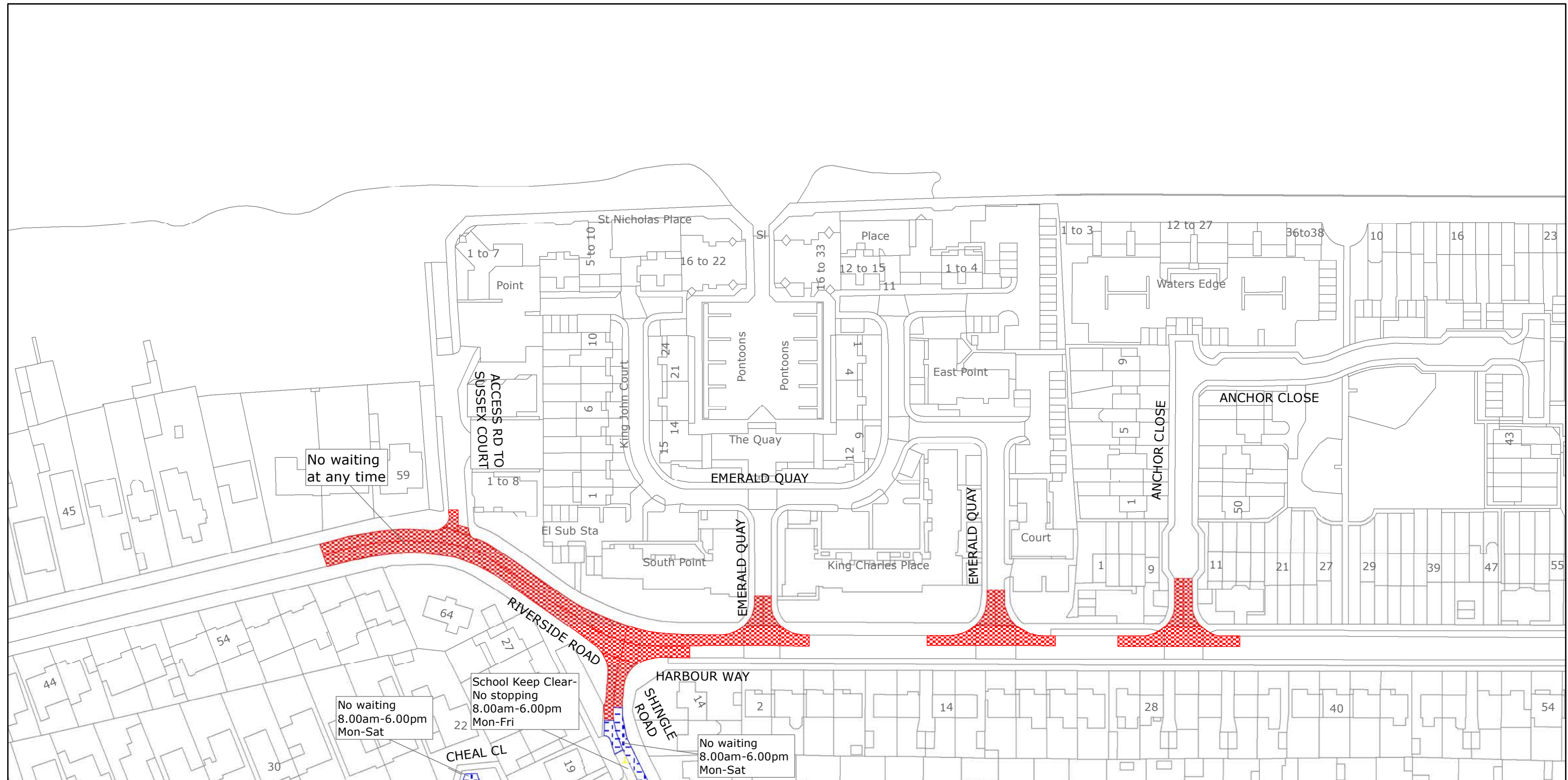

West Sussex County Council
 Highways & Transport
 The Grange
 Tower Street
 Chichester
 West Sussex
 PO19 1RH

ADUR DISTRICT: SHOREHAM/SOUTHWICK
 WAITING RESTRICTIONS

TILE REF NO:
 TQ2204NWN

SHEET ISSUE NO 2
 SHEET ACTIVE FROM - 12/03/2020



SCALE:
 1:1250
 at A3 size

Reproduced from or based upon 2020 Ordnance Survey mapping with permission of the Controller of HMSO (c) Crown Copyright reserved.
 Unauthorised reproduction infringes Crown copyright and may lead to prosecution or civil proceedings West Sussex County Council Licence No. 100018485

PAGE 2 OF 2: PROPOSED CHANGES TO RESTRICTIONS (CIRCLED)

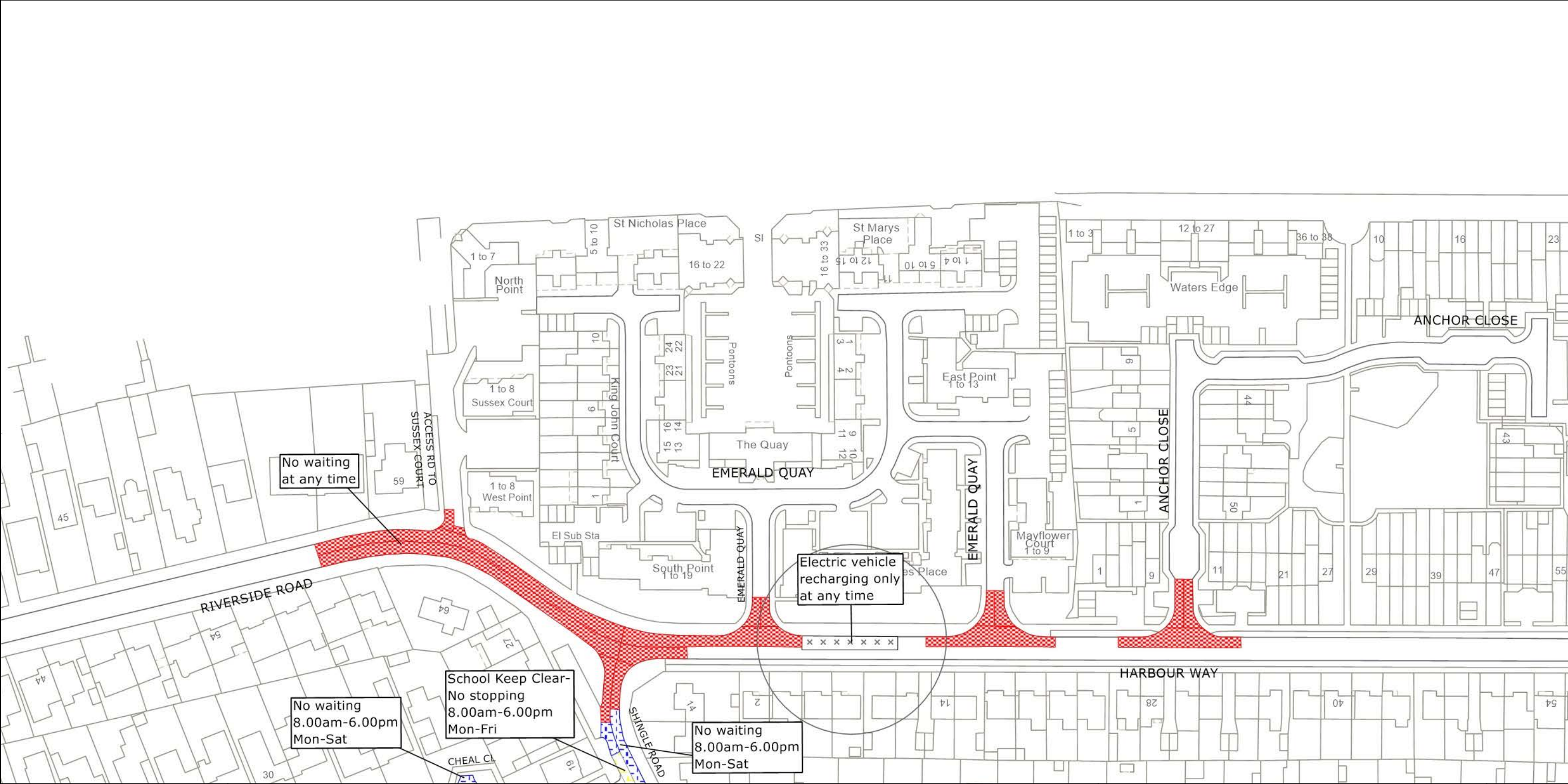

West Sussex County Council
 Highways & Transport
 The Grange
 Tower Street
 Chichester
 West Sussex
 PO19 1RH

ADUR DISTRICT: SHOREHAM/SOUTHWICK
 PROPOSED WAITING RESTRICTIONS (12.10.2022)

TILE REF NO:
 TQ2204NWN
 SHEET ISSUE NO 3_ADR9018
 SHEET ACTIVE FROM - DD.MM.YYYY

N

 SCALE:
 1:1250
 at A3 size

Reproduced from or based upon 2022 Ordnance Survey mapping with permission of the Controller of HMSO (c) Crown Copyright reserved. Unauthorised reproduction infringes Crown copyright and may lead to prosecution or civil proceedings West Sussex County Council Licence No. 100018485

PAGE 1 OF 2: EXISTING RESTRICTIONS ONLY

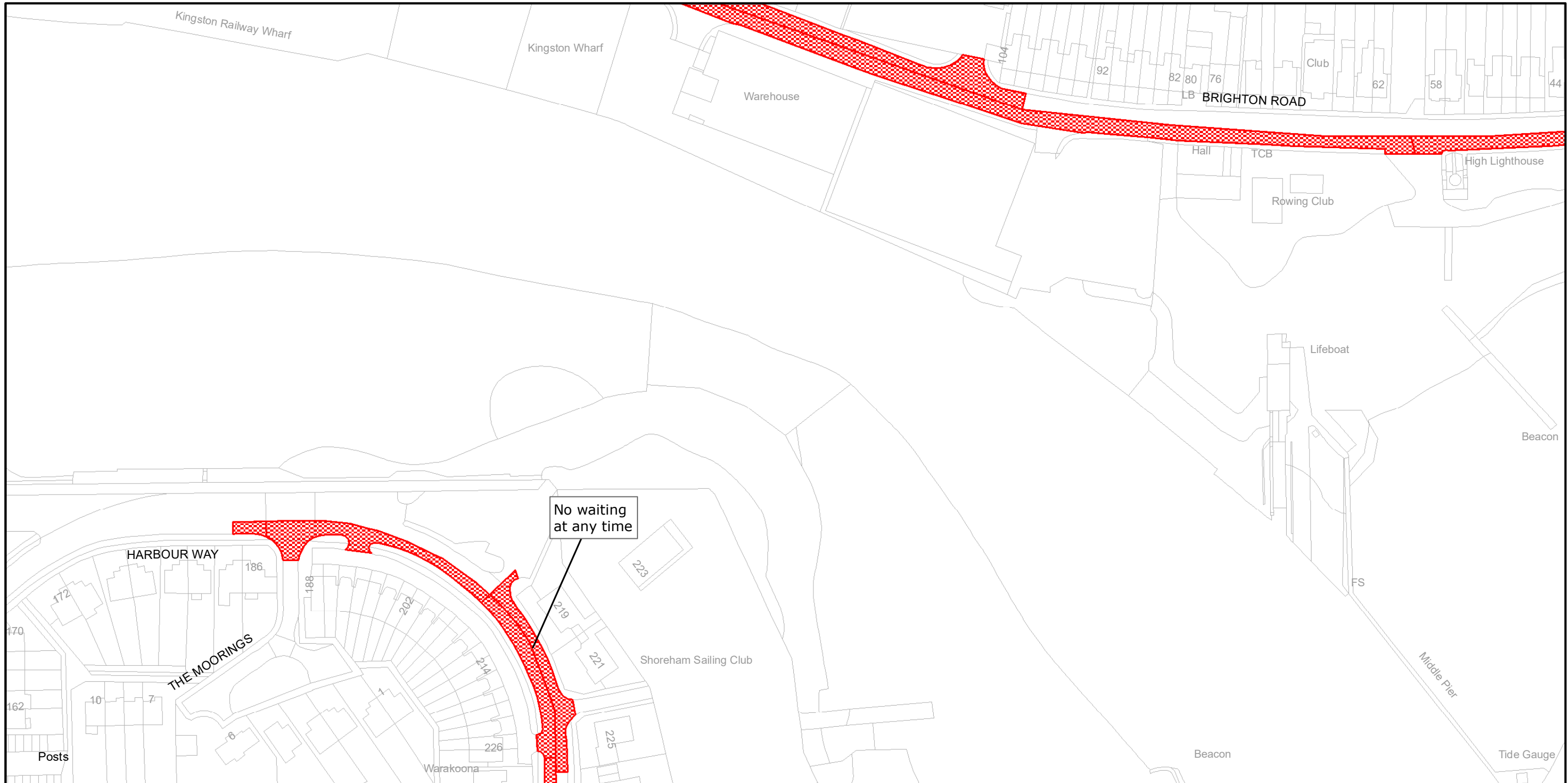

West Sussex County Council
Infrastructure
The Grange
Tower Street
Chichester
West Sussex
PO19 1RH

ADUR DISTRICT: SHOREHAM/SOUTHWICK
WAITING RESTRICTIONS

Reproduced from or based upon 2008 Ordnance Survey mapping with permission of the Controller of HMSO (c) Crown Copyright reserved.
Unauthorised reproduction infringes Crown copyright and may lead to prosecution or civil proceedings West Sussex County Council Licence No. 100023447

TILE REF NO:
TQ2304NWN

SHEET NO 1

SHEET ACTIVE FROM - 05/03/2009



SCALE:
1:1250
at A3 size

PAGE 2 OF 2: PROPOSED CHANGES TO RESTRICTIONS (CIRCLED)

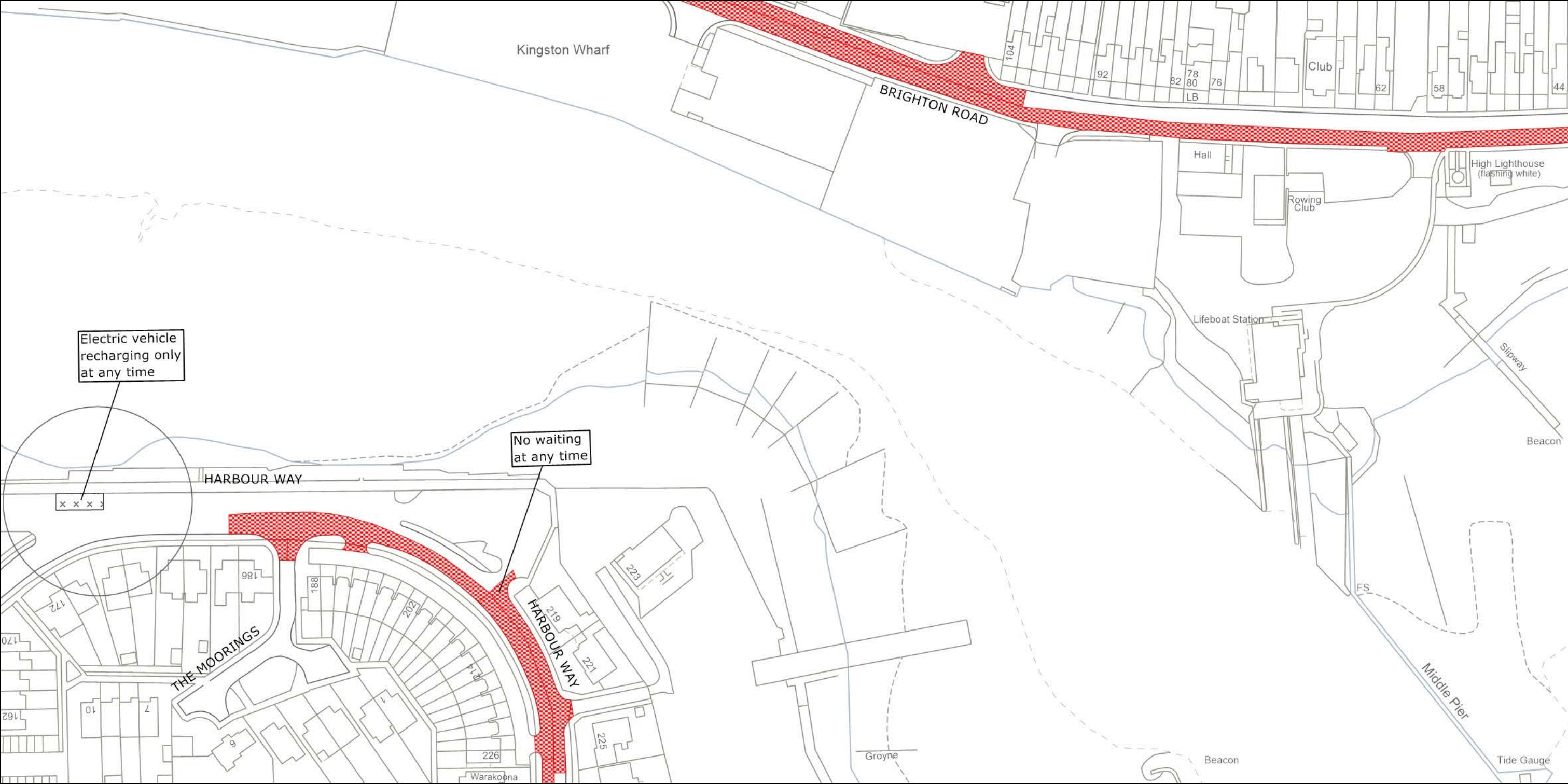

West Sussex County Council
 Highways & Transport
 The Grange
 Tower Street
 Chichester
 West Sussex
 PO19 1RH

ADUR DISTRICT: SHOREHAM/SOUTHWICK
 PROPOSED WAITING RESTRICTIONS (12.10.2022)

TILE REF NO:
 TQ2304NWN
 SHEET ISSUE NO 2_ADR9018
 SHEET ACTIVE FROM - DD.MM.YYYY

N

 SCALE:
 1:1250
 at A3 size

Reproduced from or based upon 2022 Ordnance Survey mapping with permission of the Controller of HMSO (c) Crown Copyright reserved. Unauthorised reproduction infringes Crown copyright and may lead to prosecution or civil proceedings West Sussex County Council Licence No. 100018485



West Sussex County Council
Highways & Transport
The Grange
Tower Street
Chichester
West Sussex
PO19 1RH

ADUR DISTRICT: SHOREHAM/SOUTHWICK
NO EXISTING WAITING RESTRICTIONS

Reproduced from or based upon 2022 Ordnance Survey mapping with permission of the Controller of HMSO (c) Crown Copyright reserved.
Unauthorised reproduction infringes Crown copyright and may lead to prosecution or civil proceedings West Sussex County Council Licence No. 100018485

TILE REF NO:
TQ2406NWS

SHEET ISSUE NO
SHEET ACTIVE FROM -

N
SCALE:
1:1250
at A3 size

PAGE 2 OF 2: PROPOSED CHANGES TO RESTRICTIONS (CIRCLED)



West Sussex County Council
Highways & Transport
The Grange
Tower Street
Chichester
West Sussex
PO19 1RH

ADUR DISTRICT: SHOREHAM/SOUTHWICK
PROPOSED WAITING RESTRICTIONS (25.10.2022)

TILE REF NO:
TQ2406NWS
SHEET ISSUE NO 1_ADR9018
SHEET ACTIVE FROM - DD.MM.YYYY

N
SCALE:
1:1250
at A3 size

Reproduced from or based upon 2022 Ordnance Survey mapping with permission of the Controller of HMSO (c) Crown Copyright reserved. Unauthorised reproduction infringes Crown copyright and may lead to prosecution or civil proceedings West Sussex County Council Licence No. 100018485

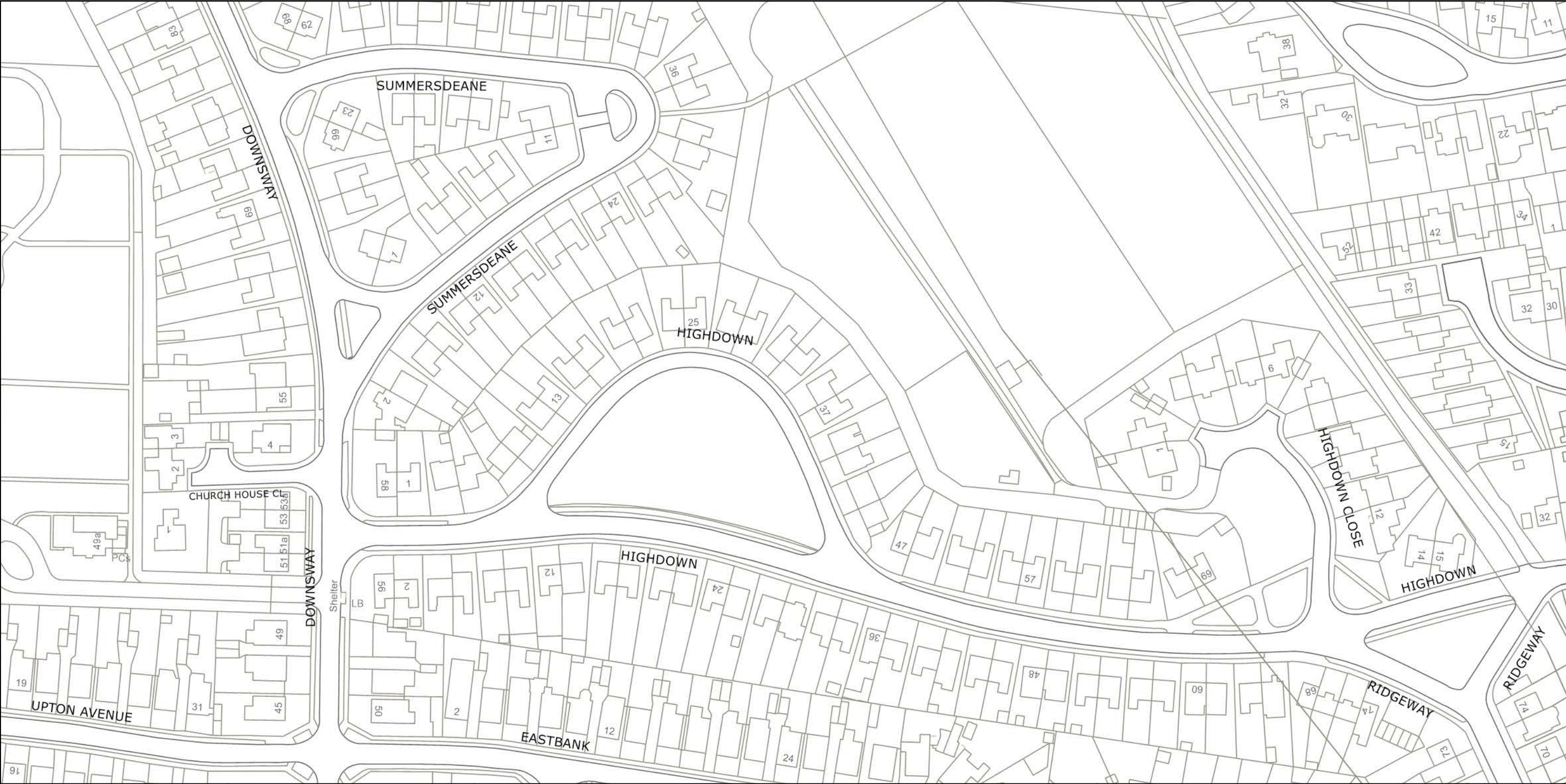

West Sussex County Council
Highways & Transport
The Grange
Tower Street
Chichester
West Sussex
PO19 1RH

ADUR DISTRICT: SHOREHAM/SOUTHWICK
NO EXISTING WAITING RESTRICTIONS

TILE REF NO:
TQ2406SEN
SHEET ISSUE NO
SHEET ACTIVE FROM -

N
SCALE:
1:1250
at A3 size

Reproduced from or based upon 2022 Ordnance Survey mapping with permission of the Controller of HMSO (c) Crown Copyright reserved. Unauthorised reproduction infringes Crown copyright and may lead to prosecution or civil proceedings West Sussex County Council Licence No. 100018485

PAGE 2 OF 2: PROPOSED CHANGES TO RESTRICTIONS (CIRCLED)

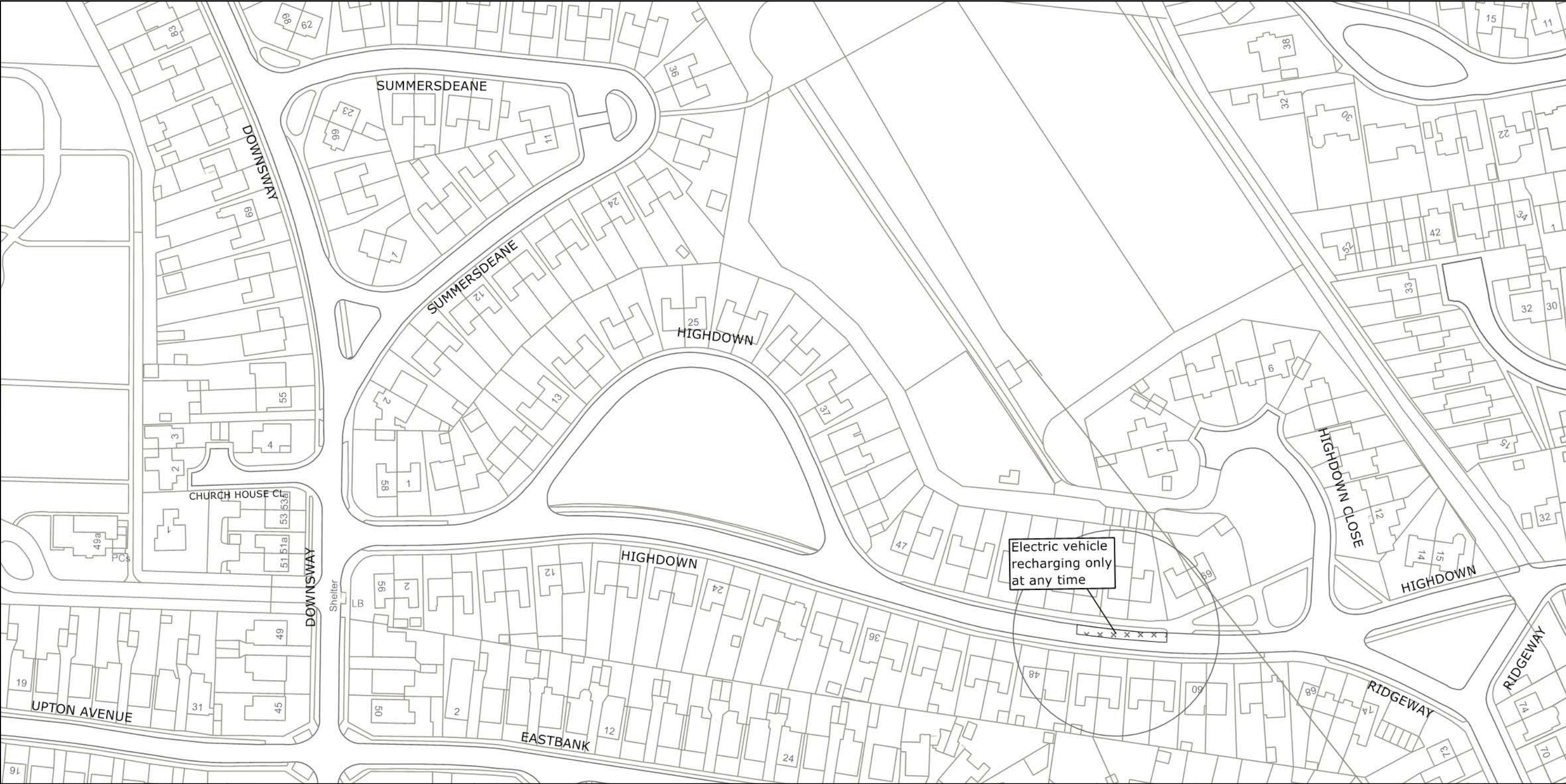

West Sussex County Council
 Highways & Transport
 The Grange
 Tower Street
 Chichester
 West Sussex
 PO19 1RH

ADUR DISTRICT: SHOREHAM/SOUTHWICK
 PROPOSED WAITING RESTRICTIONS (12.10.2022)

TILE REF NO:
TQ2406SEN
 SHEET ISSUE NO 1_ADR9018
 SHEET ACTIVE FROM - DD.MM.YYYY

N

 SCALE:
 1:1250
 at A3 size

Reproduced from or based upon 2022 Ordnance Survey mapping with permission of the Controller of HMSO (c) Crown Copyright reserved. Unauthorised reproduction infringes Crown copyright and may lead to prosecution or civil proceedings West Sussex County Council Licence No. 100018485