

TRAFFIC REGULATION ORDER (TRO) CONSULTATION
CHI8003RC – A272: Midhurst & Woolbeding with Redford
4/5/23 – 26/5/23

Contents

Notice	Page 2
Statement of Reasons	Page 3
Draft Order	Page 4
Plan "c_chi8003_speed_limits" - existing restrictions	Page 5
Plan "c_chi8003_speed_limits" - proposals	Page 6

WEST SUSSEX COUNTY COUNCIL
(MIDHURST & WOOLBEDING WITH REDFORD: A272)
(40MPH SPEED LIMIT) ORDER 2023

NOTICE is hereby given that West Sussex County Council proposes to introduce a permanent Order under the provisions of the Road Traffic Regulation Act 1984, the effect of which will be to introduce a 40mph speed limit on a length of the A272 between the 30mph at June Lane to a point 80 metres west of Woolbeding Lane.

Full details of the proposals in this Notice can be viewed on our website www.westsussex.gov.uk/tro. The website includes a response form for comments or objections.

Paper copies of documents will not be available to view in council offices or libraries. People without access to a computer who wish to view details of the scheme should telephone the West Sussex County Council Contact Centre on 01243 642105 to receive the documents by post.

Any objections or comments about the proposal must be received by 26 May 2023. These may be sent via the response form on the website, in writing to: TRO Team, West Sussex County Council, The Grange, Tower Street, Chichester, PO19 1RH; or by e-mail to: tro.consultation@westsussex.gov.uk. All correspondence should be addressed to the undersigned, quoting the reference TRO/CHI8003/RC. Only correspondence including a full name and address will be considered.

Dated this 4 May 2023

Director of Law & Assurance
County Hall
Chichester

WEST SUSSEX COUNTY COUNCIL
(MIDHURST & WOOLBEDING WITH REDFORD: A272)
(40MPH SPEED LIMIT) ORDER 2023

Statement Of Reasons For Proposing To Make The Order

The County Council in exercise of their powers under the Road Traffic Regulation Act 1984, propose to make a permanent Order the effect of which will be to introduce a 40mph speed limit on a length of the A272 between the 30mph at June Lane to a point 80 metres west of Woolbeding Lane.

A Community Highway Improvements Scheme has been proposed by the Area Cycling Forum and is being progressed on the A272. The Scheme aims to improve the existing shared facility for pedestrians and cyclists by widening 200 metres of shared cycle path and by the reconstruction of the footway opposite Woolbeding Lane.

This section of the A272 is currently de-restricted. To increase highway safety it is proposed to reduce the speed limit and create a 40mph buffer between the 30mph by virtue of street-lighting in Midhurst village, westwards to a point 80 metres west of Woolbeding Lane.

The primary aim of the initiative is to enhance road safety, and it is intended that this approach will not compromise the effectiveness of existing speed limits around the county.

This Order is proposed so as to reduce danger to persons or other traffic using the road or to minimise the likelihood of any such danger arising and for facilitating the safe passage of any class of traffic (including pedestrians).

Drawing CHI8003 : Proposed 40mph Speed Limit (13.4.2023) shows the lengths of road, which is the subject of the proposed order.

Director of Law & Assurance
County Hall
Chichester

WEST SUSSEX COUNTY COUNCIL
(MIDHURST & WOOLBEDING WITH REDFORD: A272)
(40MPH SPEED LIMIT) ORDER 202*

West Sussex County Council in exercise of their powers under Sections 82 and 84 (1) (a) of the Road Traffic Regulation Act 1984 ("the Act"), and Part IV of Schedule 9 of the Act and of all other enabling powers, and after consultation with the chief officer of police in accordance with Part III and Part IV of Schedule 9 to the Act hereby make the following Order: -

1. This Order shall come into operation on the X Day of x 202* and may be cited as "West Sussex County Council (Midhurst & Woolbeding with Redford: A272) (40mph Speed Limit) Order 202*"
2. No person shall cause or permit any vehicle to proceed at a speed exceeding 40 miles per hours on the length of road specified in the First Schedule to this Order.
3. Nothing in Paragraph 2 shall apply to a vehicle being used by naval, military or air force purposes while being driven by a person for the timebeing subject to the orders of a member of the armed forces of the Crown on an occasion when –
 - (a) the person driving the vehicle is a member of the special forces as defined by the Road Traffic Exemptions (Special Forces) (Variation and Amendment) Regulations 2011; and
 - (b) the vehicle is being driven-
 - (i) in response, or for practice in responding, to a national security emergency by a person who has been trained in driving vehicles at high speeds; or
 - (ii) for the purpose of training a person in driving vehicles at high speeds.

FIRST SCHEDULE
(40mph speed limit)

Length of road in Midhurst & Woolbeding with Redford

A272

From June Lane to a point 80 metres west of Woolbeding Lane.

For and on behalf of WEST SUSSEX COUNTY COUNCIL



Authorised Signatory:

NAME:

DATE MADE:

KEY

SPEED LIMITS

-  Existing 30mph Speed Limit
-  Existing 60mph Speed Limit

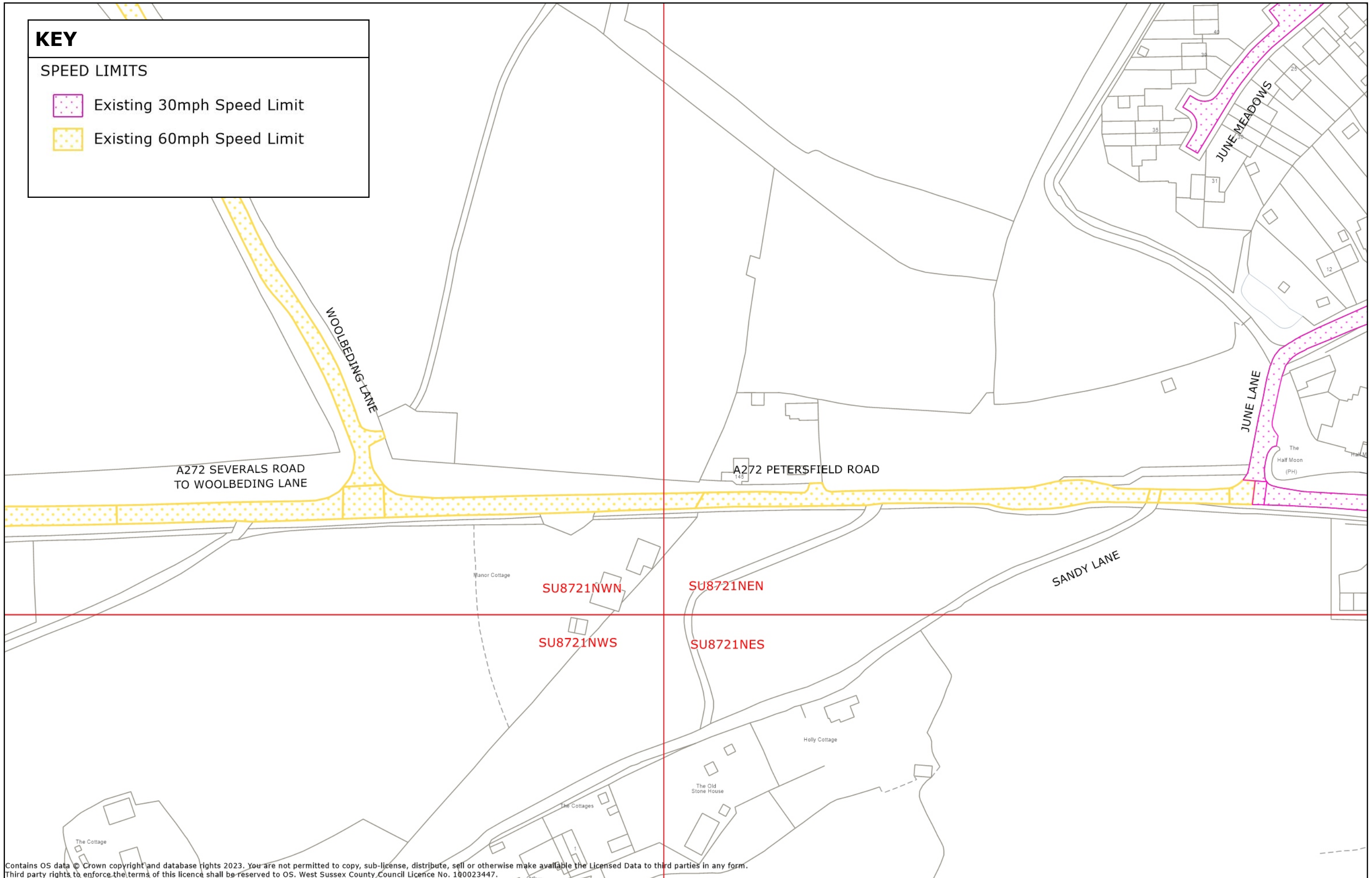



Contains OS data © Crown copyright and database rights 2023. You are not permitted to copy, sub-license, distribute, sell or otherwise make available the Licensed Data to third parties in any form. Third party rights to enforce the terms of this licence shall be reserved to OS. West Sussex County Council Licence No. 100023447.



KEY

SPEED LIMITS

-  Existing 30mph Speed Limit
-  Proposed 40mph Speed Limit
-  Existing 60mph Speed Limit

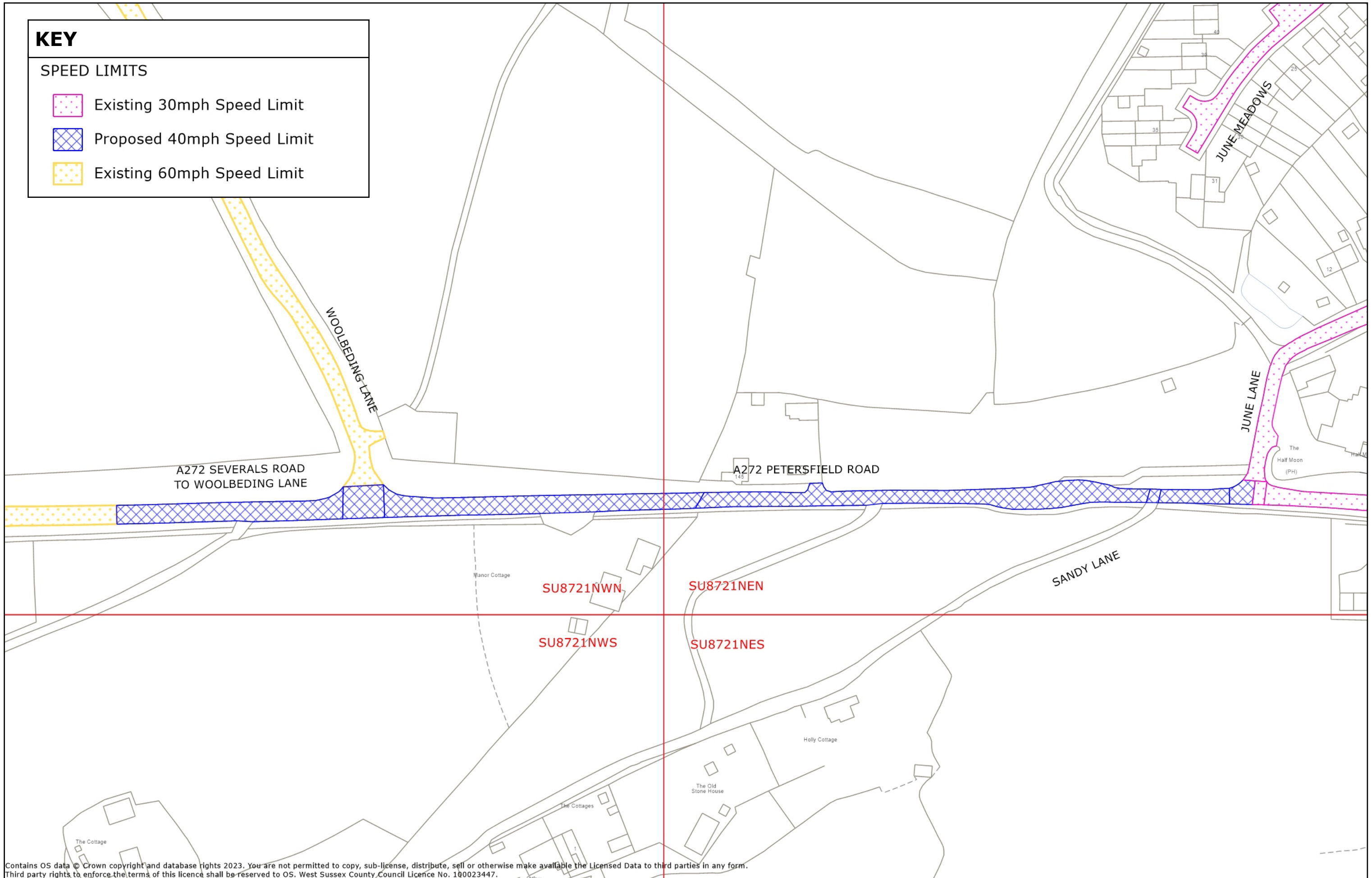

Contains OS data © Crown copyright and database rights 2023. You are not permitted to copy, sub-license, distribute, sell or otherwise make available the Licensed Data to third parties in any form. Third party rights to enforce the terms of this licence shall be reserved to OS. West Sussex County Council Licence No. 100023447.



CHICHESTER DISTRICT: WOOLBEDING WITH REDFORD AND MIDHURST: A272
PROPOSED 40MPH SPEED LIMIT (13.04.2023)

CHI8003

